

Link Cable / Wire

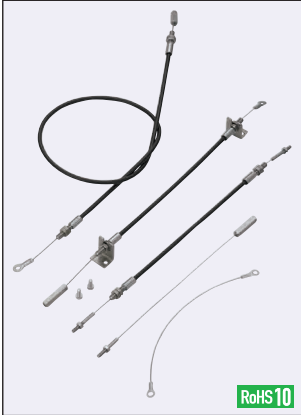

RoHS10

Operating Temperature Applicable: -25 to +80°C
 Material: Wire Outer End (Threaded): SUS304 Equivalent
 Included Nut 4 pcs. (JIS Class 3): SUS304 Equivalent
 Outer Tube (Sheath): PVC (Black)
 Internal Liner: PE
 Inner Core Rod: Copper for Screw

CWP Link Cable

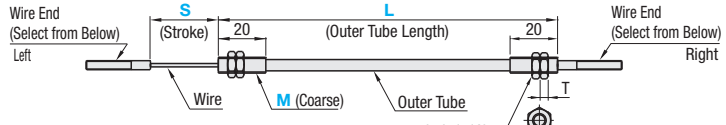

CWW Link Wire



Wire End Selection

M: Threaded Type

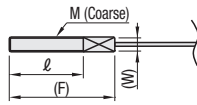

No.	M	Pitch (F)	l	W
03	3	0.5	20	2.5
04	4	0.7	25	3.5
05	5	0.8	30	4.5

Material: SUS303 Equivalent
 Included Nut, 1 pc. (JIS Class 3): SUS304 Equivalent

N: Tapped Type

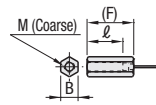

No.	M	Pitch (F)	l	B
03	3	0.5	20	5.5
04	4	0.7	25	7
05	5	0.8	30	8

Material: SUS303 Equivalent

P: Ring

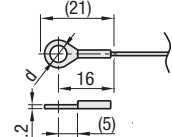

No.	d(I.D.)
03	3.2
04	4.2
05	5.2

Material: SUS304 Equivalent

Link Cable

Part Number	Wire End No. Selection		S (Stroke) 10 mm Increment	L (Outer Length) 10 mm Increment	Wire Dia. (Ø)	Outer Diameter (Ø)	Outer End M (Coarse)	Included Nut B T	Max. Operating Force N (kgf)	Minimum Bending Radius R
	Left	Right								
CWP	0.7	M 03 N 04 P 05	40-500	200-3000	0.75	5	M5	8 3.2	294[30]	75
	1.2	M 03 N 04 P 05	40-500	200-3000	1.2	5	M6	10 3.6	706[72]	
	2.0	M 03 N 04 P 05	40-500	300-3000	2.0	6	M8	13 5	1878[192]	

Durability & Replacement Cycle <Reference Value>

Wire Dia. d	Safety Factor	Pull Count	Max. 0.1 Million Times	60% 0.3 Million Times	30% 0.5 Million Times	10% 1 Million Times
0.7	1.2	294 [30]	176 [18]	88 [9]	29 [3]	
			706 [72]	424 [43]	212 [22]	71 [7]
			1878 [192]	1127 [115]	563 [58]	188 [19]

*When wiring the pulley, durability degrades depending on the pulley specifications.

Link Wire

Part Number	Wire End No. Selection		L 10mm Increment	Wire Dia. (Ø)	Max. Operating Force N (kgf)	Minimum Bending Radius R
	Left	Right				
CWW	0.7	M 03 N 04 P 05	40-5000	0.75	294[30]	20
	1.2	M 03 N 04 P 05	40-5000	1.2	706[72]	32
	2.0	M 03 N 04 P 05	40-5000	2.0	1878[192]	52

Wire Specifications & Elongation <Reference Value>

Wire Dia. d	Wire Structure (Twisted)	When used at the maximum operating force			
		Applied Load	Total Elongation	Elastic Elongation	Permanent Elongation
0.7	Multi-twisted (7x19)	294N	1.17%	1.13%	0.04%
		706N	1.13%	1.09%	0.03%
2.0	Multi-twisted (7x19)	1878N	1.13%	1.08%	0.05%



Ordering Example

Part Number - Wire End - Stroke - Outer Length Wire Length
 Left - Right
 CWP0.7 - M03 - N03 - S40 - 1000
 CWW1.2 - P04 - N04 - 1200



Alterations



Ordering Example Part Number - Wire End - Stroke - Outer Length - (BL/WBL)
 Left - Right
 CWP0.7 - M03 - N04 - S40 - 1000 - BL

Link Cable

Part Number	Wire End	Unit Price				
		L-500	-1000	-2000	-3000	
CWP	0.7	PP				
		MP NP MM MN NN				
	1.2	PP				
		MP NP MM MN NN				
	2.0	PP				
		MP NP MM MN NN				

Link Wire

Part Number	Wire End	Unit Price			
		L-500	-1000	-3000	-5000
CWW	0.7	PP			
		MP NP MM MN NN			
	1.2	PP			
		MP NP MM MN NN			
	2.0	PP			
		MP NP MM MN NN			

Alteration	Bracket Included										
Spec.	<table border="1"> <thead> <tr> <th>Type</th> <th>No.</th> <th>D</th> </tr> </thead> <tbody> <tr> <td rowspan="3">CWP</td> <td>0.7</td> <td>5.3</td> </tr> <tr> <td>1.2</td> <td>6.5</td> </tr> <tr> <td>2.0</td> <td>8.5</td> </tr> </tbody> </table> <p>Shipped with the mounting brackets and screws included. Bolt: SCB4-10, 2 pcs. Applicable to CWP Material: SUS304</p>	Type	No.	D	CWP	0.7	5.3	1.2	6.5	2.0	8.5
Type	No.	D									
CWP	0.7	5.3									
	1.2	6.5									
	2.0	8.5									
Code	BL (1 pc.) WBL (2 pcs.)										