

# 2-Port Solenoid Valves / Multilex Valves

## Direct Operation / Pilot-Operated

### Solenoid Valves - 2-Port Solenoid Valves Direct Operation



RoHS10

### MDSN

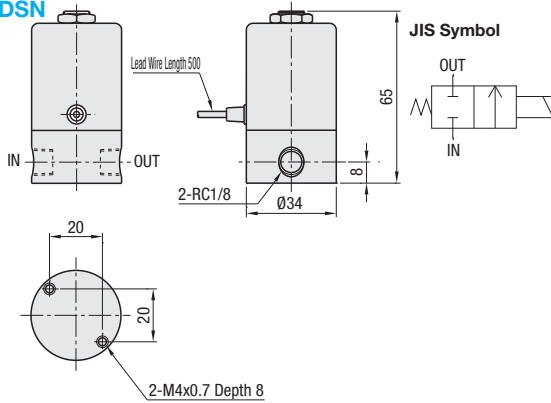

### Basic Specifications of Solenoid Valves

<b>Direction</b>	2 Ports
<b>Number of Positions</b>	2
<b>Applicable Fluid</b>	Air, Water, Kerosene, Oil (50mm <sup>2</sup> /S)
<b>Operating Pressure Range</b>	0~1.5MPa
<b>Operating Temp. Range</b>	5 ~ 40°C
<b>Allowable Voltage Range</b>	±10%
<b>Valve Type</b>	Direct Poppet Design Normally Closed (Exciting Open Type)

Part Number	Rated Voltage (V)	Rated Voltage (mA) 50/60Hz	Pipe Connection Bore Dia.	Orifice Dia. (mm)	Effective Sectional Area(mm <sup>2</sup> )	Cv	Mass (kg)	Unit Price
MDSN	B (100VAC)	88/73	Rc1/8	Ø1.6	1.54	0.09	0.31	
	C (200VAC)	43/37						

### Component List

Part No.	Name	Material	Surface Treatment
①	Main Body	C3604B	-
②	Fixed Core	Magnetic Stainless Steel	-
③	Coil Case	SPC	Black Resin Paint
④	Nut	S15C	Nickel Plating

### Components

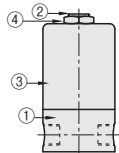

Ordering Example: Part Number MDSN - Rated Voltage (V) B

### Features

- Compact 2-port solenoid valves for air, water and oil.
- Direct operation enables use under low pressure as well.
- Easy mount bracket are included.

### Precautions for Use

- Operating Environment
  - Use the solenoid valves at temperatures between 5 and 40 °C. Avoid any use and storage in a corrosive atmosphere.
  - Keep the solenoid valves away from strong impacts and vibrations. They may be closed from being open, and vice versa.
- Fluid Quality
  - When compressed air is used as a fluid, removes drainage and dust through an air filter.
  - When the fluid is water, remove grit and rust inside a pipe through a filter. Do not run poor quality water.
- Installation
  - Install the solenoid valves horizontally with the coil part upward.
  - The body might be damaged if the M4 screws are excessively tightened up.
- Plumbing
  - Before plumbing, cleanse and flush thoroughly the valves to remove cutting chips, dust and cutting oil.
  - Note that plumbing will not cause a strong turbulence on the IN side.
- Maintenance
  - Do not disassemble the solenoid valves.

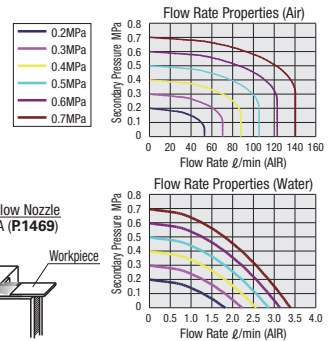
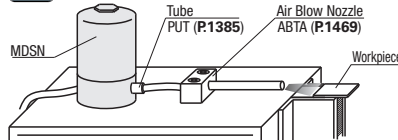

### Solenoid Valves - 2-Port Solenoid Valves Pilot-Operated

### MDPN

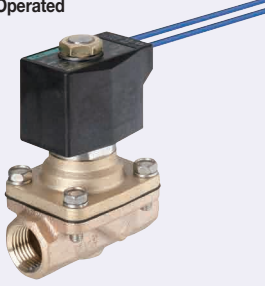

G (Rc)	A	B	D	E	F	W
Rc1/2	71	27	14.5	75.5	102	50
Rc3/4	80	32	17.5	79	108.5	60

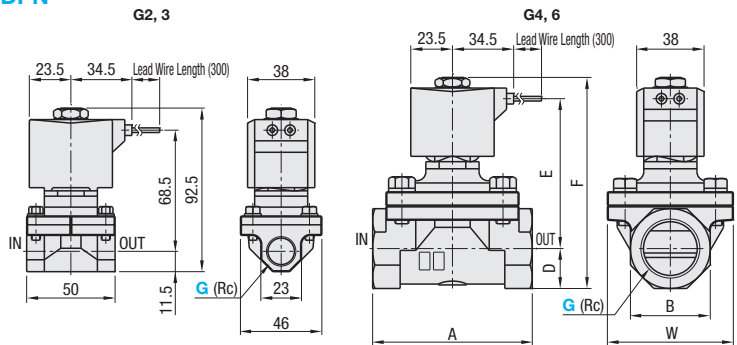

Part Number Type	No.	G (Rc)	Rated Voltage (V)	Orifice Dia. (mm)	Min. Operating Pressure Differential (Mpa)	Max. Operating Pressure Differential (Mpa)	Flow Rate Characteristics				Apparent Power				Mass (kg)	Unit Price			
							Air	Water, Kerosene	Oil (50mm <sup>2</sup> /S)	C*	b	Cv	S (mm <sup>2</sup> )	AC 50/60Hz		Holding 50Hz	Starting 60Hz	50Hz	60Hz
MDPN	1	2 (Rc1/4)	B (100VAC)	12	0	1	0.7	9.2	0.36	2.0	-	10/8	24	19	61	54	0.65		
		3 (Rc3/8)		12				11	0.46	2.4	-		24	19	61	54			0.65
		4 (Rc1/2)		16				20	0.31	4.5	-		25	21	84	75			0.90
		6 (Rc3/4)		23				-	-	8.6	162		25	21	84	75			1.00

○ Normally closed.

○ \*C=[dm<sup>3</sup>/(s·bar)]

Ordering Example: Part Number MDPN1 - G(Rc) 4 - Rated Voltage (V) B