

Fluid Couplers

No Valve Type

For combination of plugs and sockets, refer to P.1414.

No Valve Type Tapped Plugs



QNPFC (Brass)
QNPFS (SUS304)

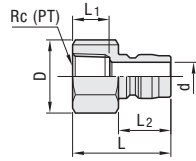

Part Number Type	No.	Rc (PT)	D	d	L	L1	L2	Unit Price	
								QNPFC	QNPFS
QNPFC QNPFS	1	1/8	14	4.5	28.5	11	15.5		
	2	1/4	17	6.5	35	14	18		
	3	3/8	21	10	40	15	21.5		
	4	1/2	29	13	45	17	24		
	6	3/4	35	17	51	19	28		
	8	1	41	25	60	21	36.5		

No Valve Type Tapped Sockets



QNSFC (Brass)
QNSFS (SUS304)

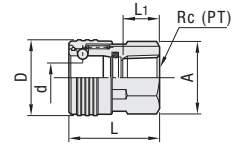

Part Number Type	No.	Rc (PT)	D	d	L	L1	A	Unit Price	
								QNSFC	QNSFS
QNSFC QNSFS	1	1/8	18	4.5	27	9.5	14		
	2	1/4	24	8	32	13	19		
	3	3/8	28	12	35	13	23		
	4	1/2	35	16	42	17	29		
	6	3/4	45	20	48.1	19	38		
	8	1	57	26	59.3	21	50		

No Valve Type Threaded Plugs



QNPMC (Brass)
QNPMS (SUS304)

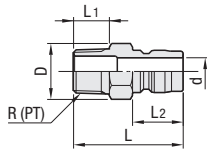

Part Number Type	No.	R (PT)	D	d	L	L1	L2	Unit Price	
								QNPMC	QNPMS
QNPMC QNPMS	1	1/8	12	4.5	32	10	15.5		
	2	1/4	14	6.5	38	13	18		
	3	3/8	19	10	43	13	21.5		
	4	1/2	23	13	52	17	24		
	6	3/4	32	17	59	19	28		
	8	1	41	25	73	22	36.5		

No Valve Type Threaded Sockets



QNSMC (Brass)
QNSMS (SUS304)

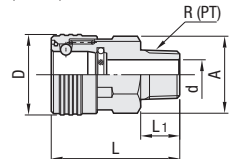

Part Number Type	No.	R (PT)	D	d	L	L1	A	Unit Price	
								QNSMC	QNSMS
QNSMC QNSMS	1	1/8	18	4.5	30	9	14		
	2	1/4	24	7	42	13	19		
	3	3/8	28	10	46	13	23		
	4	1/2	35	13	56	17	29		
	6	3/4	45	18	65.1	19	38		
	8	1	57	24	76.3	22	50		

No Valve Type Hose Connection Plugs



QNPHC (Brass)
QNPHS (SUS304)

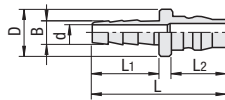

Part Number Type	No.	B	D	d	L	L1	L2	Unit Price	
								QNPHC	QNPHS
QNPHC QNPHS	6	6.5	11	3	41	20	15.5		
	9	11	18	7	60	30	21.5		
	12	15	22	10	66	35	24		
	19	21	28	15	79	43	28		
	25	27	40	19	98	50	36.5		

Select the Type No. identical to that of hose I.D.



No Valve Type Hose Connection Sockets



QNSHC (Brass)
QNSHS (SUS304)

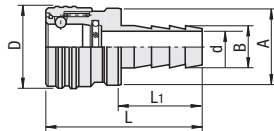

Part Number Type	No.	B	D	d	A	L	L1	Unit Price	
								QNSHC	QNSHS
QNSHC QNSHS	6	6.5	18	3	16	40	20		
	9	11	28	7	25	60	30		
	12	15	35	10	32	69	35		
	19	21	45	15	40	84.1	43		
	25	27	57	19	52	95.3	50		

Select the Type No. identical to that of hose I.D.

Specifications

Body Material	Brass	SUS304
Applicable Fluid	Water, Oil, Air	Water, Oil, Air
Seal Material	Nitrile Rubber	Fluoro Rubber
Operating Temperature Range*	-20~80°C	-15~180°C
Max. Operating Pressure	4.9MPa	7.4MPa
	2.9MPa for No. 6 or 8	4.4MPa for No. 6 or 8
Pressure Resistant	7.4MPa	9.8MPa
	4.4MPa for No. 6 or 8	6.4MPa for No. 6 or 8

* No Freezing

Flow Direction

Fluids are allowed to flow from either the socket side or the plug side.

Plug, Socket Compatibility

Tapped No. Threaded No. Hose Connection No.

1	1	6
2	2	-
3	3	9
4	4	12
6	6	19
8	8	25

- (Ex) ○ QNPFC2 / QNSMC2
○ QNPMC3 - QNSHC9
× QNPFC1 / QNSFC8 (Because the sizes are different)
× QBPFC4 / QNSMC4 (Because the types are different)
× QBPHT2 / QBSHT4 (Because the sizes are different)
- They cannot be combined with couplers listed in other pages.

No Valve Type Pressure Loss - Flow Rate Properties

