

Regulators for Pressure Tanks / Low Level Float Switches / Through Fittings

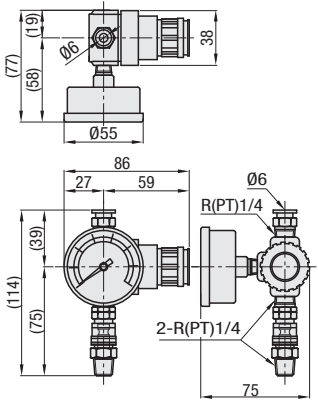

TNKRG (Low Pressure Use)
TNKRGH (High Pressure Use)



M Material: Main Body: Zinc Alloy
Adjuster Knob: Polyacetal
Gasket: NBR

Part Number	Specifications	Adjustable Range	Unit Price Qty. 1 ~ 3
TNKRG	Low Pressure Use	0~0.2MPa	
TNKRGH	High Pressure Use	0~0.7MPa	

For orders larger than indicated quantity, please check with WOS.

Ordering Example
Part Number
TNKRG
TNKRGH

■ Cautions on Installation and Operation

- Install in a place which is not subject to vibration.
- Use within surrounding temperature range of 5 ~ 60°C.
- Do not squeeze the pipe to the connecting port in the halfway.

■ Features

Controls pressure within pressure tank. By securing in the "lock" position after setting the pressure, set value is fixed and does not change during operation.



TNKFS

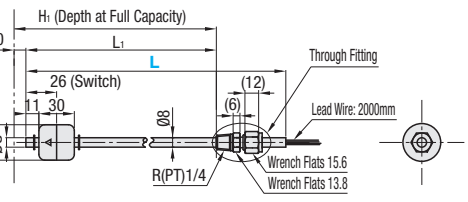

L_i can be adjusted by changing the position of the through-fitting.
■ Features: Switch to operate as alarm or signal of level of liquids such as water and oil.

■ Float Switch (Optional) Spec List

Part Number	Unit Price
Type	Qty. 1 ~ 3
L	
220	
300	
325	

Through fitting is included.

■ Specifications

Usage	For Liquids
Operating Range (Gravity)	0.7 or More
Pressure Resistance	0.75MPa
Heat Resistant Temperature	100°C
Lead Wire	FEP Coating 0.3sq
Material	
Stem	SUS304
Float	SUS304
Stopper	SUS304
Filler	Epoxy Type
Switch	ORD229
Maximum Operating Voltage	AC240V, DC200V
Maximum Operating Current	AC0.5A, DC0.5A
Maximum Contact Capacity	AC50VA, DC50W
Contact Resistance	500mΩ or Less
Precision	±3mm



■ Installation Manual

1. Apply adhesive tape to "Through Fitting" (R1/4 portion) and screw the fitting into the tank lid.
2. Thread lead wire through the "Through Fitting" from inside of the lid, and insert the stem.
3. Insert the ferrule and nut of "Through Fitting" into the stem as shown on the left.
* Do not tighten the nut for fitting at this stage.
4. Confirm the distance from the tip of the stem and switch portion to the bottom of the tank, define the location where the stem will be fixed, and hand-tighten the nut.
5. Turn the nut until hand-tight and then secure it with a wrench by rotating at 1 1/4 turn.

■ Cautions on Installation

Float may not function properly if mounted with excessive tilt.

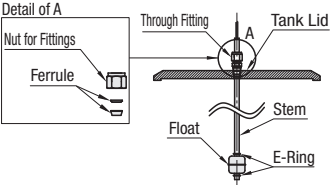
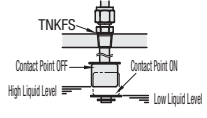

TNKT

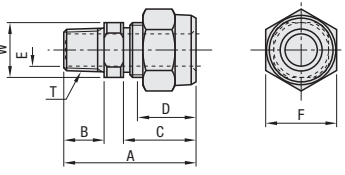

M Material: Main Body: SUS304
Ferrule: Teflon®

Part Number	Type	Applicable Tube O.D. (mm)	Nominal	T R(PT)	A	B	C	D	E	F	W	Unit Price	Volume
												Qty. 1 ~ 4	Qty. 5 ~ 10
TNKT	6	1	1/8	37	11	14	14	6	14	16			
				38	13								
	8	2	1/4	39	13	18	15	8	16	16			
				43	14	20	16	10	19	20			
10	3	3/8	44	14	23	18	12	23	25				
			44	14	23	18	12	23	25				

■ Features: Ferrule made of Teflon enables repeatable positioning.

Ordering Example
Part Number - Nominal
TNKFS300 - **2**
TNKT6 - **2**

ex Example

