

Offset Pull Handles

Round Bar Pull Handles

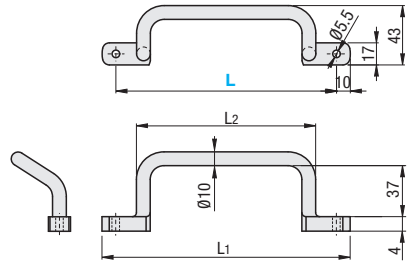

Type	Material	Surface Treatment
UHFSN	SS400	Chrome Plating
UHFSNB	SS400	Black Oxide
UHFSS	SUS304 Equivalent	Buffing



RoHS10

Part Number Type	L	L1	L2	Unit Price		
				UHFSN	UHFSNB	UHFSS
UHFSN (Steel) UHFSNB (Steel) UHFSS (Stainless Steel)	110	130	80			
	120	140	90			
	125	145	95			
	160	180	130			
	200	220	170			
	250	270	220			



Example

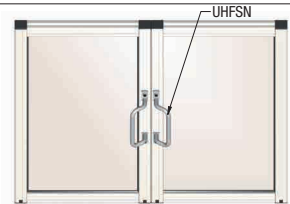

With Mounting Tabs



The pedestals are rotatable in any desired position.

RoHS10

Type	Material	Surface Treatment	Accessory			
			Pedestal G	Pedestal S	Thread	
UHFNCG	SUM22L	Chrome Plating	Zinc Die Cast	Electrostatic Paint (Silver)	SUS304	SHFBSS-12 SUS304 Equivalent 2 screws are included.
UHFNCS	SUS304	Buffing				
UHFNCA	Aluminum Alloy	Clear Anodize				

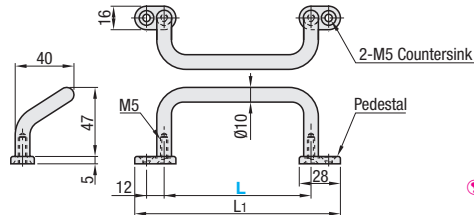

Handles are shipped with the pedestals uninstalled.

Part Number Type	L	Pedestal Selection	L1	Allowable Load (N)	Reference Mass (g)	Unit Price		
						UHFNCG	UHFNCS	UHFNCA
UHFNCG (Steel) UHFNCS (Stainless Steel) UHFNCA (Aluminum)	48	G (Zinc Die Cast) S (SUS304)	86	2000	90			
	66		104		100			
	88		126		114			
	100		138		122			
	110		148		127			
	120		158		134			
	125		163		136			
	160		198		158			

With Mounting Tabs



RoHS10

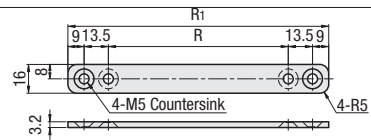
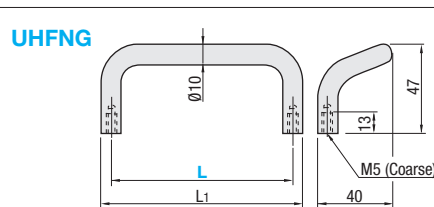

Part Name	Material	Surface Treatment	Accessory
Handles	A6063	Clear Anodize	SHFBSS-12 SUS304 Equivalent
Plate	A6063	Clear Anodize	2 screws are included.

Part Number Type	L	L1	R	R1	Reference Mass (g)	Unit Price
UHFNCG	100	110	100	145	50	
	120	130	120	165	52.5	
	125	135	125	170	54	



Example



The default L dimension is 100 unless specified.



Ordering Example

Part Number - Pedestal Selection
 UHFSN160
 UHFNCG100 - G
 UHFNCG120