

■ Solid Disk Handwheel

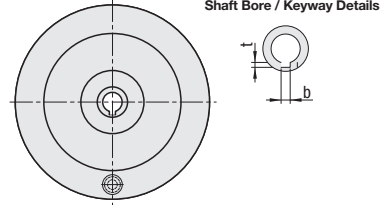

Type	Handwheel	Bushing		Handle Mounting Hole	Handle	Handle Thread	
	Material	Material	Surface Treatment	Material	Material	Material	Surface Treatment
C-PHSN	Phenol Resin	S45C	Zinc Plating	Brass	Phenol Resin	Carbon Steel for Mechanical Structure	Zinc Plating

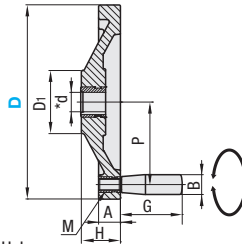

Ⓜ The *d part is H7 Hole.

Part Number Type	D	H	A	D ₁	d	M	P	B	G	Shaft Bore Details		Mass (g)	Unit Price
										b	t		
C-PHSN	63	20.5	13	28	8	6	24	15	32	3	1.4	70	
	80	21	13	30	10	6	32.5	15	32	3	1.4	110	
	100	26	15	40	12	6	40	20	50	4	1.8	200	
	125	30	18	46	12	8	52	22	60	4	1.8	390	
	160	38	21	53	16	10	68	26	80	5	2.3	570	
	200	40	22	64	18	10	88	26	80	6	2.8	990	
250	50.5	27	70	22	12	112	28	100	6	2.8	1,380		



Ordering Example

Part Number
C-PHSN100

■ Solid Disk Handwheel - Retractable Handle



Type	Handwheel	Bushing		Handle	Handle Mounting Hole	Handle Thread		Accessory: Flat Head Cap Screw	
	Material	Material	Surface Treatment	Material	Material	Material	Surface Treatment	Material	Surface Treatment
C-PHSFM	Phenol Resin	S45C	Black Oxide	Phenol Resin	Brass	S45C	Zinc Plating	Plain Carbon Steel	Zinc Plating

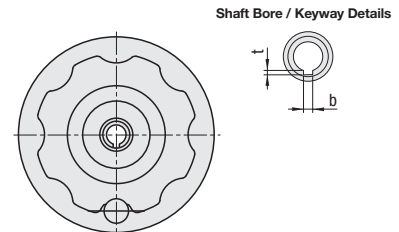
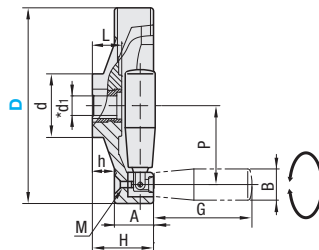

Ⓜ The *d part is H7 Hole.

■ Features: The handle can be folded for retraction.

Part Number Type	D	H	A	d	d ₁	L	h	P	B	G	M	Shaft Bore Details		Mass (g)	Unit Price
												b	t		
C-PHSFM	100	44	25	40	12	22	15	40	22	50	4	4	1.8	300	
	125	44	30	45	12	22	14	52	25	63	6	4	1.8	500	
	160	54	32	52	16	24	22	68	26	80	6	5	2.3	740	
	200	56	34	60	18	29	22	88	28	100	6	6	2.8	990	



Ordering Example

Part Number
C-PHSFM100