

# Adjusting Bolts

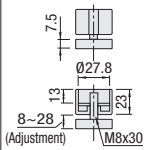

Part Number	Material	Surface Treatment
JBS202	SPCC	Trivalent Chromate
JBS401	Polypropylene	-
JBS404	SPCC	Trivalent Chromate
JBS405		
JBS406	SPCC	-
JBS407	Plastic Styrene-butadiene Rubber	-
JBS408	AAS Resin	-

**Adjuster**  
**JBS401**



Stroke: 20mm

**Adjusting Bolt A set**  
**JBS404**

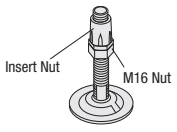
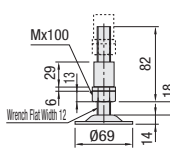

**Adjusting Bolt B set**  
**JBS405**

Unavailable for aluminum pipe frames

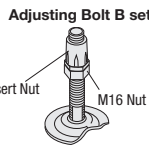
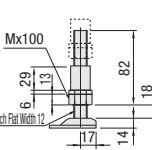

**Insert Nut**  
**JBS406**

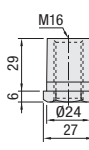

**Pipe Stand S**  
**JBS202**

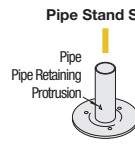
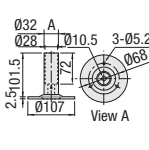

**Inner Stand**  
**JBS407**

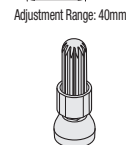
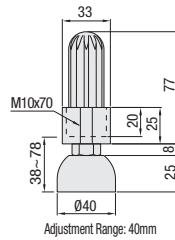

**Inner Stand**  
**JBS408**

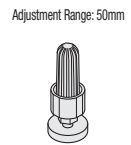
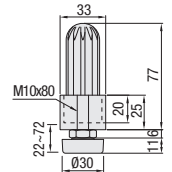

Part Number	Color	Mass (g)	Unit Price
JBS202	-	302	
JBS401	W, S	35	
JBS404	-	330	
JBS405		305	
JBS406		75	
JBS407		126	
JBS408	W (White)	92	



Ordering Example

Part Number - Color  
JBS202  
JBS401 - W

## Insert Nut - Stainless Steel



RoHS 10

### PFINS

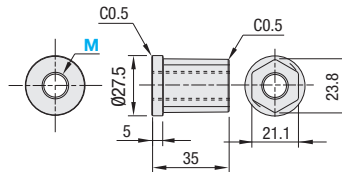

Tapered part from tip to head (1.2°) allows insertion into the I.D. of pipe frames.

Material: Stainless Steel

Part Number Type	Mass (g)		Unit Price
	M		
PFINS	8	89	
	10	85	
	12	82	



Ordering Example

Part Number  
PFINS10

Can be used for Standard Leveling Mounts (P.1107).