

Magnetic Catches with Sensors for Aluminum Extrusions

Magnetic Catches with Sensors for Aluminum Extrusions

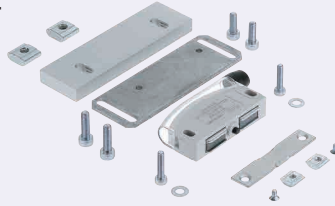

RoHS 10

Parts	Material	Surface Treatment
Magnetic Catch	Housing	Polybutylene Terephthalate (PBT)
	Terminal Cover	Polycarbonate
	Attraction Board	SPCC Nickel Plating

K Magnet

ON for Closing Position Contact Capacity
AC125V/3A
AC250V/3A
DC30V/1.5A

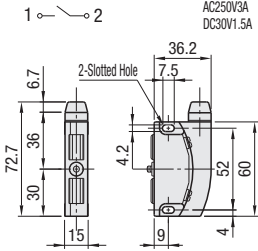

Catch Plate

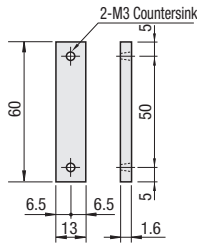

HMER-ML

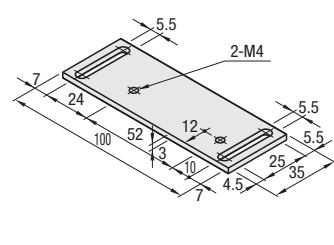

ML5-5 Plate

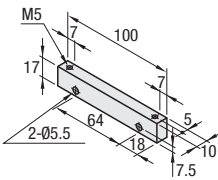

ML6-6 Plate

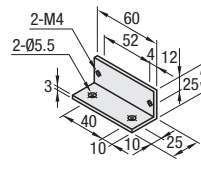

ML68-5, 8 Plate

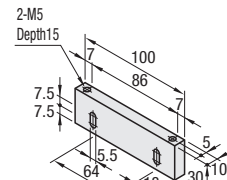

ML8-6 Plate

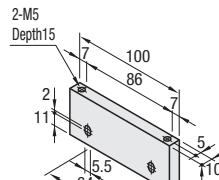

MLG Plate

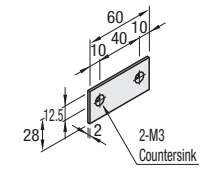

5-5 Mounting Example

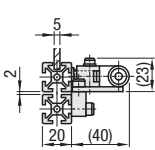

6-5 Mounting Example

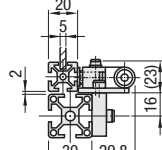

8-5 Mounting Example

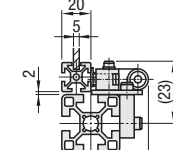

6-6 Mounting Example

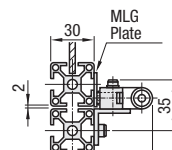

8-6 Mounting Example

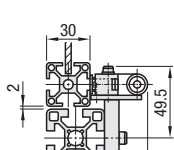

8-8 Mounting Example

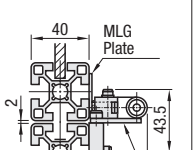

Dimensions in () are for 45 square extrusions. Catch plate for K Magnet is not used for 6-6.

Dimensions in () are for 45 square extrusions. Catch plate for K Magnet is not used for 8-8.

Part Number	Component												Unit Price	Volume Discount Rate	Selection Standards									
	Magnet Side														Door Side (Extrusion)									
	Type	No.	Magnet	Retaining Force N(kgf)	Mounting Plate		Screw	Quantity	Flat Washer	Quantity	Screw	Quantity			Nut	Quantity	Flat Head Screw	Quantity	Nut	Quantity	1 - 4 pc(s).	Door Side Plate	Body Side Extrusion	
With Sensor HMER	5-5		K Magnet	29.4 (3)	ML5-5						4				M3-6					20 Square	HMER5-5	HMER6-5	HMER8-5	
	6-5				ML68-5.8	HMER-ML	SCB4-18	2	PWF4	2	SCB5-15									30 Square		HMER6-6	HMER8-6	
	8-5				ML6-6	MLG Plate	SCB5-10	2				2								40 Square			HMER8-8	
	6-6				ML8-6	HMER-ML	SCB5-22	2				2												
	8-6				ML8-6	HMER-ML	SCB5-22	2					2											
	8-8					ML68-5.8	HMER-ML MLG Plate	SCB4-18	2			2												40 Square only

Ordering Example Part Number **HMER6-5**

Mounting Plate (Non-Set)



RoHS 10

HMER-ML

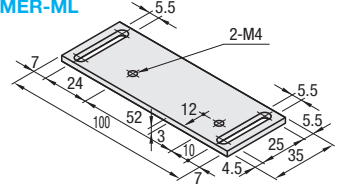

Part Number	Unit Price	Volume Discount Rate
HMER-ML	1 ~ 9 pc(s).	10 - 50

Ordering Example Part Number **HMER-ML**