

Hinges with Slotted Holes / Stainless Steel Hinges for Heavy Loads / Aluminum Detachable Hinges

Hinges with Slotted Holes



RoHS10

SHPSNA

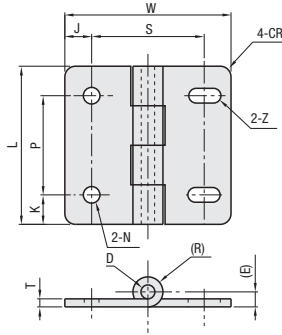

When mounting the hinges on panels, Hinge Nuts are recommended on P.811.

Material: SUS304

Part Number Type	No.	* Allowable Load		Mass (g)	L	W	K	P	J	S	N	Z	T	(E)	(R)	CR	D	Unit Price	Volume Discount Rate
		kg	N																
SHPSNA	5	9	88	34	41	36	8	25	7.5	21	5.5	5.5x6.5	2	4.6	4.6	4	5		
	6	12	117	48	48	48	9	30	8	32	6.5	5.5x10							
	8	25	245	111	59	62	11	37	10	42	6.5	6.5x10	3	6.1	6.1	5	6		

* The allowable load is the value when 2 pieces are used.

Stainless Steel Hinges for Heavy Loads



RoHS10

SHHPSZ

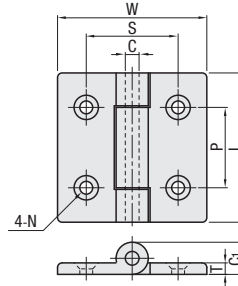

	Material	Surface Treatment
① Caster	SUS316	Buffed Finish
② Shaft		-

Part Number Type	No.	* Allowable Load (N)	Weight (g)	L	W	P	S	C	C ₁	T	N		Screw, Nut		Unit Price	Volume Discount Rate
											Through	Countersink	Screw	Nut		
SHHPSZ	6	350	110	47	48	30	32	6	14	5	5.5	11	Flat Head Screw 5-10	HNTT6-5		
	8	450	190	63	62	37	42	6	14	5	6.5	13	Flat Head Screw 6-12	HNTT8-6	4	
	8-45	450	190	63	80	43	47	8	16	6	6.5	13	Flat Head Screw 6-15	HNTT8-6	4	

* The allowable load is the value when 2 pieces are used.

Aluminum Detachable Hinges



RoHS10

HHPNL (For Left-hand Use) HHPNR (For Right-hand Use)

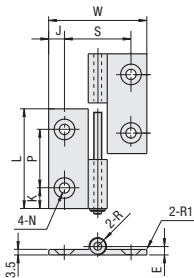

When mounting the hinges on panels, Hinge Nuts are recommended on P.811.

Material: A6063S-T5
Bushing: Polyacetal
Surface Treatment: Anodize

Part Number Type	No.	* Allowable Load		Mass (g)	L	W	K	P	J	S	N		E	R	Screw, Nut		Unit Price	Volume Discount Rate
		kg	N								Through	Countersink			Screw	Nut		
Aluminum Detachable Hinges	5			22	47	36	11	25	7.5	21	5.5	11	5	5	Flat Head Screw 5-8	HNTT5-5		
	HHPNL (For Left-hand Use)	6	10	98	33	48	8.5	30	8	32	6.5	13	5.5	5.5	Flat Head Screw 6-10	HNTT6-6	4	
	HHPNR (For Right-hand Use)	8			48	63	13	37	10	42					Flat Head Screw 6-12	HNTT8-6	4	

* The allowable load is the value when 2 pieces are used.

Ordering Example Part Number SHHPSZ6 HHPNL6

Alterations Part Number - (SET, SST) SHHPSZ6 - SST

When SET is specified, the product is not RoHS compliant.

Alteration	Code	Spec.	Hinge	No.
Applicable Screw and Nut Set	SET SST (Stainless Steel)	Applicable screws and nuts come in a set. When 'SST' is specified, screws and nuts will be in stainless steel. (When '-SET' is specified, the material of the Flat Head Screws is SCM435 and their surface treatment is Black Oxide.	SHPSNA	5
				6
				8
			SHHPSZ	6
				8
				8-45
			HHPNL	5
			HHPNR	6
	8			