

Tabbed Brackets - For 2 Slots

For 8 Series (Slot Width 10mm) Aluminum Extrusions

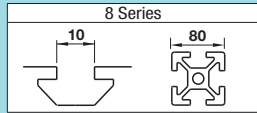

■ **Features:** Tabbed Brackets for 2-slot extrusions. Since the tabs stop rotating the brackets when tightening, work efficiency is improved.

■ Tabbed Brackets

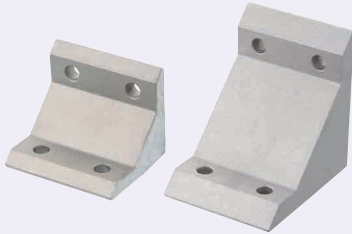

HBLFTD8

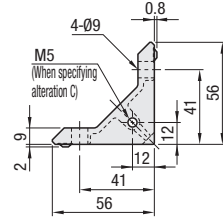
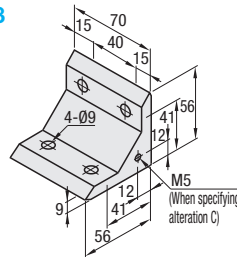

HBLFUD8

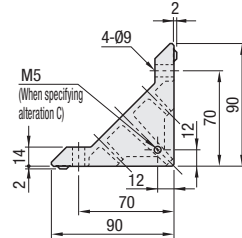
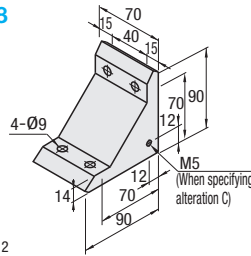

■ Material: ADC12

Part Number Type	Mass (g)	Applicable Screw, T Nut				Allowable Load (N)	Unit Price 1-99 pc(s).	Volume Discount Rate 100-200
		Screw	Quantity	T Nut	Quantity			
HBLFTD8	140	CBM8-20	4	HNTT8-8	4	3087		
HBLFUD8	370	CBM8-25	4	HNTT8-8	4	3920		



Example

Can be connected in parallel and perpendicular directions to the extrusion slot.

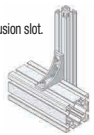

■ **Features:** Extrusions with 2 slots (HFS8-8080, etc.) can be connected with one bracket.

■ Tabbed Reversal Brackets



HBLFSD8 HBLFSDK8 (with Single Side Tab)

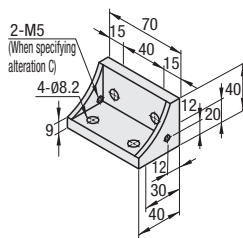

■ Material: ADC12

HBLFSD8 Side View

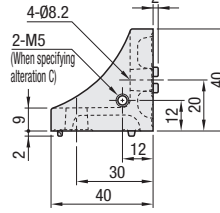

HBLFSDK8 Side View (Only bottom side of bracket has tabs.)

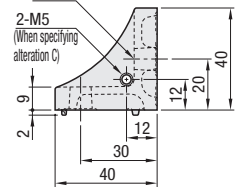

Part Number	Mass (g)	Applicable Screw, T Nut				Allowable Load (N)	Unit Price 1-99 pc(s).	Volume Discount Rate 100-200
		Screw	Quantity	T Nut	Quantity			
HBLFSD8	89	CBM8-20	4	HNTT8-8	4	3087		
HBLFSDK8								



Ordering Example

Part Number
HBLFSD8



Alterations



Part Number - (C, SET, SST, SEU, SSU, SEP, SSP, SEC)
HBLFSD8 - SET

Alterations	Code	Spec.	Applicable Bracket
Mounting Hole Alteration for Cover	C	Adds taps on a bracket for cover mounting. (M5 on Both Sides) (Mounting Screw HCBM on P.754) 	HBLFTD8
			HBLFUD8
			HBLFSD8
			HBLFSDK8



Example

■ Example of Cover Mounting
• Specify alteration code C.

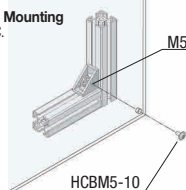

Alterations	Code	Spec.	Applicable Bracket
Applicable Screws and Nuts Set	SET SST (Stainless Steel)	Applicable screws and nuts for fixing the brackets on extrusions come in a set. (Adds to the bracket price.) (Ex.) When HBLFSD8 is specified: Code Screw Nut SET CBM8-20 HNTT8-8 SST SCB8-20 HNTTSM8-8 SEU CBM8-20 HNTU8-8 SSU SCB8-20 SHNTU8-8 SEP CBM8-20 HNTP8-8 SSP SCB8-20 SHNTP8-8 SEC HCBST8-24 HNTT8-8 ⚠ When specifying other than HBLFSD8, check for the applicable screws and nuts.	HBLFTD8
	SEU (Pre-Assembly Insertion) Spring Nuts SSU (Pre-Assembly Insertion) Spring Nuts Stainless Steel		HBLFUD8
	SEP (Post-Assembly Insertion) Spring Nuts SSP (Post-Assembly Insertion) Spring Nuts Stainless Steel		HBLFSD8
	SEC (Screws with Cap and Washer) and Nuts		HBLFSDK8

⚠ Included Screw is not RoHS compliant when -SET, -SEU or -SEP are specified.