

Post-Assembly Insertion Nuts/Stoppers for Aluminum Extrusions - Standard For 6 Series (Slot Width 8mm)

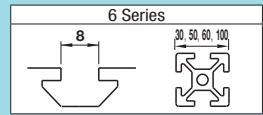

Tightening Torque **P526**

Post-Assembly Insertion Stopper Nuts **RoHS 10**

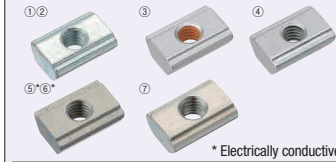

Type	Material	Surface Treatment
① HNTA6	S10C Equivalent	Trivalent Chromate
② PACK-HNTA6		
③ HNTAV6		
④ HNTAZ6	SUS316 Equivalent (Sintered)	-
⑤ HNTASN6*		
⑥ PACK-HNTASN6*		
⑦ HNTASS6		

* Electrically conductive

HNTA6 (S10C Equivalent)
PACK-HNTA6 (S10C Equivalent, 100/pkg.)
HNTAV6 (Thread Locking Adhesive Type, S10C Equivalent)
HNTAZ6 (Thread Locking Resin Coating Type, S10C Equivalent)
HNTASN6 (SUS316 Equivalent, Sintered)
PACK-HNTASN6 (SUS316 Equivalent, Sintered, 100/pkg.)
HNTASS6 (SUS303 Equivalent)

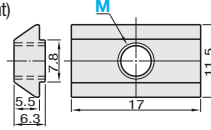

Reference Tightening Torque (N·m)	
M	S10C Equivalent / SUS316 Equivalent (Sintered) / SUS303 Equivalent
6	11.7

Details of Thread Locking Type **P623**



Example

Post-Assembly Insertion Stopper Nuts

HNTA
HNTAV
HNTAZ
HNTASN
HNTASS

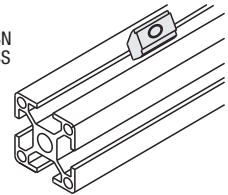

Part Number	M	Unit Price				Volume Discount Rate		
		1 - 499 pc(s)	500-749	750-999	1000-1500			
HNTA6 (S10C Equivalent)	3 4 5							
HNTAV6 (Thread Locking, S10C Equivalent)	6							
HNTAZ6 (Thread Locking, S10C Equivalent)	6							
HNTASN6 (SUS316 Equivalent, Sintered)	3 4 5 6							
HNTASS6 (SUS303 Equivalent)	6							

Bulk Packages 100 pcs. per package

Part Number	M	Unit Price (1 ~ 10 packages)	
		Package Price	Price per Pkg.
PACK-HNTA6 (S10C Equivalent)	3 4 5		
PACK-HNTASN6 (SUS316 Equivalent, Sintered)	3 4 5 6		



Ordering Example Part Number - M
HNTA6 - 6

Post-Assembly Insertion Stoppers / Metal Stoppers **RoHS 10**

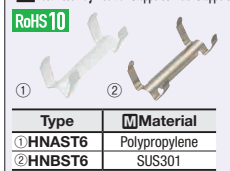

Type	Material
① HNA6T6	Polypropylene
② HNB6T6	SUS301

HNA6T6 (Polypropylene)
HNB6T6 (SUS301)

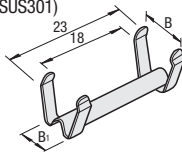

Part Number	Applicable Stopper Nut	Color	B	B1	Unit Price			Volume Discount Rate		
					1 - 499 pc(s)	500-999	1000-1500			
HNA6T6	HNTA6 HNTAV6 HNTASN6 HNTASS6	White	9.3	7.8						
HNB6T6	-	-	10.5	6						

Post-Assembly Insertion Nut and Stopper Set **RoHS 10**



HNTA6T6 (S10C Equivalent Set)
HNTASN6T6 (SUS316 Equivalent Set)

Type	Stopper Nut	Stopper
HNTA6T6	HNTA6	HNA6T6
HNTASN6T6*	HNTASN6	HNB6T6

* Electrically conductive

Part Number	M	Unit Price				Volume Discount Rate		
		1 - 499 pc(s)	500-749	750-999	1000-1500			
HNTA6T6	3 4 5							
HNTASN6T6	3 4 5 6							

Post-Assembly Insertion Nut and Metal Stopper Set **RoHS 10**

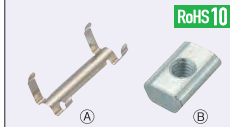

HNTB6T6 (S10C Equivalent Set)
HNTASN6T6 (SUS316 Equivalent Set)

Type	Stopper Nut	Stopper
HNTB6T6	HNTA6	HNB6T6
HNTASN6T6*	HNTASN6	HNB6T6

* Electrically conductive

Part Number	M	Unit Price				Volume Discount Rate		
		1 - 499 pc(s)	500-749	750-999	1000-1500			
HNTB6T6	3 4 5							
HNTASN6T6	3 4 5 6							



Example

*Insert a stopper into the extrusion and put into a nut on it.

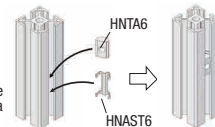

*Does not fall even if the extrusion is placed vertically.

Part Number - M
HNTA6T6 - 6

Post-Assembly Insertion Nuts **RoHS 10**



Type	Material	Surface Treatment
① HNTF6	S10C Equivalent	Trivalent Chromate
② HNTFV6		
③ HNTFZ6		
④ HNTFSN6*	SUS316 Equivalent (Sintered)	-

* Electrically conductive

HNTF6 (S10C Equivalent)
HNTFV6 (Thread Locking Adhesive Type, S10C Equivalent)
HNTFZ6 (Thread Locking Resin Coating Type, S10C Equivalent)
HNTFSN6 (SUS316 Equivalent, Sintered)

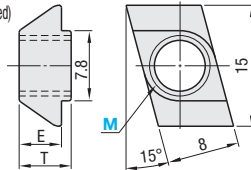

Reference Tightening Torque (N·m)	
M	S10C Equivalent / SUS316 Equivalent (Sintered)
6	11.7

Details of Thread Locking Type **P623**



Example

Post-Assembly Insertion Nut

HNTF
HNTFV
HNTFZ
HNTFSN

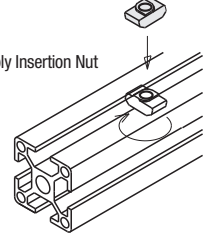

Ordering Example Part Number - M
HNTF6 - 6

Part Number	M	E	T	Unit Price				Volume Discount Rate		
				1 - 499 pc(s)	500-749	750-999	1000-1500			
HNTF6 (S10C Equivalent)	3 4 5 6									
HNTFV6 (Thread Locking, S10C Equivalent)	6	5.5	6.3							
HNTFZ6 (Thread Locking, S10C Equivalent)	6									
HNTFSN6 (SUS316 Equivalent, Sintered)	3 4 5 6	6.4	7.4							