

CHSP

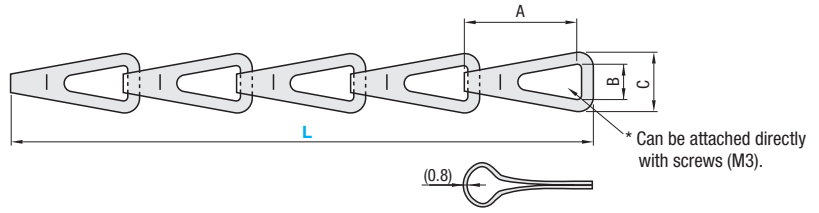

Material: SUS304

Part Number Type	No.	L 50mm Increment	A	B	C	Plate Thickness	Mass	Applied Load	Unit Price

*Depending on the number of links, the actual L dimension may be slightly longer than the specified dimension. (Connecting parts are not included. Please refer to <http://jp.misumi-ec.com/mech/>.)

The reference applied load is only a guideline.

Ordering Example

Part Number	-	L
CHSP4	-	100



SKC

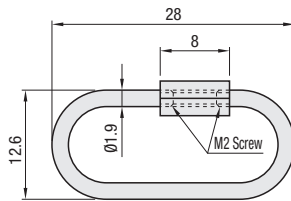

Material: SUS304

Part Number	Mass	Applied Load	Unit Price			Volume Discount Rate		
			1 ~ 19 pc(s)	20 ~ 29 pcs	30 ~ 49 pcs	50 ~ 500 pcs		
SKC	3.2g	20kg						

The reference applied load is only a guideline.

For orders larger than indicated quantity, please check with WOS.

Ordering Example

Part Number
SKC

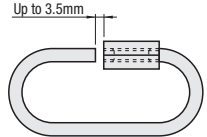

RWS

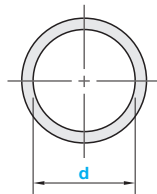

Material SUS304(d=10,18,22)
SUS316(d=8,12,14)

Part Number Type	Wire Dia.	Applied Load (kg)	Unit Price			Volume Discount Rate		
			1 ~ 3 pc(s)	4 ~ 19 pcs	20 ~ 49 pcs	50 ~ 500 pcs		
RWS	8	0.8	0.5					
	10	0.8	0.7					
	12	1	1					
	14	1.2	1					
	18	1	0.7					
	22	1.2	1					

Ordering Example

Part Number
RWS10