

# Stepped Dowel Pins / Insulating Dowel Pins / Plastic Dowel Pins

## Stepped Dowel Pins Standard with Tapped Hole



### MSFW

MSFWC (Stainless Steel)

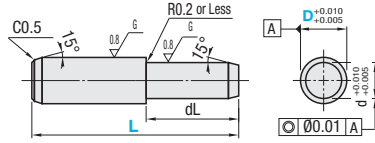

### MSFWM (With Tapped Hole)

MSFWCM (Stainless Steel with Tapped Hole)

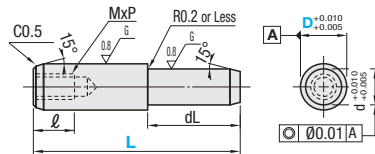

Type	Material	Hardness
MSFW MSFWM	SUSJ2	58HRC~
MSFWC MSFWCM	SUS440C	

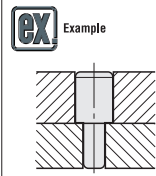

Convenient for readjustment and prevention to fall off.

Part Number Type	D	L	MxP	ℓ	d	dL	Unit Price			
							MSFW	MSFWC	MSFWM	MSFWCM
5	15	-	-	-	4	5				
	25					10				
6	20	-	-	-	5	10				
	30					15				
8	25	4x0.7	-	-	6	10				
	35					15				
10	35	5x0.8	-	-	8	15				
	40					15				
13	45	6x1.0	-	-	10	20				
	55					25				
	70					30				



Ordering Example  
Part Number - L  
MSFW10 - 35

## Insulating Dowel Pins



RoHS10

### MSIP

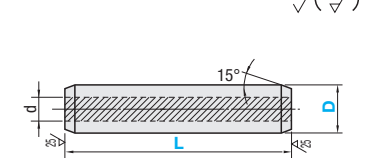

Material: Fabric Base Bakelite Core Rod: SUS304  
Properties of Bakelite: P955  
The D dimension tolerance is the result of measurement at room temperature (20°C).



Ordering Example  
Part Number - L  
MSIP6 - 30

Part Number Type	D	D Tolerance	d	L							Unit Price								
				L8-10	L15	L20	L25	L30	L35	L40	L45	L50							
MSIP	6	+0.03 0	3	8	10	15	20	25	30	35	40								
	8		10	15	20	25	30	35	40										
	9		15	20	25	30	35	40	45	50									
	10		15	20	25	30	35	40	45	50									
12		5	20	25	30	35	40	45	50										
		6	20	25	30	35	40	45	50										

## Plastic Dowel Pins



RoHS10

### MSIPJ

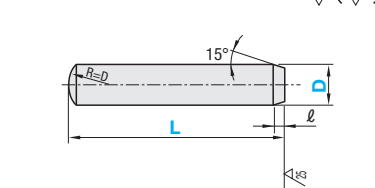

Material: Polycarbonate  
Properties of Polycarbonate: P949  
The D dimension tolerance is the result of measurement at room temperature (20°C).



Ordering Example  
Part Number - L  
MSIPJ6 - 25

Part Number Type	D	D Tolerance	ℓ	L				Unit Price					
				L10	L15	L20	L25	L10	L15	L20	L25		
MSIPJ	3	+0.03 0	1.0	10	15	20							
	4		10	15	20								
	5		10	15	20								
	6		10	15	20	25							
	8		15	20	25								

## Static Shear Failure Data

D	Static Yield Load (kN)
3	0.4
4	0.6
5	1.1
6	1.4
8	2.1

