

Similar Products Comparison Points | Travel Accuracy Straightness 50µm

Similar Product Pages P.1961

Features: No knob is required since a hex wrench is used to feed the stage, making for a space saving form factor. Unintended position changes can be prevented since the stage cannot be operated without a hex wrench.



Clamp Position Change  
**XFEE5** □ -R (Right/Left Reversed)

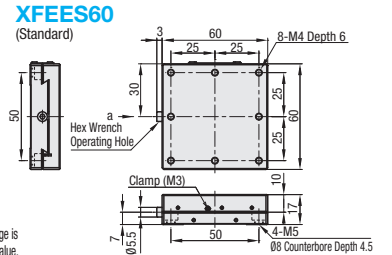
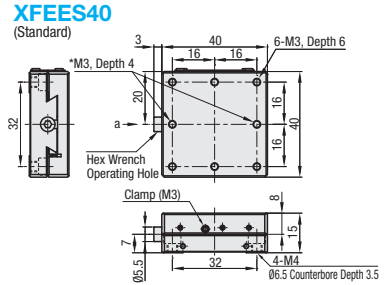
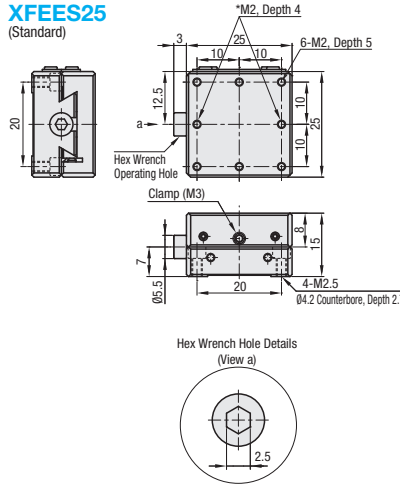
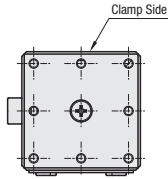

Please note that the plate might be removed when the stage is moved in a travel distance more than the predetermined value.  
\*The depth will be short due to the stage shape. **M**Material: Aluminum Alloy **S**Surface Treatment: Black Anodize

**X-Axis Stages** High Precision Stage Existing Product: XEEG (P.1961)

Type	Part Number		Stage Surface (mm)	Travel Distance (mm)	Travel per Rotation (mm)	Load Capacity (N)		Travel Accuracy	Weight (kg)	Unit Price
	No.	Clamp Position				Horizontal	Vertical			
XFEE5	25	No Symbol (Standard)	25x25	±5	0.5	29.4	9.8	50µm	0.03	
	40	R (Right/Left Reversed)	40x40	±7		39.2	19.6		0.06	
	60	R (Right/Left Reversed)	60x60	±8					0.16	

Resolution (Vernier Scale Indication): 0.1mm/division



Features: Stages with 0.5mm fine lead.

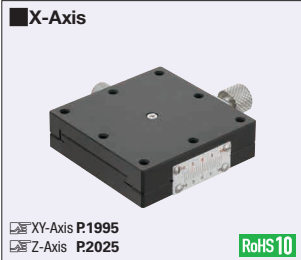

Clamp Position Change  
**XFES** □ -R (Right/Left Reversed)

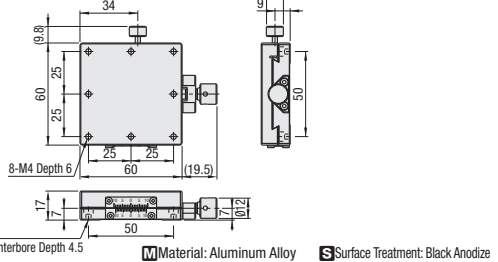
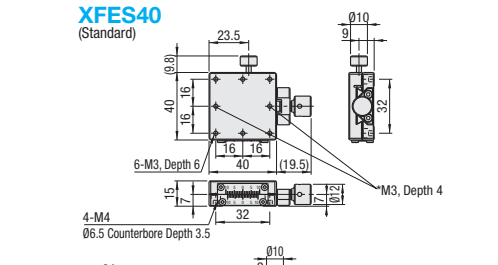
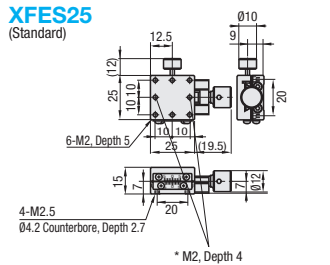
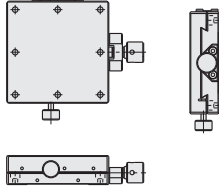

\*The depth will be short due to the stage shape. **M**Material: Aluminum Alloy **S**Surface Treatment: Black Anodize

**X-Axis Stages** High Precision Stage Existing Product: XEG (P.1941)

Type	Part Number		Stage Surface (mm)	Travel Distance (mm)	Travel per Rotation (mm)	Load Capacity (N)		Travel Accuracy	Weight (kg)	Unit Price
	No.	Clamp Position				Horizontal	Vertical			
XFES	25	No Symbol (Standard)	25x25	±5	0.5	29.4	9.8	50µm	0.04	
	40	R (Right/Left Reversed)	40x40	±7		39.2	19.6		0.08	
	60	R (Right/Left Reversed)	60x60	±8					0.18	

Resolution (Vernier Scale Indication): 0.1mm/division

Extension Cover HDEXT12-□ (sold separately); Ø12 knobs can be extended by installing the cover. P.2068  
(Caution) Please note that increased knob diameter may interfere with the stage mounting base surfaces.

