

# One-Touch Table Top Chains

## Thin, Straight Running

Registration of a design pending

**Features:** Available for wide surface transfer by combination. Two-row type is available as a set. Three or more rows are also connectable.

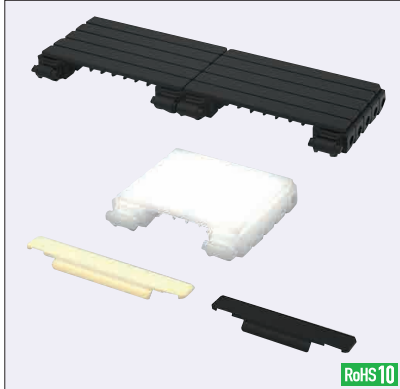

RoHS 10

**Set Parts List (Specification: For General Use)**

Set Number	Part Number	Nominal	
		40	40W
(1)	CHEA40	2 pcs.	2 pcs.
(2)	CHEA40W	-	1 pc.
*(3)	CHEP40-75	1 pc.	2 pcs.
*(4)	CHEP40-100	1 pc.	2 pcs.

\*For A75, (3) is applicable; for A100, (4) is applicable.

**Allowable Tension and Reference Weight**

Nominal	Allowable Tension (N)				Reference Weight (kg/m)	
	CHEF	CHEFS	CHEFC	CHEFY	A75	A100
40	390	320	460	380	0.86	0.94
40W	390	320	460	380	1.65	1.81

Part Number		Specification	Material	Color	Sliding Friction Coefficient f1	Operating Temp. (°C)
Set	Flap					
CHEF	CHEP	General Use	POM	White	0.14~0.18	-5~65
CHEFS	CHEPS	Extra Low Friction	POM + Lubricant	Cream	0.12~0.15	-5~65
CHEFC	CHEPC	Conductivity, Heat Resistant	POM + Glass Fiber	Black	0.20~0.24	-20~120
CHEFY	CHEPY	Chemical Resistant	Fluororesin	Translucent	0.18~0.22	-20~80

**Thin Table Top Chain Set**

CHEF  
CHEFS  
CHEFC  
CHEFY

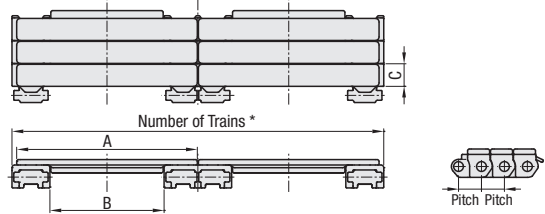

**Flap Plate**

CHEP  
CHEPS  
CHEPC  
CHEPY

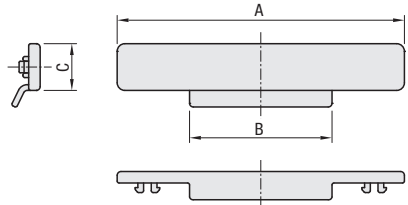

- How to Select Applicable Chains **P.1578**
- For Sprockets applicable to Chains with 400W Nominal, see **P.1585**
- Since the bending angle of chain is predetermined, specify the mating sprocket with the number of teeth, 14 or more.
- A set comes with Flap Plates and Narrow One-Touch Table Top Chains Attachment Type (**P. 1579**).
- For Allowable Tension and Corrosion Resistance List, see **P.1577**
- May have scratches when links are removed.

Part Number	Type	Nominal	A	Number of Links	Number of Rows	Pitch	B	C
	40W	100	Number of Links Fixed 20	62.2				
				100	2	37.2		
				Number of Links Fixed (disconnected) 20-NA		62.2		

Part Number	Type	Nominal	A	B	C	Unit Price (Unit : 20 Links)			
						CHEP	CHEPS	CHEPC	CHEPY
Flap Plate CHEP CHEPS CHEPC CHEPY	40	75	37.2	11.7	11.7				
						100	62.2		

For Number of Links 20NA (disconnected), links are not connected. Use them to adjust amount or for repairing.

**Number of Links Configurable**

Part Number	Type	Nominal	A	Unit Price (Unit : 20 Links)				Unit Price (Unit : 100 Links)			
				CHEF	CHEFS	CHEFC	CHEFY	CHEF	CHEFS	CHEFC	CHEFY
Set CHEF CHEFS CHEFC CHEFY	40	75									
		100									
	40W	75									
		100									

How to Order  
Please order in combination with "Number of Links Fixed Type" and "Number of Links Fixed Type (disconnected)" or "Number of Links Configurable Type".

**Number of Links Configurable**

Part Number	Type	Nominal	A	Unit Price (Unit : 1 Link)			
				CHEF	CHEFS	CHEFC	CHEFY
Set CHEF CHEFS CHEFC CHEFY	40	75					
		100					
	40W	75					
		100					

Number of Links Fixed Type is more economical.



Ordering Example  
Part Number - A - Number of Links  
CHEF40 - 75 - 100  
CHEP40 - 100 - 23



Example

