

Screw Jacks / Leveling Screws

Standard, Large Holes for Adjustment with Wrench Flats

■ **Features:** Possible to finely adjust heights without machining a tapped hole on a plate.

■ Screw Jacks



Type	M Material	S Surface Treatment
SJKB	S45C	Black Oxide
SJKN		Electroless Nickel Plating
SJKS	SUS304	-

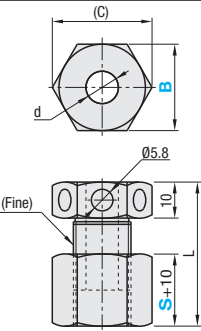
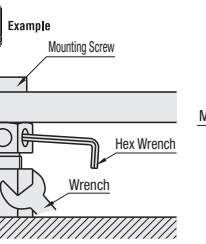

Part Number - S - (NR)
SJKS24 - 10 - NR

Alteration Code	Wrench Hole Machining on Nut Side
NR	

Spec.

Adds 6 wrench holes on the nut side.

Part Number Type	B	S Selection (Stroke)	M (Fine)	MxPitch (Fine)	d	L			(C)	Applicable Screw	Allowable Load (N)		Unit Price		
						S=10	S=20	S=30			S45C	SUS304	SJKB	SJKN	SJKS
SJKB	17	10 20 30	10	10x1.0	5.5	30-40	40-60	50-80	19.6	M5	332	198			
SJKN	19		12	12x1.0	7				21.9	M6	406	242			
SJKB	24		16	16x1.5	9				27.7	M8	535	320			
SJKS	27		20	20x1.5	11				31.2	M10	683	408			

⚠ The allowable loads are theoretical reference values and not guaranteed values.

Ordering Example Part Number - S
SJKB17 - 20

■ Leveling Screws Standard



Type	M Material	S Surface Treatment
L Selectable Type	S45C	Black Oxide
L Configurable Type	Equivalent	Electroless Nickel Plating
	SUS304	-

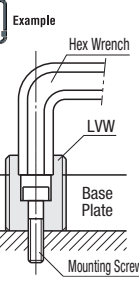
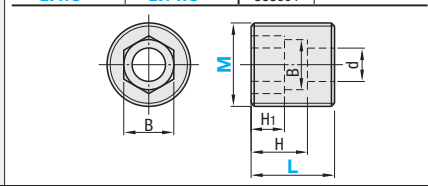

How to Use

- Leveling screws are used to adjust parallelism of a base plate. (The base plate must be tapped.)
- Leveling Screw LVW: Loosen the mounting screw first. LVW can then be turned to provide fine adjustments to the base plate.

Part Number Type	M (Fine)	L						B	MxPitch (Fine)	d	H1	H	Applicable Screw	Unit Price							
		Selectable		Configurable 1mm Increment										L Selectable Type			L Configurable Type				
(L Selectable)	12	10	15	20	10-30		6	12x1.0	3.5	4	8.5	M3	L=10-30	L=35, 40	L=10-30	L=35, 40	L=10-30	L=35, 40	LFW	LFWM	LVFS
(L Configurable)	16	15	20	30	15-40		8	16x1.5	4.5	5	12	M4	-	-	-	-	-	-	-	-	-
LVW	20	15	20	25	35	40	10	20x1.5	5.5	6	13	M5	-	-	-	-	-	-	-	-	-
LVWM	24	20	25	30	40	20-50	14	24x1.5	6.5	8	17	M6	-	-	-	-	-	-	-	-	-
LVWS	30	25	30	40	25-60	17	30x1.5	9	10	22	M8	-	-	-	-	-	-	-	-	-	-

Ordering Example Part Number - L
LVW12 - 20

■ Leveling Screws Large Holes for Adjustment with Wrench Flats



Type	Main Body		Accessory (Washer)	
	M Material	S Surface Treatment	M Material	S Surface Treatment
LVGB	S45C	Black Oxide	SPCC	Trivalent Chromate
LVGM		Electroless Nickel Plating	-	-
LVGS	SUS304	-	SUS304	-

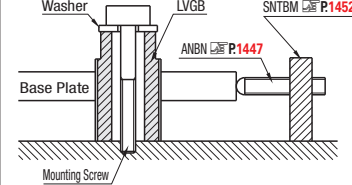
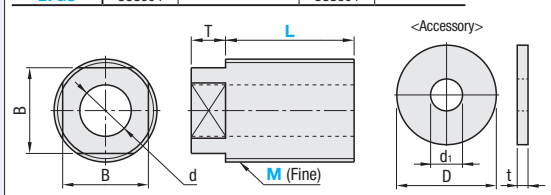

- As the I.D. is larger than the mounting screws, the horizontal movement of the plate is allowable.
- As the T dimension part is served for wrench tightening, the clearance can be prevented when lightening the mounting screws.

Part Number Type	M (Fine)	L Selection				B	MxPitch (Fine)	d	T	Applicable Screw	Accessory			Unit Price							
		LVGB	LVGM	LVGS	D						d1	t	LVGB	LVGM	LVGS						
	12	10	15	20	10	12x1.0	6	6	M4	10	4.5	1.6	10	4.5	1.5	L=10-30	L=35, 40	L=10-30	L=35, 40	L=10-30	L=35, 40
	16	15	20	25	30	12	16x1.5	8	8	M5	16	5.5	2	12	5.5	2	-	-	-	-	-
	20	15	20	25	30	17	20x1.5	9	10	M6	16	6.5	3.2	13	6.5	3	-	-	-	-	-
	24	20	25	30	35	19	24x1.5	9	10	M6	16	6.5	3.2	13	6.5	3	-	-	-	-	-
	30	25	30	35	40	22	30x1.5	12	12	M8	20	8.5	3	22	8.5	3	-	-	-	-	-

Ordering Example Part Number - L
LVGB20 - 40