

**Features:** Large-headed Stoppers. Best for receiving workpieces on large surfaces.

**Hex Socket Head Cap MC Nylon Type**



RoHS 10

\* For bolt strength class, see P.2297

Type	Stopper		Screw			Accessory (Hex Nut)	
	Material	Material	Strength Class	Surface Treatment	Material	Surface Treatment	
UNAHM	MC Nylon	SCM435	8.8	Trivalent Chromate	SS400	Trivalent Chromate	

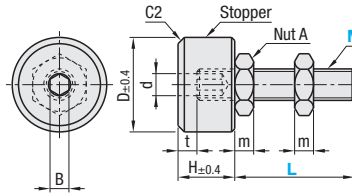

- ⦿ Bolts and MC Nylon are adhered together using adhesives.
  - ⦿ Contact Nut A to the MC Nylon for use.
  - ⦿ If strong forces are applied, the MC Nylon may be damaged.
  - ⦿ Do not use from the B direction.
- 
- ⦿ For tightening, use a Hex Hole, not Nut A.

Part Number Type	M (Coarse)	L Selection						t	D	d	B	H	m	Unit Price
		4	5	6	8	10	12							
UNAHM	4	10	15	20	25	30	3	10	2.4	2	7	2.4		
	5	15	20	25	30	40	4	12	3	2.5	9	3.2		
	6	15	20	25	30	40	50	5	15	3.5	3	10	3.6	
	8		25	30	40	50	6	20	4.7	4	13	5		
	10			30	40	50	7	25	6	5	15	6		
	12				30	40	50	8	30	7	6	18	7	
	16					30	40	50	40	9.5	8	22	10	

Ordering Example Part Number - L  
UNAHM5 - 15

**Hex Socket Head Cap Urethane Type**



\* For bolt strength class, see P.2297

Type	Stopper		Screw			Accessory (Hex Nut)	
	Material	Hardness	Material	Strength Class	Surface Treatment	Material	Surface Treatment
UNAH	Urethane (Black)	Shore A90	SCM435	10.9	Trivalent Chromate	SS400	Trivalent Chromate
UNAAH	Urethane (Blue)	Shore A70	SCM435	10.9	Trivalent Chromate	SS400	Trivalent Chromate
SLUNA	Low Repulsion Urethane (Gray)	Shore A70	SUS304	-	-	SUS304 Equivalent	-

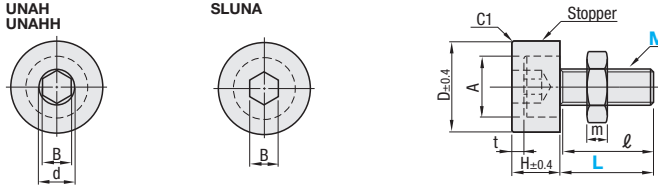

Part Number Type	M (Coarse)	L Selection						t	D	A	d	B	H	ℓ	m	Unit Price			
		UNAH-SLUNA			UNAAH											UNAH	UNAAH	SLUNA	
UNAH UNAAH SLUNA	3	10	15				10	15											
	4	10	15	20	(*25)	(*30)	10	15	20	*25	*30	3	7	Full Thread	1.8				
	5	10	15	20	25	*30	(*40)	10	15	20	25	*30	*40	7	Full Thread (22)	2.4			
	6	10	15	20	25	30	*40	(*50)	15	20	25	*30	*40	9	Full Thread (24)	3.2			
	8	10	15	20	25	30	*40	*50	15	20	25	30	*40	*50	10	Full Thread (26)	3.6		
	10	10	15	20	25	30	*40	*50	25	30	*40	*50	*60	13	Full Thread (30)	5			
	12	15	20	25	30	40			30	40	*50	*60	*70	15	Full Thread (34)	6			
16	20	25	30	40															
																			30
	40	24	17	14	22	Full Thread	10												

⦿ L sizes in ( ) are not available for SLUNA. ⦿ ℓ dimension for \* marked L dimension is in ( ).

**Tip Hex Socket Urethane Type**



\* For bolt strength class, see P.2297

Type	Stopper		Screw			Accessory (Hex Nut)	
	Material	Hardness	Material	Strength Class	Surface Treatment	Material	Surface Treatment
UNBH	Urethane (Black)	Shore A90	SCM435	10.9	Trivalent Chromate	SS400	Trivalent Chromate
UNBHH	Urethane (Blue)	Shore A70	SCM435	10.9	Trivalent Chromate	SS400	Trivalent Chromate

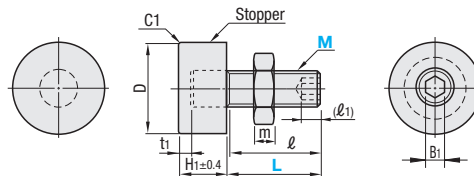

Part Number Type	M (Coarse)	L Selection						t <sub>1</sub>	D	B <sub>1</sub>	H <sub>1</sub>	ℓ	m	ℓ <sub>1</sub>	Unit Price	
		4	5	6	8	10	15								20	25
UNBH UNBHH	3	10	15													
	4	10	15	20	25	30	4	7.5	1.5	14	Full Thread	1.8	1.8			
	5	15	20	25	30	40	5	10	2	15	Full Thread	2.4	2.2			
	6	15	20	25	30	40	50	12.5	2.5	16	Full Thread	3.2	2.8			
	8		25	30	40	50	60	15	3	16	Full Thread	3.6	3			
	10			30	40	50	60	20	4	16	Full Thread	5	4			
				30	40	50	60	25	5	16	Full Thread	6	5			

Ordering Example Part Number - L  
UNBH4 - 20  
UNBHH5 - 25