

Conveyor Chute / Angle Adjustment Bracket Single Article

■ **Features:** Chutes with their angle adjustable between 5 to 60 degrees. Plastic type is also available to make the workpiece move smoother and to prevent scratching of the workpiece.

Conveyor Chute



Type		Material	Allowable Load (kgf)	Thickness (t)	
Angle Adjustable	30° Angle-Fixed				
CSHWS	CSHYS	SUS304	15	1.5	
CSHWE	CSHYE	SUS304 + Stainless Steel Sliding Plate*		1.5 + 0.8 (Sliding Plate Thickness)	
CSHWU	CSHYU	SUS304 + Ultrahigh molecular weight polyethylene		1.5 + 0.25 (Polyethylene Thickness)	

* Use FENB0.5 (See P.1187)

Angle Adjustable CSHWS CSHWE CSHWU

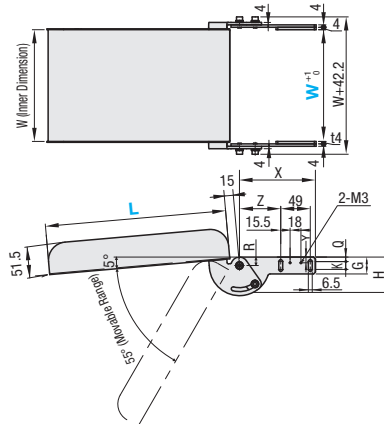

30° Angle-Fixed CSHYS CSHYE CSHYU

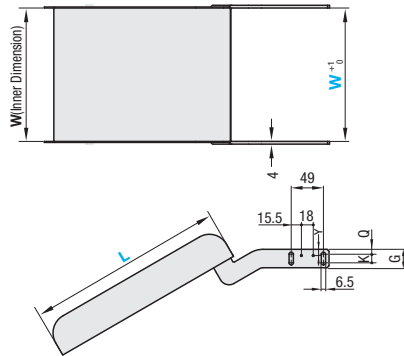

Applicable Conveyor Type	R	Z	X	K	Q	Y	G	H	Applicable Conveyors
A	14	68.5	126	13	9.5	7.5	28	57.1	SVKN/SVKR/CVGN/CVGP
B	14	98.5	156	13	9.5	7.5	28	57.1	CVGR/CVGW
C	24	83.5	141	30	10	10	48	75	CVSY/CV SX

- ① When L ≥ 310, we recommend the alteration YNS (Welding Nut + Leg).
- ② When mounting to MISUMI conveyors, the W dimensions should be: Belt Width + 40 for Bracket Type A, B; Belt Width + 50 for C.
- ③ We will ship Angle Adjustable Types unassembled. Assembly will be required on your side. The 30° Angle-Fixed Types will be shipped assembled.
- ④ M5/M6 Hex Socket Head Cap Screws and Washers are included for mounting of the conveyor. You will choose either of them and the rest will be left unused.

Angle Adjustable

Part Number	Applicable Conveyors Types	W 1mm Increment	L 10mm Increment	Applicable Conveyors	Conveyor Page
CSHWS	A	90-540	70-500	SVKN/SVKR/CVGN/CVGP	P.1201-1204,1213-1216
CSHWE	B	90-340		CVGR/CVGW	P.1217-1220
CSHWU	C	150-550		CVSY/CV SX	P.1233-1236

30° Angle-Fixed

Part Number	Applicable Conveyors Types	W 1mm Increment	L 10mm Increment	Applicable Conveyors	Conveyor Page
CSHYS	A	90-540	70-500	SVKN/SVKR/CVGN/CVGP	P.1201-1204,1213-1216
CSHYE	B	90-340		CVGR/CVGW	P.1217-1220
CSHYU	C	150-550		CVSY/CV SX	P.1233-1236

Alterations **Part Number** - **Applicable Conveyor Type** - **W** - **L** - (YNS800)
 CSHWE - A - 150 - 300 - YNS800

W	L	Unit Price					
		CSHWS	CSHWE	CSHWU	CSHYS	CSHYE	CSHYU
90-200	70-100						
	110-200						
	210-300						
	310-400						
201-300	410-500						
	70-100						
	110-200						
	210-300						
301-400	310-400						
	410-500						
	70-100						
	110-200						
401-550	210-300						
	310-400						
	410-500						
	70-100						

① W is 150~ for the applicable conveyor type C.

Ordering **Part Number** - **Applicable Conveyor Type** - **W** - **L**
 Example CSHWE - A - 150 - 300

For Adjusting Angle Bracket only

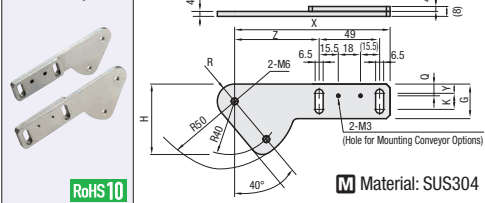

Alterations Code	Welded Nut	Welding Nut + Leg
	YN	YNS
Spec.	<p>Alterations for M6 nuts on both ends of the chute side. This will enhance versatility of mounting.</p>	<p>Alteration for legs to support loads. Configurable when W=150, 200; YNS=1200 The product will be shipped unassembled and assembly will be required on your side. (Ordering Code) YNS800 (Configurable Range 200 ~ 1200 (10 mm increment)) Accessory 2 pcs of Hex Socket Head Cap Screws</p>

Part Number	Applicable Conveyors Types	R	Z	X	K	Q	Y	G	H	Unit Price
CSHR	A	SVKN/SVKR/CVGN/CVGP	14	68.5	126	13	9.5	7.5	28	57.1
	B	CVGR/CVGW	14	98.5	156	13	9.5	7.5	28	57.1
	C	CVSY/CV SX	24	83.5	141	30	10	10	48	75

Ordering **Part Number**
 Example **Type** **Applicable Conveyor Type**
 CSHRA

