

Thrust Ball Bearings

Thrust Ball Bearings



RoHS10

B511 SB511
 B512

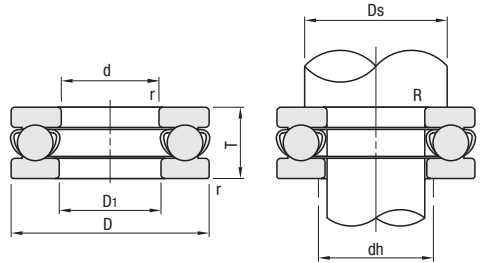

The raceway plates and the retainer come apart easily. Take care when opening the product package.

Material: Steel SUJ2
 Stainless Steel SUS440C Equivalent
 Bearing Accuracy: JIS B 1514 Class 0

Part Number		d	D	D ₁ (min)	T	r (min)	Basic Load Rating				Allowable Rotational Speed rpm (Reference)	Relative Dimensions			Mass (g) (Reference)		Unit Price	
							Ca (Dynamic) kN	Coa (Static) kN	Ca (Dynamic) kN	Coa (Static) kN		D _s (min)	d _h (max)	R (max)	Steel	Stainless Steel	Steel	Stainless Steel
B51100	SB51100	10	24	11	9	0.3	10.1	14	5	6.96	6700	18	16	0.3	19	21		
B51200	-						12.8	17.1	-	-	6000				0.6	28	-	-
B51101	SB51101	12	26	13	9	0.3	10.4	15.4	5.15	7.7	6700	20	18	0.3	21	23		
B51201	-						13.3	19	-	-	5600				0.6	31	-	-
B51102	SB51102	15	28	16	9	0.3	10.6	16.8	5.25	8.38	6300	23	20	0.3	23	24		
B51202	-						16.7	24.8	-	-	5000				0.6	43	-	-
B51103	SB51103	17	30	18	9	0.3	11.4	19.5	5.39	9.07	6000	25	22	0.3	25	26		
B51203	-						17.3	27.3	-	-	4800				0.6	50	-	-
B51104	SB51104	20	35	21	10	0.3	15.1	26.6	7.11	12.36	5300	29	26	0.3	37	40		
B51204	-						22.5	37.5	-	-	4300				0.6	77	-	-
B51105	SB51105	25	42	26	11	0.6	19.7	37	9.76	18.63	4800	35	32	0.6	56	60		
B51205	-						28	50.5	-	-	3800				0.6	111	-	-
B51106	SB51106	30	47	32	11	0.6	20.6	42	10.2	21.08	4300	40	37	0.6	64	69		
B51206	-						29.5	58	-	-	3400				0.6	137	-	-

kgf-Nx0.101972



Ordering Example

Part Number

B51200
 SB51100



Example

