

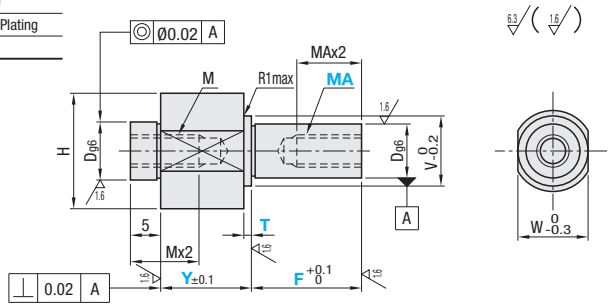

Type	Material	Surface Treatment
FXMB	S45C	Black Oxide
PFXMB	Equivalent	Electroless Nickel Plating
SFXMB	SUS304	-

Dimensions of Wrench Flats when Y ≥ 17

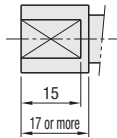

RoHS 10

Part Number	Type	No.	Dg6	1mm Increment		Selection		M Coarse	V	H	W	Unit Price			
				Y	F	T	MA (Coarse)					FXMB	PFXMB	SFXMB	
6	FXMB	6	6	4~60	5~75	1 3 5	3	M3	8	14	12				
8		8					4	M4	10	17	14				
10		10					4 5 6	M6	13	21	18				
12		12					5 6 8	M8	15	24	21				
15	PFXMB	15					10~100		6 8 10	18	28	25			
20		20							8 10 12	20	32	28			
25		25		8 10 12 16	24	36			32						
30	SFXMB	30			29	43			38						
					34	50			44						

Tap Size	Effective Length	Pilot Hole Depth
M3	6	11
M4	8	14
M5	10	17
M6	12	20
M8	12	25
M10	20	29
M12	24	34
M16	32	44

Please select Y, F and T so that M and MA don't interfere with each other.



Ordering Example

Part Number	Y	F	T	MA
FXMB20	20	F70	T5	MA6
SFXMB12	10	F100	T2	MA6



Alterations

Part Number	Y	F	T	MA	(SC)
PFXMB15	20	F60	T8	MA10	SC

Wrench Flats	
Alterations	
Code	SC
Spec.	<p>An alteration of wrench flats can be made for a slot hole guide.</p> <p>Ordering Code SC</p> <p>Ⓢ D (wrench flats) tolerance is +0.2/0.</p> <p>Ⓢ Y-T ≥ 6</p>



Example

