

# Support Units - Fixed Side, Round <Cost Reduction>

## Economy / Radial Bearing Type

### Fixed Side Economy

(Economical, for Intermediate and Low Speed Applications)



ReHS10

Type	Material		Surface Treatment	
	①③	⑤⑥	①③⑤⑥	
BRWE	S45C	SS400	Black Oxide	
BRWEM			Electroless Nickel Plating	
BRWER			Low Temperature Black Chrome Plating	

For No.10S, the I.D. of oil seal is smaller than the previous No.10S version.

### Component Details

Number	Part Name	Quantity
①	Bearing Housing	1
②	Japanese made angular contact bearing Grade 0	1 Set
③	Cover	1
④	Oil Seal	2
⑤	Collar	2
⑥	Bearing Nut (with Set Piece)	1

- Do not disassemble the fixed side main body ①, ②, ③ and ④ as they must remain assembled.
- BRWER bearing is filled with low dust generation grease.
- When used together with a MISUMI ball screw, there is one support unit accessory collar spare.

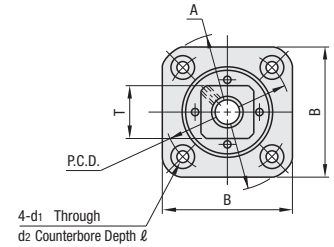
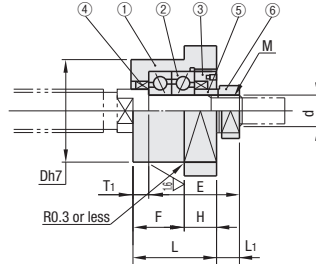

Part Number	Type	No.	d	L	H	F	E	D	A	P.C.D.	B	L1	T1	d1	d2	l	M (Fine)	T	Oil Seal Applicable Shaft Dia.	BRWE	BRWEM	BRWER
																				Unit Price	Unit Price	Unit Price
		10S																				
		10	10	26	10	16	29.5	34	52	42	42	8.5	5	4.5	8	4.5	M10x1.0	17	12	1 ~ 10 pc (s).		
		12	12					36	54	44	44						M12x1.0	19	15		1 ~ 10 pc (s).	
		15	15	30	13	17	38	40	63	50	52	14	6	5.5	9.5	5.5	M15x1.0	22	20			
		20	20	48	18	30	52	57	85	70	68		10	6.6	11	6.5	M20x1.0	30	25			
		25	25	54	24	30	59	63	98	80	79	15	10	9	15	8.5	M25x1.5	35	31			

### Fixed Side Radial Bearing Type

(Economical, for Low Speed Applications)



ReHS10

Type	Material		Surface Treatment	
	①③	⑤⑥	①③⑤⑥	
BRWZ	S45C	SS400	Black Oxide	
BRWZM			Electroless Nickel Plating	

Oil Seal ④ is not included in d=6.  
For No.8S and 10S, the I.D. of oil seal is smaller than the previous No.8S and No.10S versions.  
It is preloaded to bear the thrust load. Keep rotational speed within 3,000rpm.

### Component Details

Number	Part Name	Quantity
①	Bearing Housing	1
②	Japanese made radial bearing	1 Set
③	Cover	1
④	Oil Seal	1
⑤	Collar	2
⑥	Bearing Nut (with Set Piece)	1

- Do not disassemble the fixed side main body ①, ②, ③ and ④, as they must remain assembled.
- When used together with a MISUMI ball screw, there is one support unit accessory collar spare.

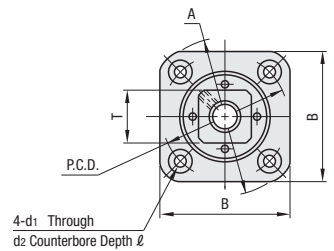
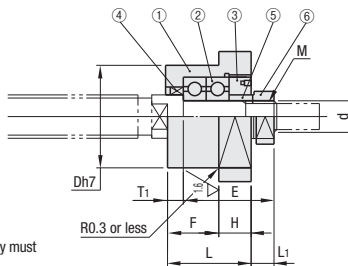

Part Number	Type	No.	d	L	H	F	E	D	A	P.C.D.	B	L1	T1	d1	d2	l	M (Fine)	T	Oil Seal Applicable Shaft Dia.	BRWZ	BRWZM
																				Unit Price	Unit Price
		6	6	20	7	13	22.5	22	35	28	28	6	3.5	2.9	5.5	3.5	M6x0.75	12	-	1 ~ 10 pc (s).	1 ~ 10 pc (s).
		8S																			
		8	8	23	9	14	26	28	43	35	35	7	4	3.4	6.5	4	M8x1.0	14	11.5		
		10S																			
		10	10	26	10	16	29.5	34	52	42	42	8.5	5	4.5	8	4.5	M10x1.0	17	12		
		12	12					36	54	44	44						M12x1.0	19	15		
		15	15	30	13	17	38	40	63	50	52	14	6	5.5	9.5	5.5	M15x1.0	22	20		
		20	20	48	18	30	52	57	85	70	68		10	6.6	11	6.5	M20x1.0	30	25		



Ordering Example

Part Number

BRWE15  
BRWZ15

For details of Bearings in addition to mounting interface accuracies of Support Units, Included Collar and Bearing Nut, see P.759