

V Guide Systems

Metric Size 70° Type Wheels and Bushings / Double Sided Tracks



Type	Material	Surface Hardness	Seal	Operating Temp.
MVH	SUJ2 Equivalent	58-62HRC	No.12 Nitrile Rubber	-20°C~120°C
MVHL			No.34 Metal Shield	
MVHS	SUS440C Equivalent		Nitrile Rubber	
MVHSL				

- Nitrile Rubber: Contact
- Metal Shield: Non-contact

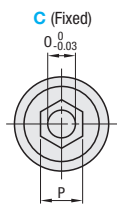
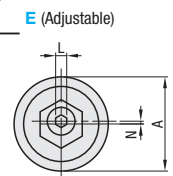
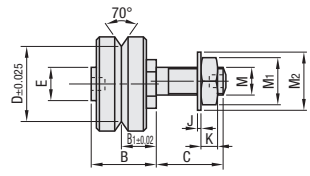

Part Number	Type	No.	C-Fixed E = Adjustable	Applicable Rail No.	A	B	B ₁	C	D	E	M	M ₁	M ₂	J	K	L	N Eccentricity	O	P	Tightening Torque N·m	Thrust Load L _S max. (N)	Radial Load R _{max} . (N)	Unit Price	
																							MVH	MVHL
MVH MVHS (C Dimension Short)	C	12	E	12	12.7	10.1	5.47	5.8	9.51	5	M4x0.5	7	9	0.8	2	-	0.5	4	7	2	22.5	45		
		25	F	25	25	16.6	9	9.8	20.27	10	M8x1.0	13	17	1	5	3	0.75	8	13	18	100	200		
		34	G	44	34	21.3	11.5	13.8	27.13	12	M10x1.25	17	21	1.25	6	4	1.0	10	15	33	200	400		
MVHL MVHSL (C Dimension Long)	E	12	F	12	12.7	10.1	5.47	9.5	9.51	5	M4x0.5	7	9	0.8	2	-	0.5	4	7	2	22.5	45		
		25	G	25	25	16.6	9	19	20.27	10	M8x1.0	13	17	1	5	3	0.75	8	13	18	100	200		
		34	H	44	34	21.3	11.5	22	27.13	12	M10x1.25	17	21	1.25	6	4	1.0	10	15	33	200	400		

⚠ No adjusting hexagon groove (L) for adjusting wheel (E) No.12. ⚠ Thrust load and radial load values are those when lubricated. For values when not lubricated, see P.653.



Type	Material	Surface Treatment	Hardness
Double Sided Tracks	MVR	SUJ2 Equivalent	Black Oxide
	MVRS	SUS420J1 Equivalent	58-62 HRC (70° Edge)

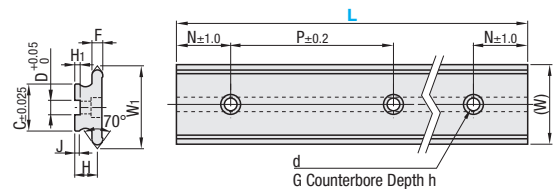

- ⚠ W1 is the dimension at the intersection of 70°. (Both ends are R machined.)
- ⚠ Tolerance C=0.025 is applicable to MVRS only.

RoHS10

Part Number	Type	No.	L Selection *	(W)	W ₁	F	H	H ₁	C	J	D	dxGxh	N	P
MVR	25	240-1140	25	26.58	4.93	10.2	2.5	15.4	2.6	6	5.5x10x5.1	30	90	
			44	44	45.58	6.42	12.7	3	26.4	2.3	8	7x11x6.1	30	90
MVRS	12	120-1020	12	12.37	3	6.2	1.8	8.5	1.7	4	3.5x6x3	15	45	
			25	25	25.74	4.5	10	2.5	15	2.5	6	5.5x10x5	30	90
			44	44	44.74	6	12.5	3	26	2.5	8	7x11x6	30	90

* For L dimensions, please refer to the price list.

Ordering Example: Part Number - Spec. - L
 MVH12 - C - 510
 MVRS25 - C - 510

L (Selection)	Unit Price	
	MVR12	MVRS12
120	165	
210	255	
300	345	
390	435	
480	525	
570	615	
660	705	
750	795	
840	885	
930	975	
1020		

L (Selection)	Unit Price			
	MVR25	MVRS25	MVR44	MVRS44
240	330			
420	510			
600	690			
780	870			
960	1050			
1140				