

# Linear Guides for Medium/Heavy Load - Stainless Steel

## Normal Clearance

**Features:** Linear Guides for Medium and Heavy Load excellent in corrosion resistance.

**Lubrication Units MX**  
Provides long term maintenance-free operation.

### Industry Standard



RoHS 10

Blocks and rails are not sold as separate items. Normal Clearance Type has guaranteed radial clearances and accuracies as sets of blocks and rails.

	Type		MX (Lubrication Units)	L Dimension	Number of Blocks	Material Hardness
	Medium Load	Heavy Load				
Standard Block	SSVR	SSXR	Blank: None -MX: Provided	Selectable	1	Stainless Steel 56HRC~
	SSV2R	SSX2R		2		
	SSVRL	SSXRL		1		
Wide Block	SSV2RL	SSX2RL		Configurable	2	
	SSVW	SSXW		Selectable	1	
	SSV2W	SSX2W		2		
	SSVWL	SSXWL	Configurable	1		
	SSV2WL	SSX2WL		2		

Heat Resistant Temperature: -20 ~ 80°C

Medium and Heavy Load

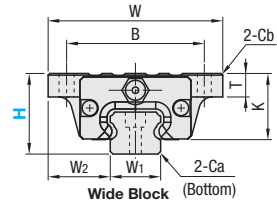
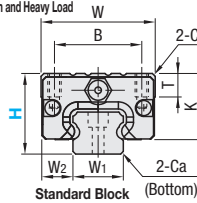

### Dimension Diagram of Blocks with MX (Lubrication Units)

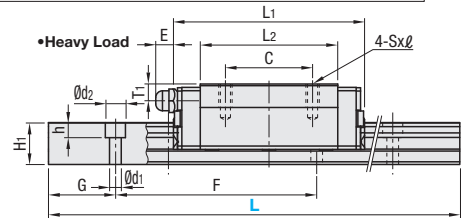
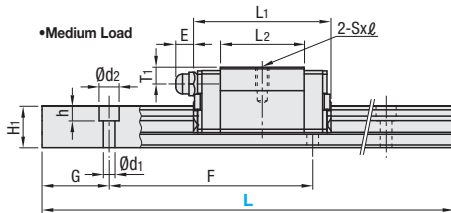
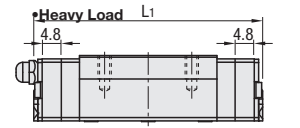
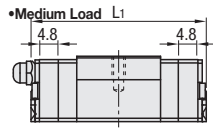

For L Configurable, G dimensions differ from those shown in the table below. For details, see P531.

### Precautions for Use

- Blocks are equipped with retainers to prevent balls from falling off. For how to handle the blocks, see P525.
- Radial clearances and accuracies are not guaranteed if the blocks and rails are interchanged from the original set combinations.
- Straight grooves are provided on datum planes. Be sure to match the datum lines when using.
- Rails cannot be connected end to end.
- The accuracy of Linear Guides is guaranteed after mounting the rail (after fastening screws on the rail and pushing it onto the datum plane).
- Minor bending of the rail will be adjusted after being mounted and will not affect the performance.

### Others

- Filled with Lithium soap based grease (Alvania Grease S2 by Showa Shell Sekiyu K.K.).
- Grease Fittings: Straight Type for H28 and Angled Type for H28 and H33.
- Grease Fitting is screw-in type, and thus, can be repositioned.
- For Operating Life Calculation, see P527
- For operating life calculations, use our free calculation software from [http://download.misumi.jp/mol/fa\\_soft.html](http://download.misumi.jp/mol/fa_soft.html).

	Part Number		H	L	Block Dimension											Guide Rail Dimension								
	Type	MX			W	Standard	L1	MX	B	C	Sxφ	L2	K	T	Cb	Grease Fitting	Mounting Hole	E	T1	H1	W1	W2	Ca	Counterbored Hole
Medium Load	(1 block)	Blank: None -MX: Provided	24	100-700 (160)	34 (52)	41	50.6	26 (41)	-	M4x7 (4.5)	25	20	7 (7)	0.85 (0.5)	M5xP0.8	6	5	12.5	15	9.5 (18.5)	0.5	3.5x6x4.5	60	20
	(2 blocks)		28	160-700 (220)	42 (59)	47	56.6	32 (49)	-	M5x8 (5.5)	27.6	22.5	7.5 (9)	1	M6xP0.75	13	6	15.5	20	11 (19.5)	0.6	6x9.5x8.5	60	20
			33	160-700 (220)	48 (73)	59	68.6	35 (60)	-	M6x9 (7)	37	26.5	8 (10)	1	M6xP0.75	13	6.8	18	23	12.5 (25)	0.8	7x11x9	60	20
Heavy Load	(1 block)	Blank: None -MX: Provided	24	100-700 (220)	34 (52)	57	66.6	26 (41)	26	M4x7 (4.5)	41	20	7 (7)	0.85 (0.5)	M5xP0.8	6	5	12.5	15	9.5 (18.5)	0.5	3.5x6x4.5	60	20
	(2 blocks)		28	160-700 (220)	42 (59)	67	76.6	32 (49)	32	M5x8 (5.5)	47.6	22.5	7.5 (9)	1	M6xP0.75	13	6	15.5	20	11 (19.5)	0.6	6x9.5x8.5	60	20
			33	160-700 (220)	48 (73)	83	92.6	35 (60)	35	M6x9 (7)	61	26.5	8 (10)	1	M6xP0.75	13	6.8	18	23	12.5 (25)	0.8	7x11x9	60	20

L Dimension: Dimensions in ( ) are for 2-Block Type.

Sxφ Dimensions: Dimensions in ( ) are for Wide Block Type.

kgf=Nx0.101972

Block	H	Basic Load Rating			Allowable Static Moment			Mass			
		C (Dynamic) kN	Co (Static) kN	MA, Mb N · m	Mc N · m	Block kg	Guide Rail kg/m	Standard	Wide	Standard	
Medium Load	24	5.0	8.23	33	57	0.15	0.20	1.5			
	28	7.2	12.1	58	135	0.20	0.25	2.4			
	33	11.7	19.6	109	225	0.30	0.40	3.4			
Heavy Load	24	8.6	14.2	69	98	0.20	0.25	1.5			
	28	12.5	21.3	155	232	0.30	0.35	2.4			
	33	20.2	34.5	275	393	0.45	0.60	3.4			

### Preload and Accuracy Standards

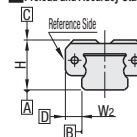

### Normal Clearance Type

Radial Clearance (µm)	Dimensional Accuracy (µm)	Standard Grade
H24	-4~+2	±100
H28	-5~+2	20
H33	-6~+3	±100

Dimensional Accuracy (µm)	Standard Grade
Height H Tolerance	±100
Pair Variation of Height H	20
Width W2 Tolerance	±100
Pair Variation of Width W2	H24, 28 H33
Running Parallelism of Plane C against Plane A	See P525
Running Parallelism of Plane D against Plane B	See P525

### Lubrication Units MX

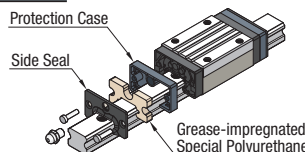

Advantages of Lubrication Unit MX: Provides long term maintenance-free operation. Reduces maintenance cost. Most suitable where the design does not allow lubrication. For details, see P530.