

Tall Blocks Housing Units

Double / Compact

= For customers using industry standard products =

The part enclosed in the red frame is as per industry standard specifications (Outer cylinder SUJ2 equivalent, Retainer resin). Consider these specifications while selecting the product.

Features: Compact: Max. 6mm lower in height (H dimension) and Max. 3mm smaller in width (W dimension) than Standard. (Standard and Compact Comparison **P318**)

Industry Standard

Standard



Compact



Type		Linear Bushing Used (P315) (P318)		Housing		Ambient Operating Temp.
Standard	Compact	Standard	Compact	Material	Surface Treatment	
LHSSW	LHSSKW	LMU	LMK	Aluminum Alloy	Clear Anodize	-20~80°C
LHSSWF	-	LMUF	-			-20~110°C
SLHSSW	-	SLMU	-			-20~80°C
SLHSSWF	-	SLMUS	-			-20~110°C

Standard

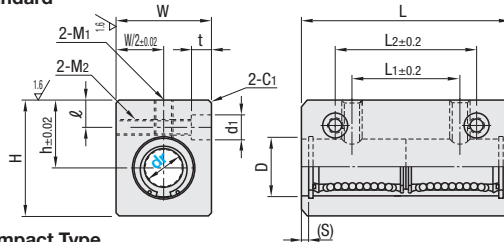

Compact Type

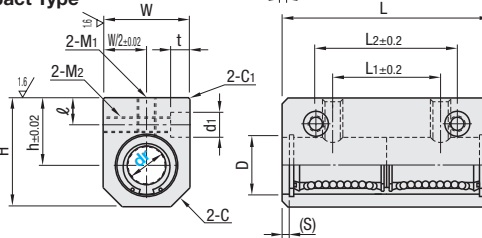

6.3 / (1.5 /)
(Housing)

dr	Tolerance	D		(S)	L	L1	L2	h		W		H		ℓ		M1 (Effective Length)		M2 (Effective Length)		C	C1	d1xt	
		Standard	Compact					Standard	Compact	Standard	Compact	Standard	Compact	Standard	Compact	Standard	Compact	Standard	Compact				Standard
4	0	8	-	1.1	27	14	22	10	-	12	-	16	-	3	-	M3 (6)	-	M3 (10.5)	-	-	0.5	4.2x1.5 (For M2 Screws)	
5	-0.008	10	-	4.0	40	18	28	13	-	15	-	20	-	-	-	M4 (8)	-	M4 (10)	-	-	1	6x5 (For M3 Screws)	
(6)	0	12	10	3.0	46	20	30	14	13	16	14	22	20	5	4	M4 (8)	M4 (11)	M4 (9)	4	1 or less	6	8x6 (For M4 Screws)	
(8)		15	13		56	30	42	16	15	20	17	26	24		5	M5 (8.5)	M4 (8.5)	M4 (15)	M4 (12)	5		1 or less	
(10)		19	17	4.0	68	36	50	19	18	26	23	32	30	6	6	M6 (9.5)	M6 (9.5)	M5 (20)	M5 (17)	6	1 or less	8	9x7 (For M5 Screws)
(12)		21	19		70		20	19	28	25	34	32	-		-	M5 (22)	M5 (19)	-	-	1	1 or less		
13		23	-	74	42	55	25	-	30	-	43	-	-	7	-	M6 (13)	M6 (23)	-	-	1	9	11x8 (For M6 Screws)	
(16)		28	26	84	52	65	27	26	36	33	49	43	7	7	M6 (13)	M6 (29)	M6 (26)	8	1 or less				
20	0	32	-	3.8	94	58	70	31	-	42	-	54	-	8	-	M8 (15)	-	M8 (34)	-	-	1	14x10 (For M8 Screws)	
25		40	-	3.2	128	80	100	37	-	52	-	65	-	9	-	M10 (17)	-	M10 (42)	-	-	1		
30		45	-		138	90	110	40	-	58	-	71	-		-	M10 (17.5)	-	M10 (48)	-	-	1		

For Precautions for Use, see **P303**. Only dr dimensions in () are available for Compact. Make certain that the screws do not interfere with the bushing as M1 are through holes. The datum surface is located on the other side of product ID label.

Part Number	Unit Price					
	Standard	Standard	Compact	Compact	Compact	
Type	dr	LHSSW	LHSSWF	SLHSSW	SLHSSWF	LHSSKW
(Standard)	4	-	-	-	-	-
	5	-	-	-	-	-
	6	-	-	-	-	-
	8	-	-	-	-	-
	10	-	-	-	-	-
	12	-	-	-	-	-
(Compact)	13	-	-	-	-	-
	16	-	-	-	-	-
	20	-	-	-	-	-
	25	-	-	-	-	-
	30	-	-	-	-	-

dr	Basic Load Rating				Allowable Static Moment (N·m)		Mass (g)	
	C (Dynamic) N	Co (Static) N	Standard	Compact	Standard	Compact	Standard	Compact
4	176	-	254	-	0.63	-	14	-
5	263	-	412	-	1.38	-	35	-
6	324	206	529	309	2.18	2.46	40	34
8	431	383	784	555	4.31	5.76	75	60
10	588	585	1100	867	7.24	10.99	150	126
12	657	608	1200	899	10.9	11.85	168	150
13	813	-	1570	-	11.6	-	248	-
16	1230	965	2350	1431	19.7	23.48	383	296
20	1400	-	2740	-	26.8	-	520	-
25	1560	-	3140	-	43.4	-	1120	-
30	2490	-	5490	-	82.8	-	1384	-

kgf=Nx0.101972



Ordering Example
Part Number
LHSSW12 (L Type Greased)
LHSSW12G (G Type Greased)
LHSSW12H (H Type Greased)

Alternative grease types available.
For Days to Ship, Price and Performance, see **P304**