

SUS-SJ TYPE



There are some non-conforming products.



Swivel



Plate type



Double Bearing

Double bearing



Stainless steel



SUS-SJ-100N

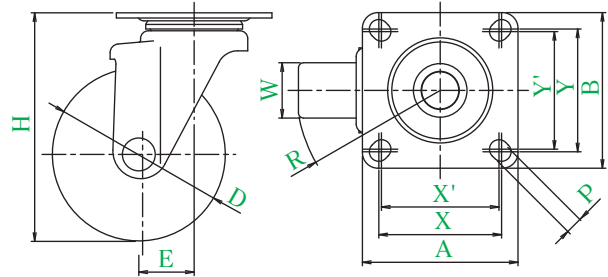

Description of product number

SUS - SJ - 100 N

Bracket type	Wheel diameter	Wheel type
--------------	----------------	------------

Bracket = Stainless steel

Product number	Wheels										
		Wheel diameter D(mm)	Wheel width W(mm)	Mounting height H(mm)	Mounting base A × B(mm)	Mounting dimensions X × Y (X' × Y') (mm)	Hole diameter P(mm)	Eccentricity E(mm)	Turning radius R(mm)	Allowance load daN(kgf)	Wheel weight (g)
SUS-SJ-100	NR Rubber wheel with nylon wheel assembly (including B)	100	32	132	90 × 90	71 × 71 (68 × 68)	11	32	82	100(102.0)	840
	N Nylon wheel								83	100(102.0)	750
	NB Nylon wheel (including B)								83	100(102.0)	860
	GU Urethane wheel with nylon wheel assembly (including B)								82	100(102.0)	790
SUS-SJ-125	GU Urethane wheel with nylon wheel assembly (including B)	125	32	168	102 × 102	80 × 80 (75 × 75)	11	32	95	120(122.4)	1020

Wheel in use

Refer to P162 for detailed specifications.



NR

Rubber wheel with nylon wheel assembly (including B)



N

Nylon wheel



NB

Nylon wheel (including B)



GU

Urethane wheel with nylon wheel assembly (including B)