

The number next to the logo mark indicates items in stock for each brand.



Stock 38,650 Items

Eye Plate "Pad Eye"



TPD-6

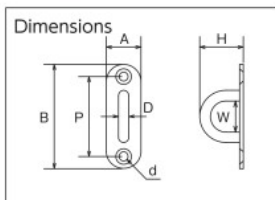

- Features
- Possible to install even on a narrow installation surface.
 - Please use the countersunk head screw.
- Use
- For attaching to a pole or wall.
- Materials
- **Stainless Steel (SUS304)**
- Origin
- China

Order Unit: 1 Bag

(Price revision date: Jan, 2017) TRUSCO NAKAYAMA CORPORATION

Order Code	Item No.	Price (per bag)	MSRP (per bag)	D (mm)	A (mm)	B (mm)	P (mm)	H (mm)	W (mm)	d (mm)	Working Load (kN)	Q'ty Per Bag (piece)	SPQ (bag)	Weight (g/bag)
275-1933	TPD-3	¥ 573	¥ 620	3	9	27	22.0	11.8	9.5	2.2	0.03	2	20	8
275-1941	TPD-4	¥ 676	¥ 730	4	12	36	28.5	15.8	12.5	3.2	0.07	2	20	16
275-1950	TPD-5	¥ 917	¥ 990	5	15	45	35.0	19.5	14.0	4.2	0.15	2	20	30
275-1968	TPD-6	¥ 1,111	¥ 1,200	6	20	60	46.0	25.0	18.0	5.2	0.20	2	20	54
275-1976	TPD-8	¥ 897	¥ 970	8	26	80	60.0	32.0	23.0	5.2	0.29	1	20	67
275-1984	TPD-9	¥ 1,185	¥ 1,280	9	32	100	73.0	38.0	25.0	6.2	0.59	1	10	104

Contact us: 0120-509-849 <http://www.orange-book.com/>



Stock 38,650 Items

Eye Plate "Pad Eye Long"



TPD-5H

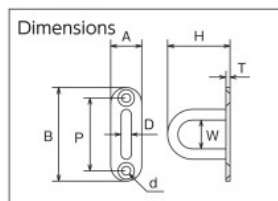

- Features
- Possible to install even on a narrow installation surface.
 - Please use the countersunk head screw.
 - Since the H dimension is large, it has a shape to hang things easily.
- Use
- For attaching to a pole or wall.
- Materials
- **Stainless Steel (SUS304)**
- Origin
- China

Order Unit: 1 Piece

(Price revision date: Jan, 2017) TRUSCO NAKAYAMA CORPORATION

Order Code	Item No.	Price (per piece)	MSRP (per piece)	D (mm)	A (mm)	B (mm)	P (mm)	H (mm)	W (mm)	d (mm)	T (mm)	Working Load (kN)	SPQ (piece)	Weight (g)
409-9150	TPD-5H	¥ 602	¥ 650	5	15	45	35	30	14	4.2	2	0.15	20	18
409-9168	TPD-6H	¥ 723	¥ 780	6	20	60	46	48	18	5.2	2	0.20	20	38

Contact us: 0120-509-849 <http://www.orange-book.com/>



Stock 529 Items

Long Eye



B-578

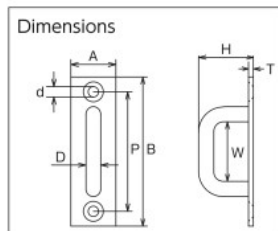

- Features
- A shape that a wide belt-like item can be easily put through.
- Use
- For attaching to a pole or wall.
- Materials
- **Stainless Steel (SUS304)**
- Origin
- Taiwan

Order Unit: 1 Piece

(Price revision date: Jan, 2016) MIZUMOTO MACHINE MFG.Co.Ltd

Order Code	Item No.	Price (per piece)	MSRP (per piece)	D (mm)	A (mm)	B (mm)	P (mm)	H (mm)	T (mm)	W (mm)	d (mm)	Working Load (kN)	SPQ (piece)	Weight (g)
361-0918	B-1892	¥ 390	¥ 460	4	12	36	28.0	16	2	12	3.2	0.07	20	8
361-0926	B-575	¥ 561	¥ 660	5	15	45	35.0	20	2	14	3.6	0.15	20	16
361-0934	B-576	¥ 679	¥ 800	6	18	60	48.0	22	2	24	4.2	0.20	20	28
361-0942	B-577	¥ 900	¥ 1,060	7	21	70	56.5	23	2	28	4.2	0.25	20	40
361-0951	B-578	¥ 1,086	¥ 1,280	8	24	80	65.0	25	3	34	5.2	0.29	20	68
379-0321	B-579	¥ 1,426	¥ 1,680	9	27	100	83.0	27	3	48	6.0	0.59	10	101
378-9012	B-1893	¥ 1,749	¥ 2,060	10	30	120	100.0	31	4	60	6.2	0.98	10	170

Contact us: 079-246-2501 <http://www.mizumoto-mm.co.jp/>



Stock 38,650 Items

T Type Eye



TET-2

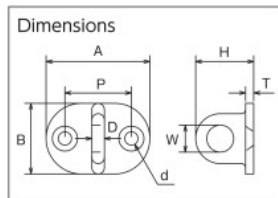

- Features
- The hanging part is a plate shape type.
 - Please use the countersunk head screw.
- Use
- For attaching to a pole or wall.
- Materials
- **Stainless Steel (SUS304)**
- Origin
- China

Order Unit: 1 Piece

(Price revision date: Jan, 2017) TRUSCO NAKAYAMA CORPORATION

Order Code	Item No.	Price (per piece)	MSRP (per piece)	D (mm)	A (mm)	P (mm)	B (mm)	H (mm)	W (mm)	d (mm)	T (mm)	Working Load (kN)	SPQ (piece)	Weight (g)
409-9176	TET-1	¥ 537	¥ 580	3.0	25	16	17	14.0	6.5	3.2	2	0.07	20	7
409-9184	TET-2	¥ 731	¥ 790	4.5	37	24	26	20.5	10.0	4.2	3	0.15	20	24
409-9192	TET-3	¥ 990	¥ 1,070	4.5	37	24	30	30.0	14.0	4.2	3	0.15	20	37

Contact us: 0120-509-849 <http://www.orange-book.com/>