

Prices displayed include 8% tax.

TRUSCO Stock 38,650 Items **Ring Pull**

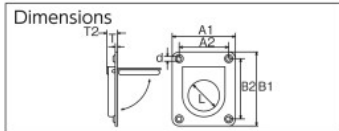

TLP-2



- Features**
- Since it is a built-in type, there are no protrusions on the attached surface.
 - Since the ring part can be pulled up when using and stored in a built-in part when not in use, it does not get in the way.
- Use**
- For a puller by attaching on a wall, a floor, or an inspection port.
 - For a deck, a hatch, a panel of ships, etc.
- Materials**
- **Stainless Steel (SUS304)**
- Origin**
- China

Example



Order Unit: 1 Piece

TRUSCO NAKAYAMA CORPORATION

Order Code	Item No.	Price (per piece)	MSRP (per piece)	A1 (mm)	A2 (mm)	B1 (mm)	B2 (mm)	L (mm)	T (mm)	T2 (mm)	d (mm)	Working Load (kN)	SPQ (piece)	Weight (g)
300-8592	TLP-1	¥648	¥700	44	32	57	45	20.5	1	8.5	3.5	0.05	20	31
300-8606	TLP-2	¥833	¥900	56	43	66	52	27.5	1	9.5	4.0	0.10	20	47

Contact us: 0120-509-849 <http://www.orange-book.com/>

NISSA CHAIN Stock 321 Items **Steel Base&D-ring**



P-10140

- Features**
- It is used as a washer by fastening with screws.
 - For hanging bracket.
 - For washer of chains or ropes.
- Materials**
- **Ring part: Steel (SVRM)**
 - **Screw fastening part: Steel (SPCC)**
 - **Surface Treatment: Nickel Plate Finishing**
- Origin**
- Japan

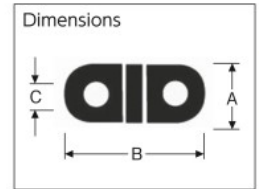

NISSA CHAIN Co.Ltd

Order Unit: 1 Bag

Order Code	Item No.	Price (per bag)	MSRP (per bag)	A (mm)	B (mm)	C (mm)	Working Load (kN)	Qty Per Bag (piece)	SPQ (bag)	Weight (g/bag)
825-5894	P-10142	¥216	¥200	12.3	33.2	5.0	0.06	3	5	10
825-5893	P-10141	¥270	¥250	14.0	39.1	4.2	0.09	3	5	25
825-5892	P-10140	¥270	¥250	20.3	51.5	4.3	0.09	2	5	33

Contact us: 06-6722-8221 <http://www.nissa.co.jp/>

MIZUMOTO MACHINE Stock 529 Items **Round Ring Plate**



B-2189

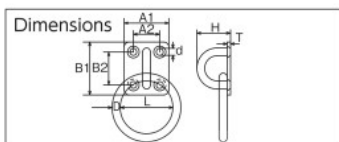

- Features**
- Since it has a round hook, it is easy to pass thick ropes and the like.
 - Set up on the wall, floor, pillar, etc., as a terminal metal fitting for the chain, wire, and rope.
- Materials**
- **Stainless Steel (SUS304)**
- Origin**
- China

Order Unit: 1 Piece

MIZUMOTO MACHINE MFG.Co.Ltd

Order Code	Item No.	Price (per piece)	MSRP (per piece)	D (mm)	L (mm)	A1 (mm)	A2 (mm)	B1 (mm)	B2 (mm)	H (mm)	d (mm)	T (mm)	Working Load (kN)	SPQ (piece)	Weight (g)
378-9608	B-2189	¥ 611	¥ 720	4	30	25	16	28	18	16.0	3.0	2.0	0.07	20	23
379-0657	B-772	¥ 2,783	¥ 3,280	9	50	42	27	58	43	37.0	5.2	4.0	0.59	10	202
379-0665	B-773	¥ 4,990	¥ 5,880	12	60	54	35	75	56	47.8	5.8	4.8	1.18	10	430

Contact us: 079-246-2501 <http://www.mizumoto-mm.co.jp/>

MIZUMOTO MACHINE Stock 529 Items **Pad Eye with Ring**



B-525

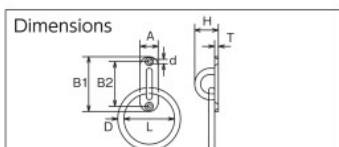

- Features**
- Possible to install even on a narrow installation surface.
 - Please use the countersunk head screw.
 - Since it has a round hook, it is easy to pass thick ropes and the like.
 - Set up on the wall, floor, pillar, etc., as a terminal metal fitting for the chain, wire, and rope.
- Materials**
- **Stainless Steel (SUS304)**
- Origin**
- China

Order Unit: 1 Piece

(Price revision date: Jan, 2016) MIZUMOTO MACHINE MFG.Co.Ltd

Order Code	Item No.	Price (per piece)	MSRP (per piece)	D (mm)	L (mm)	A (mm)	B1 (mm)	B2 (mm)	H (mm)	d (mm)	T (mm)	Working Load (kN)	SPQ (piece)	Weight (g)
379-0193	B-525	¥ 577	¥ 680	3	25	9	27	22.0	11.8	2.2	1.8	0.03	20	9
379-0207	B-526	¥ 662	¥ 780	4	30	12	36	28.5	15.8	3.2	1.8	0.07	20	19
378-7991	B-070	¥ 892	¥ 1,050	5	30	15	45	35.0	19.5	4.2	2.0	0.15	20	31
378-8008	B-071	¥ 1,086	¥ 1,280	6	40	20	60	46.0	26.0	5.2	2.0	0.20	20	60
378-8016	B-072	¥ 1,595	¥ 1,880	8	50	26	80	60.0	32.0	5.2	3.0	0.29	10	142
378-8024	B-073	¥ 2,359	¥ 2,780	9	60	32	100	73.0	38.0	6.2	3.0	0.59	10	211

Contact us: 079-246-2501 <http://www.mizumoto-mm.co.jp/>