

For machine parts hinges, see p. 2-330 to 340

The number next to the logo mark indicates items in stock for each brand.



Stock 38,650 Items

Laterally Long Hinge



415-32N (fabric finishing)



415-32UNCR (trivalent chrome plated finishing)

Dimensions Table (Unit: mm)

Total Length	P1	P2	Wood Screw Size (D x L)
32	29	19	3.1 x 20
38	31	24	3.5 x 22
51	45	34	3.8 x 25

Specs • Mounting Method: Wood Screws (sold separately)
 Materials • Steel (SPCC)
 Origin • Japan

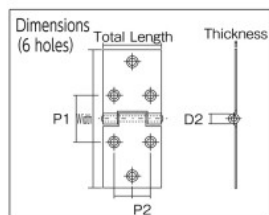

Fabric Finishing Specs • Surface Treatment: Fabric Finishing

Order Unit: 1 Bag

Order Code	Item No.	Price (per bag)	MSRP (per bag)	Total Length (mm)	Width (mm)	Thickness (mm)	D2 (mm)	Threaded Hole Number	Hole Diameter (mm)	Load Capacity (kg) when 2 pieces used	Q'ty Per Bag (piece)	Weight (g/bag)
233-6138	415-32N	¥306	¥330	32	82	1.5	6.6	6	4.5	6	4	140
233-6146	415-38N	¥334	¥360	38	91	1.5	7.2	6	4.8	8	4	188
233-6154	415-51N	¥546	¥590	51	115	1.7	8.7	6	5.0	10	4	376

Trivalent Chrome Plated Finishing Specs • Surface Treatment: Trivalent Chrome Plated Finishing

Order Unit: 1 Bag

Order Code	Item No.	Price (per bag)	MSRP (per bag)	Total Length (mm)	Width (mm)	Thickness (mm)	D2 (mm)	Threaded Hole Number	Hole Diameter (mm)	Load Capacity (kg) when 2 pieces used	Q'ty Per Bag (piece)	Weight (g/bag)
233-6235	415-32UNCR	¥361	¥390	32	82	1.5	6.6	6	4.5	6	4	140
233-6243	415-38UNCR	¥407	¥440	38	91	1.5	7.2	6	4.8	8	4	188
233-6251	415-51UNCR	¥666	¥720	51	115	1.7	8.7	6	5.0	10	4	376

Contact us: 0120-509-849 <http://www.orange-book.com/>



Stock 38,650 Items

Thin Flat Bullet Type Hinge



666NR-102SV (silver painting)

Dimensions Table (Unit: mm)

Total Length	P1	P2	P3	Wood Screw Size (D x L)
89	55	71	35.5	3.8 x 25
102	72	82	27.0	4.1 x 25
127	105	106	26.5	4.5 x 25

Specs • Surface Treatment: Silver Coated Finishing
 • With Nylon Ring
 • Mounting Method: Wood Screws (accessory)
 Materials • Steel (SPCC)
 Origin • Japan

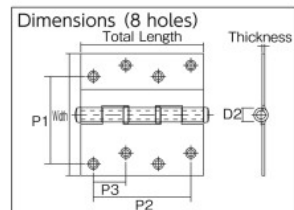

Order Unit: 1 Bag

Order Code	Item No.	Price (per bag)	MSRP (per bag)	Total Length (mm)	Width (mm)	Thickness (mm)	D2 (mm)	Threaded Hole Number	Hole Diameter (mm)	Number of Wood Screws	Load Capacity (kg) when 2 pieces used	Q'ty Per Bag (piece)	Weight (g/bag)
233-6049	666NR-89SV	¥741	¥800	89	89	1.8	10.0	6	5.4	12	25	2	294
233-6057	666NR-102SV	¥926	¥1,000	102	102	2.0	12.0	8	5.6	16	33	2	442
233-6065	666NR-127SV	¥1,342	¥1,450	127	127	2.7	14.4	10	6.2	20	45	2	898

Contact us: 0120-509-849 <http://www.orange-book.com/>



About the type of hinge

Long Hinge

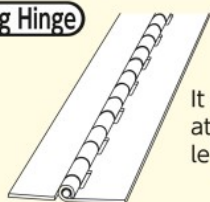

It can be cut at necessary length.

Spring Hinge

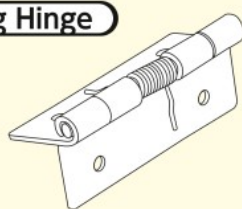

Torque Hinge

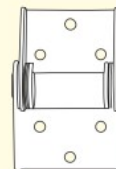

It can retain at any angle. Free stop specification. For mounting a monitoring camera, etc.

Removable Pin Hinge

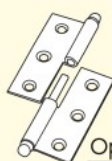

It is a type that assembly on site is easy. There are types for right and for left. Opening 180°

Double Acting Spring Hinge (double opening)

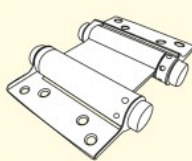

It has a type that can open a door to either inside or outside. A spring is built in that can keep a door in the closed state at anytime.

Clean Hinge

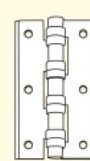

A resin cap is attached on the sliding part and there is no friction between metals, metal powder isn't scattered.

Flag Hinge

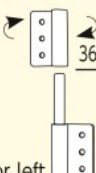

It rotates 360° and can be used for gates, etc. There are types for right or left when facing from the front. For left Fixed

Release Hinge

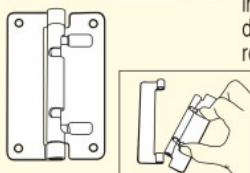

Since it can pull a sleeve inside with one hand, a door can be installed/removed easily.

Auto-Hinge



Two types of springs of strong and weak allow smooth door opening/closing.

Welded Hinge



It is a type that is mounted to a iron door, etc. using welding, not with screws.