

CoroCut® MB solid-carbide head for pre-parting

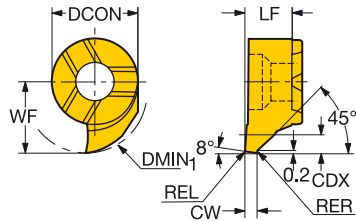
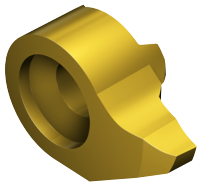

CZC _{MS}	CW	RER	REL	CDX	DMIN ₁	OHX	Ordering code	P	M	N	S	Dimensions, mm, inch		
								1025	1025	1025	1025	DCON	LF	WF
07	1.00	0.00	0.00	0.7	10	3.9	MB-07GX100-00-10R/L	☆	☆	☆	☆	7.0	3.9	5.8
	.039	.000	.000	.027	.393	.154						.276	.154	.228

CZC MS to correspond with CZC WS on holder

R = Right hand, L = Left hand

Tolerances:

	CWTOLL	CWTOLU	CWTOLL"	CWTOLU"	RETOLL	RETOLU	RETOLL"	RETOLU"
MB..GX	0.00	0.05	.0000	.0020	0.00	0.02	.0000	.0008

