

2NY-SM2 Series

3 position type

OFL-2NY-SM2 type series is OFF⇒ON⇒OFF for the risk aversion based on ergonomics. 3 position (three-step type) foot switch.

Features

- It is excellent in the credibility.
- It can use by drip-proof•oiltight structure in the place of bad environment.
- Change of protection cover is possible each model.
- Bytwo points of contact (2a), double safety measures are possible.
- Standard specification with the attached code 2.5m.

Pedal Positions and the Workings of the Triple (3-position) Type Foot Switch

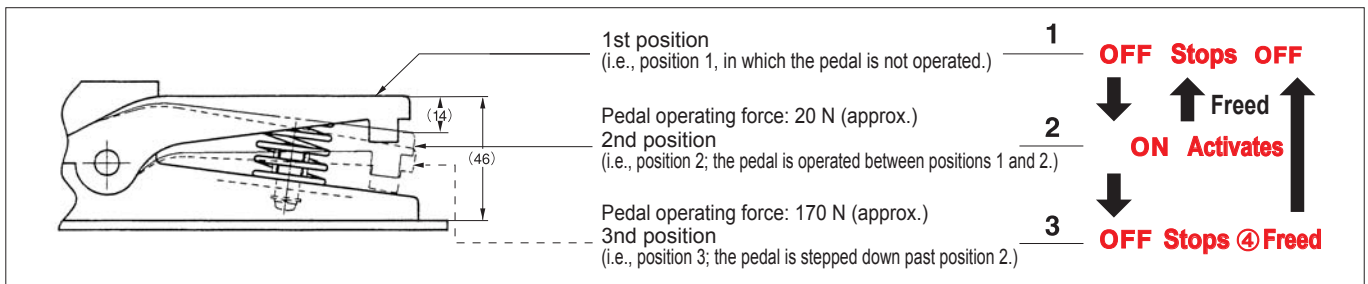

3-position Foot Switch -- Perfect Choice for Hazard Avoidance in Emergencies

SM2 (w/ basic cover)



SM2C (w/ protection cover)



SM2K (w/ shield cover)



SM2KS (w/ shield safety lid)

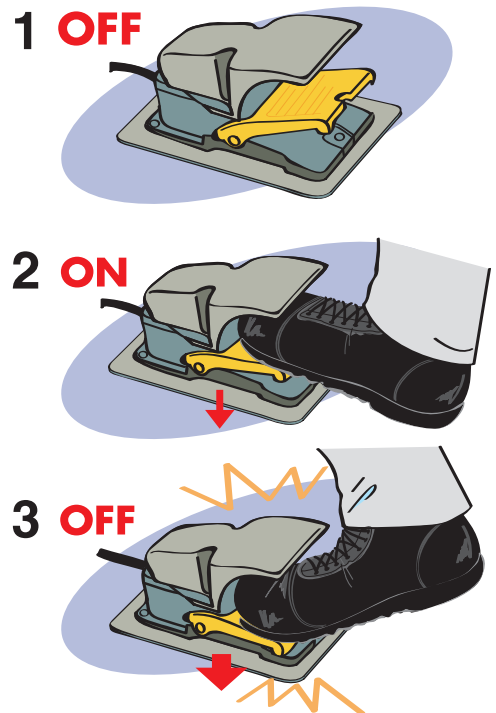

2NY-SM2 type series

Type	Weight kg (approx.)	Operating force N	Function	Rating	Switch or Contact	S-VCTF cord	IP class
OFL-2NY-SM2	2.0	①→② 20N	2a Momentary OFF⇒ON⇒OFF	Inductive load 0.7A-125VAC 0.7A- 30VDC	3-position switch (uses NO-C segment) 2 contacts	Included; outside diameter φ8.2 (0.75 mmφ 5 strands, 2.5 m).	54
OFL-2NY-SM2C	2.2						
OFL-2NY-SM2K	2.7	②→③ 170N					
OFL-2NY-SM2KS	3.1						