

SM2 Series

Standard (Cover)

SM2 Standard series is standard foot switch without pedal protection cover.

- OFL-□-SM2 Type (Center fulcrum)

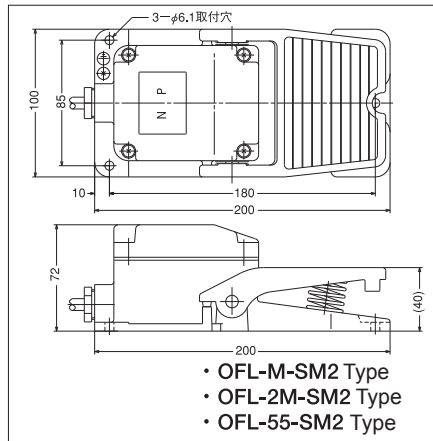

Features

- Pedal operation it is a tip of the toes or the heel step on.
- There is strength type of seal switch inclusion in protection structure IP54, too.

Twin

- OFL-TW-SM2 Type

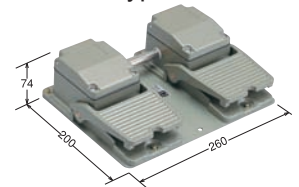

With guard

Foot switch that attached pedal protection cover to SM2 standard series.

- OFL-□-SM2C Type (Center fulcrum)

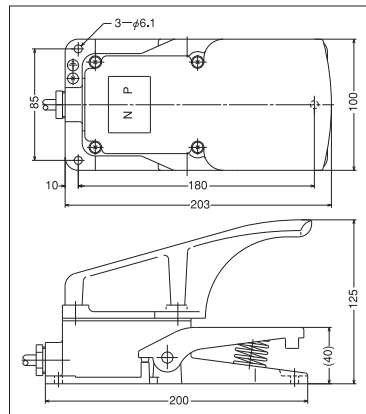

Features

- This SM2C is hit commodity that possesses an achievement of interior top of OJIDEN.

Twin Type

- OFL-TW-SM2C Type

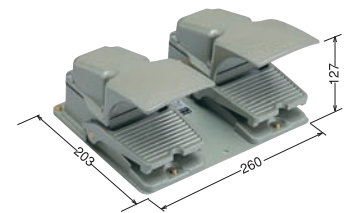

SM2 SM2C series

Type		Function		Rating	Switch	Contact	VCTF cord	Operating force N	Weight Kg		IP class
		Momentary	Alternate						SM2	SM2C	
OFL- 1 -SM2	OFL- 1 -SM2C	●	—	6A-250VAC	MICRO Switch Z	1c	1.25mm ² 3c 1.5m	31 (3.1kgf)	1.0	1.3	54
OFL- 2 -SM2	OFL- 2 -SM2C	●	—			2c	1.25mm ² 6c 1.5m		1.1	1.4	
OFL- 3 -SM2	OFL- 3 -SM2C	●	—			3c	(applicable sheath outside diameter)		1.0	1.3	
OFL- TW -SM2	OFL- TW -SM2C	●	—			1c for each side			2.5	2.8	
OFL- 2Y -SM2	OFL- 2Y -SM2C	●	—			1c for each position	1.25mm ² 6c 1.5m		1.2	1.4	
OFL- M -SM2	OFL- M -SM2C	●	—	6A-250VAC	T	1a 1b	(applicable sheath outside diameter)	25 (2.6kgf)	1.0	1.3	
OFL- 2M -SM2	OFL- 2M -SM2C	●	—			2a 2b			1.0	1.3	
◎ OFL- BS -SM2	OFL- BS -SM2C	—	●	3A-250VAC	Z <small>Lock alternate operation type</small>	1c	1.25mm ² 3c 1.5m	33 (3.4kgf)	1.0	1.3	

Low-level rating type

OFL- G -SM2	OFL- G -SM2C	●	—	0.1A-30VDC	V (gold clad contact)	1c	1.25mm ² 3c 1.5m	31 (3.1kgf)	1.0	1.3	54
OFL- 2G -SM2	OFL- 2G -SM2C	●	—	0.1A-30VDC	V (gold clad contact)	2c	1.25mm ² 6c 1.5m		1.1	1.4	

Seal structure switch inclusion type

(reinforced drip resistant type)

OFL- R -SM2	OFL- R -SM2C	●	—	0.5A-220VAC	Reed switch R (IP57)	1a	0.75mm ² 2c 2m	20 (2.0kgf)	1.0	1.2	54
OFL- 55 -SM2	OFL- 55 -SM2C	●	—	6A-250VAC	Z (IP54)	1c	1.25mm ² 3c 2.5m	33 (3.4kgf)	1.2	1.5	
OFL- VG5 -SM2	OFL- VG5 -SM2C	●	—	0.1A-30VDC	V (IP67)	1c	0.75mm ² 3c 3.5m		1.2	1.5	
OFL- 2VG5 -SM2	OFL- 2VG5 -SM2C	●	—	0.1A-30VDC	V (IP67)	2c	0.75mm ² 6c 2.5m		1.2	1.5	

If marked ◎, the type does not permit the use of the pedal safety lock lever (S4); otherwise, the lever may be used. (For necessary modification, please contact us.)
Type notation example: OFL-1-SM2CS4.