

NSK LED LIGHT SCALE LOUPE

Suitable in dimly-lit place by LED light



LSL-26

LSL-35

USE

- For precision work

MATERIAL

- Lens: Glass

FEATURES

- Reticle with full width scale, can be used to measure dimensions and diameter of objects
- With LED light to improve visibility for reading scale

ACCESSORIES

- Two reticles (One installed)
- One eyepiece cap
- One cleaning cloth

POWER

- Three LR41 (alkaline button cell) (not included)

Scale plate

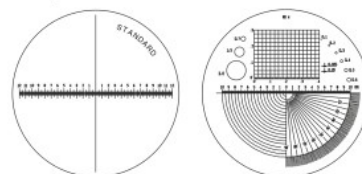

Standard (graduation: 0.1mm)

No.4

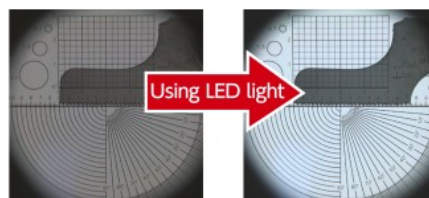

● DIMENSIONS

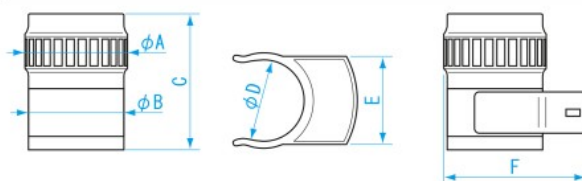

Units : mm

Model No.	φ A	φ B	C (Adjustable)	φ D	E	F
LSL-26	37.2	30.6	46.5 ~ 55.5	30	30.5	51.5
LSL-35	45	40	45 ~ 54	39.5	30.5	60

Order No.	Model No.	Magnification	Weight
140141	LSL-26	10 ×	45g
140142	LSL-35		73g

MICROSCOPE

FIBERSCOPE

MAGNIFIER

INSPECTION MIRROR

LOUPE

NSK LED LIGHT FOR LEDLIGHT SCALE LOUPE



L-26

USE

- Single light for LED Light scale loupe

FEATURES

- LED light that is included in LED light scale loupe (LSL-26, LSL-35)

POWER

- Three LR41 (alkaline button cell) (not included)

Order No.	Model No.	Weight
140143	L-26	10g
140144	L-35	11g

NSK SCALE PLATE FOR LED LIGHT SCALE LOUPE

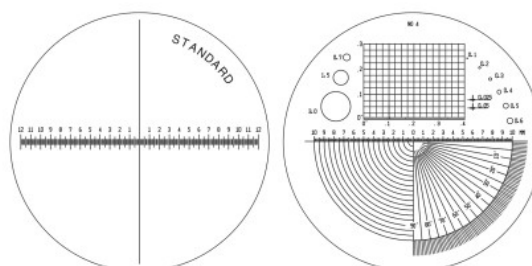

Standard (graduation: 0.1mm)

No.4

USE

- Reticle scale plate for LED light scale loupe

FEATURES

- Reticle scale plate that is included in LED light scale loupe (LSL-26, LSL-35)

Order No.	Model No.	Pattern	Applicable Model	Weight
140146	S-26-4	No.4	LSL-26	3g
140147	S-26-S	Standard		3g
140148	S-35-4	No.4	LSL-35	4g
140149	S-35-S	Standard		4g