

## DRILL TIP GAUGE

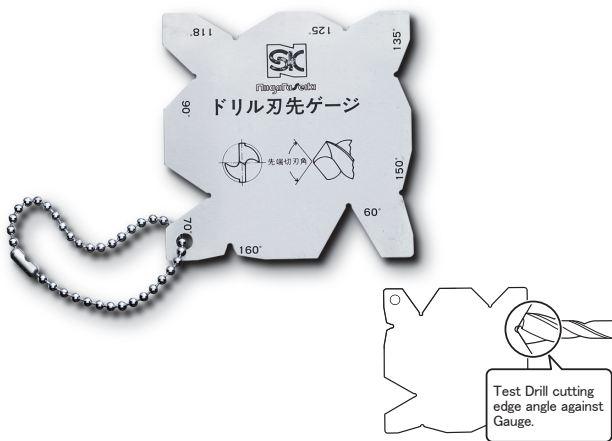

**USE** • Use for measuring drill-tip after grinding (60° 70° 90° 118° 125° 135° 150° 160°)

**MATERIAL** • Stainless steel (SUS420J2)

### FEATURES

- 8 types of edge angle gauges are useful when grinding
- 2mm scale to measure length of drill tip
- Provided with ball chain

Order No.	Model No.	Product Dimension W×H×D (mm)	Accuracy	Weight
007531	DPG-A	77×77×1	±1.5°	11g

## DRILL TIP GAUGE

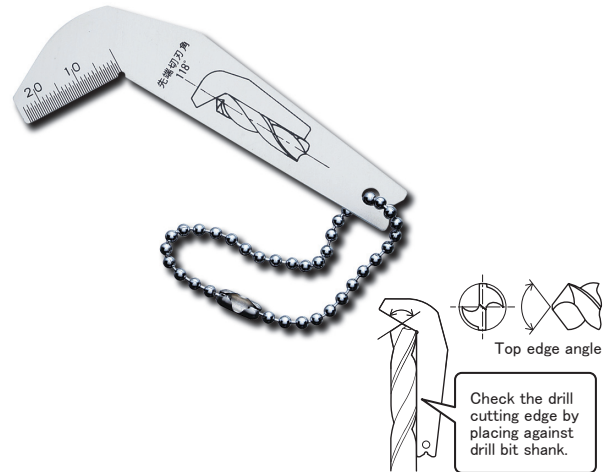

**USE** • Use for measuring drill-tip after grinding (118°)

**MATERIAL** • Stainless steel (SUS420J2)

**FEATURES** • Confirms drill tip edge angle after grinding  
• Provided with ball chain

Order No.	Model No.	Product Dimension L×D (mm)	Accuracy	Weight
007532	DPG-118	90×0.5	±1.5°	10g

## DRILL POINT GAUGE



**USE** • Use for measuring the drill edge length range of 3mm-45mm, right and left side

**MATERIAL** • Carbon tool steel

### FEATURES

- Provided with ball chain
- Rotating tip angle gauge (Marking at 60° 70° 90° 125° 135° 150°)
- Tip angle : 118°
- Drill edge length : 3 ~ 45mm

Order No.	Model No.	Product Dimension (mm)	Accuracy	Weight
007535	DP-118	Base:22×110×8 Rotor:7.5×50×2 Main Scale:68×9	±1.5°	160g

## SLIDING DRILL POINT GAUGE

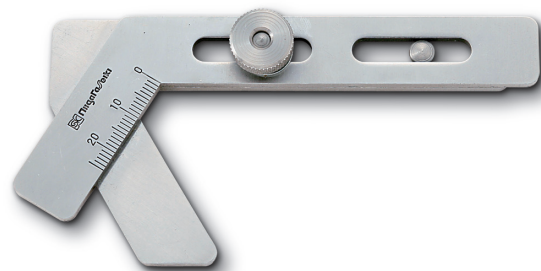

**USE** • Maintenance management of drill point angle  
• Use for measuring the drill tip edge length range of 3-40mm

### MATERIAL

- Stainless steel (SUS420J2) Satin finish

### FEATURES

- Tip angle : 118°
- Drill edge length : 3~40mm

Order No.	Model No.	Accuracy	Weight
007536	S-118	±1.5°	150g

