

Standard Type



Quick Type



Side Operation Type



Clutch Type



RoHS Compliant



No.E-659C

Q-Lock Elements/Pins (Screw Type)

Material Main body: SCM440 Steel balls: SUJ2

Heat Treatment Main body: HRC55 heat treatment
Steel balls: HRC62 heat treatment

Types and External Dimensions

Standard Type/Quick Type

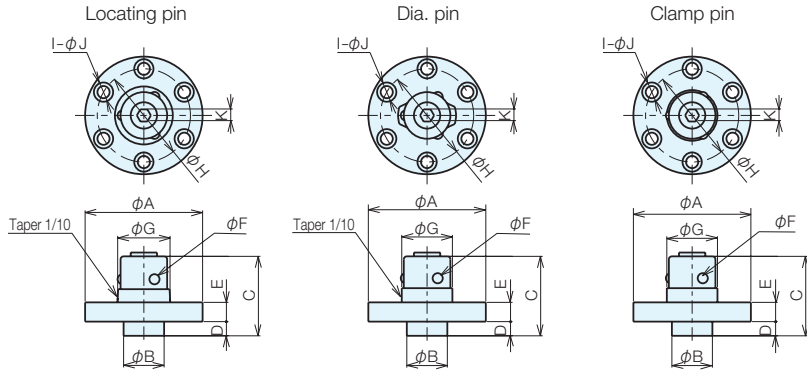
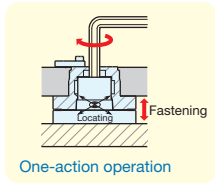

Pin (Standard Type) Specifications

Type	Order No.	No.	A	B ^{-0.003 -0.013}	C	D	E ^{±0.005}	F	G	H	I	J	K	Weight (g)
Locating pin	66261	QLT19RP	45	15	31.3	6	7	4	19	36	4	4.5	5	110
	66262	QLT26RP	58	20	39.2	7	10	5	26	46	4	6	6	260
	66263	QLT32RP	72	25	49	8.5	12	6	32	58	4	7	8	500
	67647	QLT40RP	88	28	59	9.5	15	7	40	72	6	7	10	950
Dia. pin	66258	QLT19DP	45	15	31.3	6	7	4	19	36	4	4.5	5	110
	66259	QLT26DP	58	20	39.2	7	10	5	26	46	4	6	6	260
	66260	QLT32DP	72	25	49	8.5	12	6	32	58	4	7	8	500
	67648	QLT40DP	88	28	59	9.5	15	7	40	72	6	7	10	950
Clamp pin	66255	QLT19CP	45	15	31.3	6	7	4	17.8	36	4	4.5	5	110
	66256	QLT26CP	58	20	39.2	7	10	5	25	46	4	6	6	260
	66257	QLT32CP	72	25	49	8.5	12	6	30	58	4	7	8	500
	67649	QLT40CP	88	28	59	9.5	15	7	37	72	6	7	10	950

Pin (Quick Type) Specifications

Type	Order No.	No.	A	B ^{-0.003 -0.013}	C	D	E ^{±0.005}	F	G	H	I	J	K	Weight (g)
Locating pin	91492	QLTF19RP	45	15	31.3	6	7	4	19	36	4	4.5	5	110
	91493	QLTF26RP	58	20	39.2	7	10	5	26	46	4	6	6	260
	91494	QLTF32RP	72	25	49	8.5	12.5	6	32	58	4	7	8	500
	91495	QLTF40RP	88	28	59	9.5	15	7	40	72	6	7	10	950
Dia. pin	91496	QLTF19DP	45	15	31.3	6	7	4	19	36	4	4.5	5	110
	91497	QLTF26DP	58	20	39.2	7	10	5	26	46	4	6	6	260
	91498	QLTF32DP	72	25	49	8.5	12.5	6	32	58	4	7	8	500
	91499	QLTF40DP	88	28	59	9.5	15	7	40	72	6	7	10	950
Clamp pin	91500	QLTF19CP	45	15	31.3	6	7	4	17.8	36	4	4.5	5	110
	91501	QLTF26CP	58	20	39.2	7	10	5	25	46	4	6	6	260
	91502	QLTF32CP	72	25	49	8.5	12.5	6	30	58	4	7	8	500
	91503	QLTF40CP	88	28	59	9.5	15	7	37	72	6	7	10	950

Base Elements

Clamp Units

Clamping Parts

Machine Vises

Drilling Vises

Vibration Isolation

Surface Plates and Measurement Instruments

Index