

Precision Type S-GX

- Please read "request and advice for order" in page 6 before placing an order.
- Please refer to "joint boot" in page 24 and 25.

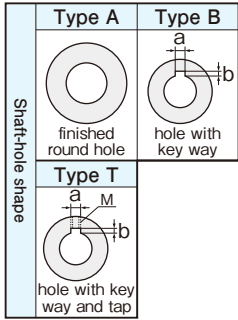

Standard Part

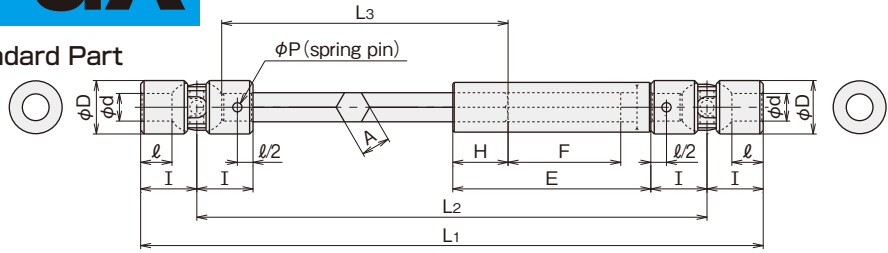

With Key Tap (S-GX TT)

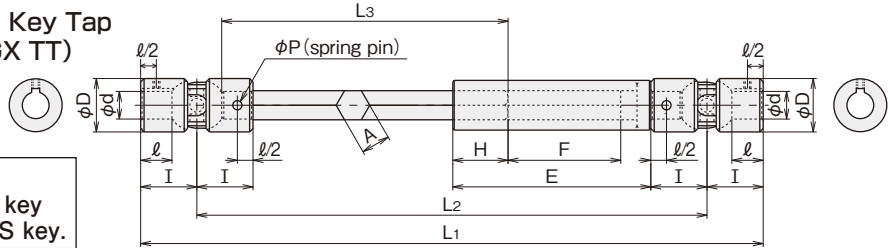

Choose new JIS key or old JIS key.

Dimension L₁ can be changed as a special order.

Type S-GX Dimension Table

standard part's attachment ●spring-pin 2 pieces

Symbol Size	φd ^{H7}	φD	I	ℓ	E	H	F Slide distance	A	Dimension of spring-pin for fixing	New JIS key		Old JIS key		TAP M	MAX			MIN
										a ^{JS9}	b	a ^{JS9}	b		L1- ⁰	L2	L3	
S- 6GX	6	16	17	9	85	15	60	6.7	2 ×16	2	1.0	2	1.0	M3	238	204	109	111
S- 8GX	8	18	20	11	85	20	55	7.7	2.5×16	3	1.4	3	1.5	M3	245	205	111	132
S-10GX	10	22	22.5	12	105	20	75	9.8	3 ×20	3	1.4	4	1.5	M4	275	230	112	144
S-12GX	12	26	25	13	108	25	70	11.7	4 ×25	4	1.8	4	1.5	M4	283	233	113	164
S-14GX	14	29	28	16	128	30	80	13.7	5 ×28	5	2.3	5	2.0	M5	360	304	166	192
S-16GX	16	32	32.5	18	128	35	75	16.7	5 ×32	5	2.3	5	2.0	M5	373	308	168	219
S-18GX	18	37	36	20	150	40	90	18.7	6 ×35	6	2.8	5	2.0	M6	404	332	170	244
S-20GX	20	42	41	23	170	40	110	20.7	6 ×40	6	2.8	5	2.0	M6	444	362	173	270
S-22GX	22	47	47.5	25	190	45	125	22.6	6 ×45	6	2.8	7	3.0	M8	535	440	225	305
S-25GX	25	52	54	29	215	50	140	25.6	8 ×50	8	3.3	7	3.0	M8	581	473	229	349
S-30GX	30	58	61	34	215	60	130	31.6	10 ×60	8	3.3	7	3.0	M8	599	477	234	397

● MAX L₁=Maximum length in which the sliding stroke F of standard part is kept. ● MIN L₁=Minimum length in which a shaft and a sleeve are cut and the engaged distance H and sliding stroke ℓ are kept.

Precision Type H-GX

- Please read "request and advice for order" in page 6 before placing an order.
- Please refer to "joint boot" in page 24 and 25.

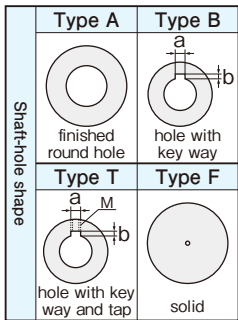

Standard Part

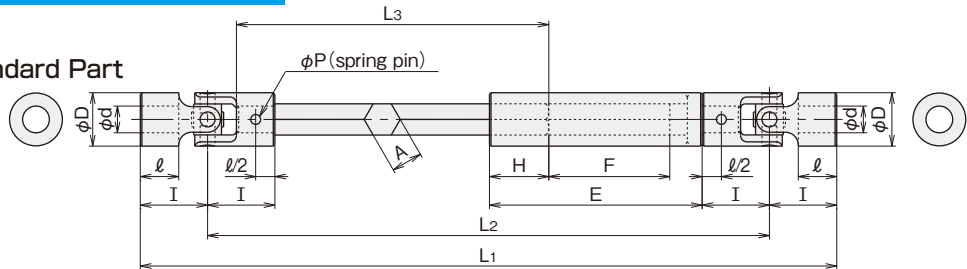

With Key Tap (H-GX TT)

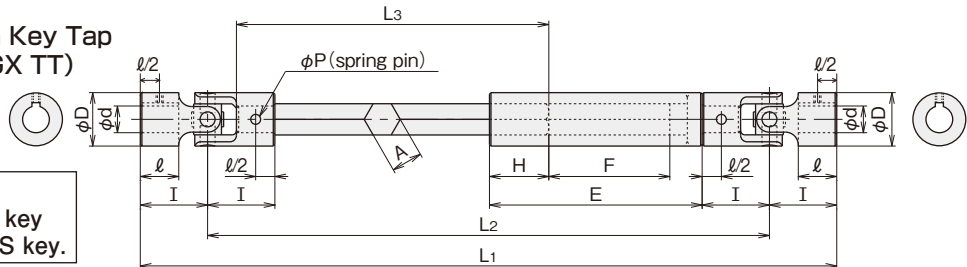

Choose new JIS key or old JIS key.

Dimension L₁ can be changed as a special order.

Type H-GX Dimension Table

standard part's attachment ●spring-pin 2 pieces

Symbol Size	φd ^{H7}	φD	I	ℓ	E	H	F Slide distance	A	Dimension of spring-pin for fixing	New JIS key		Old JIS key		TAP M	MAX			MIN
										a ^{JS9}	b	a ^{JS9}	b		L1- ⁰	L2	L3	
H- 6GX	6	12.5	20	13	85	15	60	6.7	2 ×12	2	1.0	2	1.0	M3	250	210	113	131
H- 8GX	8	16	25	16.5	85	20	55	7.7	2.5×16	3	1.4	3	1.5	M3	265	215	116.5	163
H-10GX	10	20	28	17	105	20	75	9.8	3 ×20	3	1.4	4	1.5	M4	297	241	117	176
H-12GX	12	25	35.5	22	108	25	70	11.7	4 ×25	4	1.8	4	1.5	M4	325	254	122	224
H-16GX	16	32	40	23	128	35	75	16.7	5 ×32	5	2.3	5	2.0	M5	403	323	173	259
H-20GX	20	40	50	28	170	40	110	20.7	6 ×40	6	2.8	5	2.0	M6	480	380	178	316
H-25GX	25	50	63	36	215	50	140	25.6	8 ×50	8	3.3	7	3.0	M8	617	491	236	399
H-30GX	30	57	82.5	51	215	60	130	31.6	10 ×60	8	3.3	7	3.0	M8	685	520	251	517

● MAX L₁=Maximum length in which the sliding stroke F of standard part is kept. ● MIN L₁=Minimum length in which a shaft and a sleeve are cut and the engaged distance H and sliding stroke ℓ are kept.