

● Order No. Example

NK15B 12

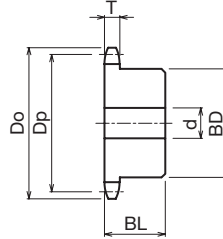
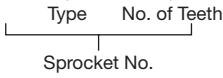

- ChainNo.15
- Chain Pitch (P)4.7625mm
- Bushing Link Inner Width(W)2.38 mm
- Bushing Outside Diameter(Dr)2.48 mm
- Tooth Width(T)2.0 mm

m Carbon Structural Steel

Type	No. of Teeth	Outer Diameter Do	Pitch Diameter Dp	Shaft Hole Diameter d			Boss Diameter		Shape	Weight g	¥	Semi-F ¥
				Prepared Hole Product	Minimum	Maximum	BD	BL				
NK15B	11	19.0	16.90	4	5	7	11	10	Ground Specification	9		
	12	20.5	18.40	4	5	8	12	10		10		
	13	22.0	19.90	4	5	9	14	10		14		
	14	23.5	21.40	6	7	10	15	12		17		
	15	25.0	22.91	6	7	12	17	12		22		
	16	26.5	24.41	8	9	12	18	12		23		
	17	28.0	25.92	8	9	14	20	14		32		
	18	29.5	27.43	8	9	14	22	14		40		
	19	31.0	28.93	8	9	15	23	14		44		
	20	32.5	30.44	8	9	15	24	14		49		
	21	34.0	31.95	8	9	17	26	14		57		
	22	35.5	33.46	8	9	17	27	14		62		
	23	37.5	34.98	8	9	17	28	14		68		
	24	39.0	36.49	8	9	20	30	16		88		
	25	40.5	38.00	8	9	20	32	16		100		
	26	42.0	39.51	10	11	22	33	16		104		
	27	43.5	41.02	10	11	25	35	16		117		
	28	45.0	42.54	10	11	25	37	16		131		
	29	46.5	44.05	10	11	25	38	16		139		
	30	48.0	45.56	10	11	25	39	16		147		
	31	49.5	47.08	10	11	25	40	18		175		
	32	51.0	48.59	10	11	25	40	18		176		
	33	52.5	50.10	10	11	25	40	18		178		
	34	54.0	51.62	10	11	25	40	18		180		
	35	55.5	53.13	10	11	25	40	18		182		



Sprocket No. and Quantity



* Since we also manufacture sizes other than those in the catalog, and machine shaft holes/keys/taps, etc., depending on your request, please contact our company's sales office for details.



Same-day shipping



* The tolerance on the prepared hole diameter d has an H10 finish.

* Please refer to P24 to P33 for the Semi-F Series <Complete Product> order method.