

MAGNETIC TOOLS FOR WELDING OPERATION

Model KM-S SIMPLE HEXAGONAL HOLDER



KM-S12

KM-S9

Holding Power		Holding Power	
Round steel	Steel plate	Round steel	Steel plate
250~400N	250~700N	100~200N	150~500N

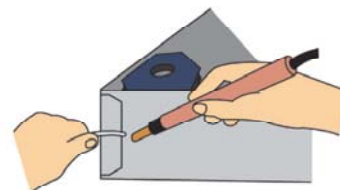
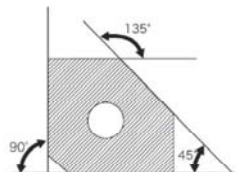
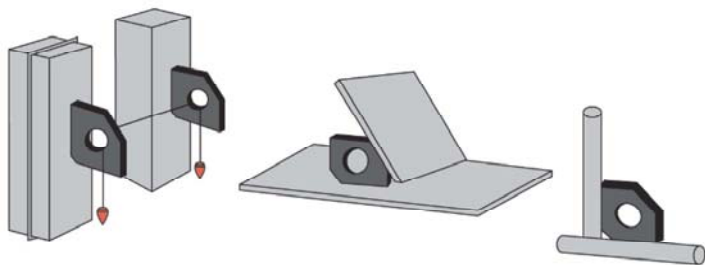

[Application]

These holders are used for tack welding and tentative assembly during welding and assembly work. They can be used in wide applications as they hold round pipes and round steel.

[Features]

- The holding angle can be set to 45°, 90° and 135°.
- Compact and handy. Lower cost and simpler than the hexagonal holder KM-S.
- The concave attractive face can hold certain round steel.

Model	Holding Power		Dimensions	Dia of round Steel	Mass
	Round Steel	Steel Plate			
KM-S9	100—200N (10—20kgf)	150—500N (15—50kgf)	90 (3.54) × 90 (3.54) × 14 (0.55)	min φ 10 (0.39)	0.5kg / 1.10 lb
	50—100N (5—10kgf)	100—300N (10—30kgf)			
KM-S12	250—400N (25—40kgf)	250—700N (25—70kgf)	120 (4.72) × 120 (4.72) × 26 (1.02)	min φ 24 (0.94)	1.2kg / 2.64 lb
	150—250N (15—25kgf)	120—500N (20—50kgf)			

※ The holding power applies to iron plate, SS400, 10mm thickness, and ground-surface.
Note : The holding power in [] is for attraction on one face in the case of double-face attraction.

Model KM-TH ANGLE CLAMP

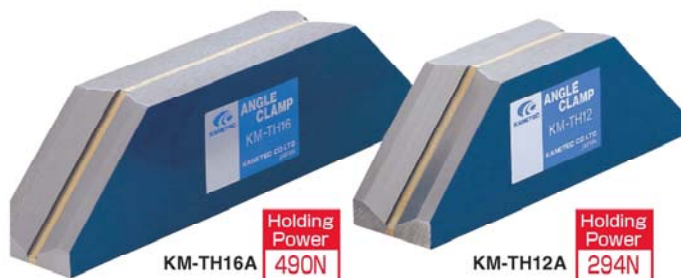

KM-TH16A

Holding Power
490N

KM-TH12A

Holding Power
294N

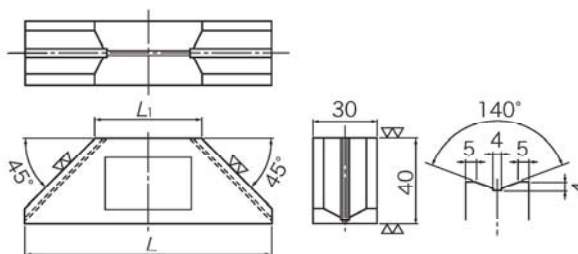

[Application]

Usable to temporarily hold workpieces during tack welding and assembly or to hold gages and rulers.

[Features]

- The all inclined sides provide strong magnetic force. Angles of 45°, 90° and 135° can be used.

Model	Holding Power	Dimensions		Mass
		L	L ₁	
KM-TH12A	294N (30kgf)	115 (4.52)	50 (1.96)	0.8kg / 1.76 lb
KM-TH16A	490N (50kgf)	155 (6.10)	90 (3.54)	1.2kg / 2.64 lb

※ The holding power applies to SS400, thickness 10mm and ground surface.

Model KM-TA ANGLE CLAMP



Holding Power
400N

KM-TA12

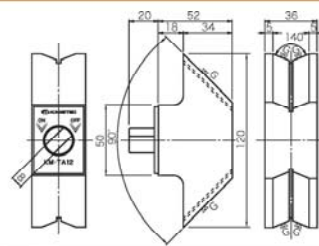

[Application]

This clamp can be used for tentative holding and tentative assembly during welding to hold workpieces strongly. It can also be used as a block.

[Features]

- The V-groove on the attractive face enables this clamp to be used for materials having curved surfaces such as round steel and pipe in addition to flat materials.
- ON-OFF switchover function provided.
- Holding angle 90° only.

Model	Holding Power	Dimensions			Mass
		Length	Width	Height	
KM-TA12	400N (40kgf)	72 (2.83)	36 (1.41)	120 (4.72)	1kg / 2.20 lb

※ The holding power applies to SS400, thickness 10mm and ground surface.

MAGNETIC TOOLS FOR WELDING OPERATION
 LIFTING MAGNET
 MAGBORER
 CHIP & SLUDGE TRANSPORTERS
 ENVIRONMENTAL EQUIPMENT
 MAGNETIZERS AND DEMAGNETIZERS
 MAGNETIC EQUIPMENT FOR TRANSPORTATION
 MAGNETIC SEPARATORS
 HIGH-GRADE MAGNETIC SEPARATORS
 MEASURING TOOLS
 MEASURING INSTRUMENTS
 MAGNETIC MATERIALS