

## Model MB-MX HIGH LOCK BASE

### Mechanical lock & fine movement adjuster

Tightening torque + clamp force + fine adjustment function, all improved!



Free style by dial adjustment



### Consistent and highly accurate measurement

#### [Application]

While these bases are used as measuring tool holders, like magnetic bases, they can also be used to hold sensors in place.

#### [Features]

- Any position can be set by tightening a knob to lock every part.
- The clamp system is adjustable steplessly. Light turn achieves it. **Quick lock mechanism.**
- A wide variety of models, small to large, are available to suit your applications.
- The dial gauge mounting part can be adjusted finely.
- The arm can be adjusted freely in angle and direction and provides stable, shake free positioning.

Optional upper fixture for sale!  
(See page 58)

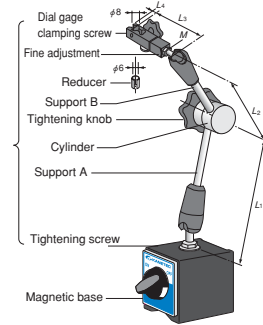
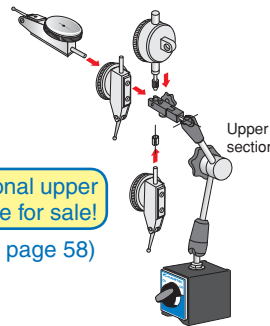

(Dial gauge mounting) (Component names/Dimensions) [mm (in)]

Model	Lock Mechanism	Holding Power	Magnetic Base			Arm					Tapped Hole	Indicator Clamp		Mass	Features
			Width	Length	Height	L <sub>1</sub>	L <sub>2</sub>	L <sub>3</sub>	L <sub>4</sub>	M		Stem Hole	Dovetail		
MB-MX13F	Mechanical Type	600N ( 60kgf)	40 (1.57)	40 (1.57)	40 (1.57)	57 (2.24)	46.5 (1.83)	61.5 (2.42)	6.5 (0.25)	M6 (0.23) × 7 (0.28)	M6 (0.23) × 1 (0.03)	φ 8 (0.31)	6.5 (0.25)	0.8kg/1.7 lb	Smallest type
MB-MX20F		800N ( 80kgf)	58 (2.28)	55	95 (3.74)	71 (2.79)	63.5 (2.50)	M6 (0.23) × 10 (0.39)		M8 (0.31) × 1.25 (0.04)	1.4kg/3.1 lb			Small type	
MB-MX28F		1000N (100kgf)	50 (1.96)	73 (2.87)	137 (5.39)	109.5 (4.31)		M6 (0.23) × 12 (0.47)	M8 (0.31) × 1.25 (0.04)	2.1kg/4.6 lb	Standard type				
MB-MX40F		197 (7.75)	170 (6.69)	M6 (0.23) × 12 (0.47)	M8 (0.31) × 1.25 (0.04)	2.2kg/4.8 lb	Long arm type								

※ The holding power applies to SS400, thickness 10 mm and ground surface.

## Model MB-X HIGH LOCK MINI BASE

### Mechanical lock type

Small and simple, suitable for use in limited space.

#### [Application]

While these bases are used as measuring tool holders like magnetic bases, they can also be used to hold sensors in place.

#### [Features]

- A mechanical lock system that tightens joints in three places by one operation.
- The arm can be adjusted freely, which facilitates locating the mounted measuring instrument.

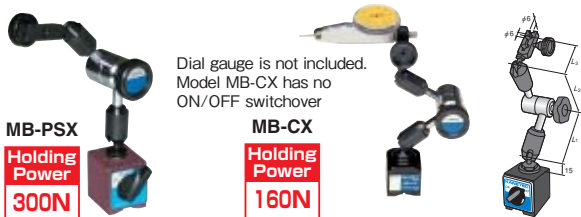

Model	Lock Mechanism	Holding Power	Magnetic Base			Arm			Tapped Hole	Indicator Clamp		Mass	Features
			Width	Length	Height	L <sub>1</sub>	L <sub>2</sub>	L <sub>3</sub>		Stem Hole	Dovetail		
MB-CX	Mechanical Type	160N (16kgf)	28 (1.10)	28 (1.10)	29 (1.14)	46 (1.81)	46 (1.81)	39 (1.53)	M5 (0.19) × 0.8 (0.03)	φ 6 (0.23) × 2	6.5 (0.25)	0.38kg/ 0.8 lb	Small, V attractive face
MB-PSX		300N (30kgf)	30 (1.18)	34 (1.33)	35 (1.37)	Small, magnet switchover							

※ The holding power applies to SS400, thickness 10 mm and ground surface.

ELECTROMAGNETIC CHUCKS  
ELECTROMAGNETIC CHUCK CONTROLLERS  
PERMANENT MAGNETIC CHUCKS  
PERMANENT MAGNETIC CHUCK CONTROLLERS  
BLOCKS FOR MC  
VACUUM CHUCKS  
PROMELTA SYSTEM  
SINE BAR CHUCKS  
MAGNETIC BLOCKS  
WORKING TOOLS  
MEASURING TOOL HOLDERS  
MAGNETIC HOLDERS  
MAGNETIC TOOLS