

# SIS-SW

# STEEL IDLE SPROCKETS

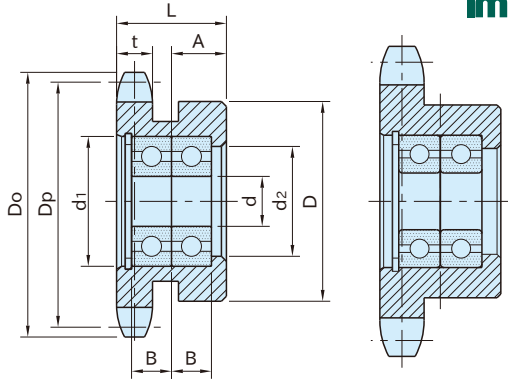

**SIS-SW** 313~512

**SIS-SW** 612,812

Sprocket	Bearing / Retaining Ring
Steel(S45C) Induction hardened(teeth top) Black oxide finish	Steel

Part Number	Chain No.	No. of Teeth	Do	Dp	d	B	D	L	t	d <sub>1</sub>
<b>SIS313SW</b>	35	13	44	39.80	10	6	32	20	4.4	22
<b>SIS412SW</b>	40	12	53	49.07		8	40	22	7.2	26
<b>SIS512SW</b>	50		68	61.34	15	11	51	25	8.9	
<b>SIS612SW</b>	60		82	73.60			32	11.9	35	
<b>SIS812SW</b>	80		108	98.14	20	14	67	40	15.0	47

Part Number	d <sub>2</sub>	A	Bearing	Weight (g)	Proper Idler Pin
<b>SIS313SW</b>	18	10	6900ZZ×2	83	PID1012
<b>SIS412SW</b>	22	11	6000ZZ×2	94	PID1016
<b>SIS512SW</b>		12.5		350	
<b>SIS612SW</b>	28	16	6202ZZ×2	554	PID1522
<b>SIS812SW</b>	39	20	6204ZZ×2	1,070	PID2028

## Features

The ball bearing is locked by a retaining ring.

## Reference

· TENSIONER ASSEMBLY EXAMPLES

## Technical Information

Allowable Bearing Radial Loads(N)<for 3,000 hours of average service life>

Bearing	Speed (min <sup>-1</sup> )					
	100	200	300	500	1000	1500
<b>6900ZZ×2</b>	1210	950	840	710	560	480
<b>6000ZZ×2</b>	2210	2200	1920	1760	1030	900
<b>6202ZZ×2</b>	3740	2960	2600	2180	1740	1520
<b>6204ZZ×2</b>	6240	4950	4330	3650	2900	2530