

KK STAINLESS STEEL PULL KNOBS

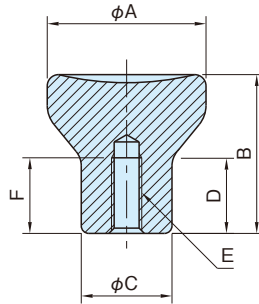

Body
Stainless steel(SUS303)
Electropolished

Part Number	A	B	C	D	E	F	Weight (g)
KK20 -SUS	21	21	12	10	M4×0.7	8	30
KK20A-SUS					M5×0.8		
KK25 -SUS	25	25	14	12	M6×1	10	49
KK32 -SUS	33	33	18	15	M8×1.25	14	113