

# EIS-S

# PLASTIC IDLE SPROCKETS

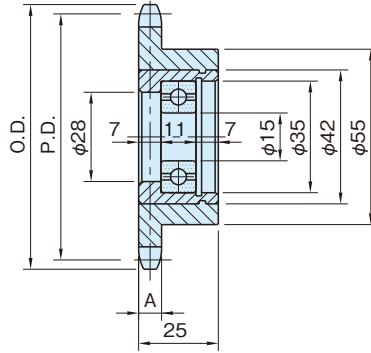

<b>Sprocket</b>	Bearing / Retaining Ring
Glass-fiber reinforced polyamide plastic Black	Steel

Part Number	Chain No.	No. of Teeth	O.D.	P.D.	A	Bearing	Weight (g)	Proper Idler Pin
<b>EIS419S</b>	40	19	83	77.16	7.2	6202ZZ	180	PID1511
<b>EIS516S</b>	50	16	88	81.37	8.7		190	
<b>EIS614S</b>	60	14	93	85.61	11.7		200	

• The ball bearing is locked by a retaining ring.

### Technical Data

Allowable Bearing Radial Loads(N)  
(for 3,000 hours of average service life)

Bearing	Speed (min <sup>-1</sup> )					
	100	200	300	500	1000	1500
<b>6202ZZ</b>	2310	1830	1610	1350	1080	940