

# ANT-S

# HORIZONTAL FIXED TIGHTENERS

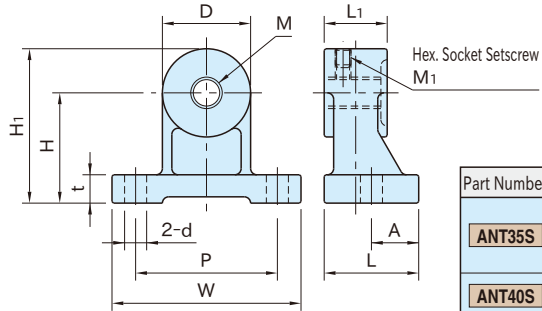

Part Number	Body
<b>ANT35S</b>	Cast iron (FCD450) Powder baking finish Black
<b>ANT40S</b>	FC250 Powder baking finish Black
<b>ANT75S</b>	FC250 Powder baking finish Black

Part Number	M	W	H	H <sub>1</sub>	t	L	d	P	A	D	L <sub>1</sub>	M <sub>1</sub>	Weight (g)
<b>ANT35S</b>	M10×1.5	60	35	49	9	30	7	45	15	28	20	M5×0.8 - 6L	230
<b>ANT40S</b>	M20×2.5	115	40	67.5	14	32	13	90	16	55	40	M8×1.25-16L	1,200
<b>ANT75S</b>			75	102.5	17	40			20				1,600