

## Z-M (成型品)

●PBTブッシュ ●PBT bushing ●PBT护线环

スペーサー  
の選定

仕 様

- ・材 質 / PBT グレード# 1403G6 ガラス繊維30%入
- ・色 / 灰白色
- ・熱変形温度 / 1.82MPa...140℃
- ・U L 規 格 / UL94V-0 (材料)
- ・RoHS対応製品



## Z0000-0000M

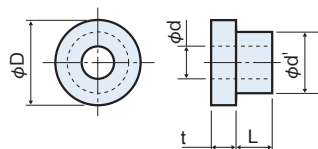

一般許容公差±0.2

| d   | d'  | D   | t   | L    | 品 番          |
|-----|-----|-----|-----|------|--------------|
| 2.1 | 2.7 | 4.0 | 0.8 | 0.8  | Z2127-4808M  |
| 2.2 | 4.1 | 5.0 | 1.2 | 1.2  | Z2241-5112M  |
| 2.5 | 3.5 | 6.0 | 5.0 | 7.2  | Z2535-6572M  |
|     |     |     |     | 11.0 | Z2535-6511M  |
| 2.6 | 5.0 | 6.6 | 1.5 | 6.0  | Z2650-6160M  |
| 2.9 | 3.5 | 6.1 | 1.4 | 1.6  | Z2935-6116M  |
|     |     |     |     | 1.9  | Z2935-6119M  |
|     |     | 6.2 | 1.0 | 1.2  | Z2935-6112M  |
|     |     |     |     | 1.2  | Z2935-6114M  |
| 3.0 | 3.4 | 5.5 | 1.0 | 0.8  | Z3034-5108M  |
| 3.0 | 3.5 | 6.0 | 1.8 | 2.3  | Z3035-6123M  |
|     |     |     | 2.0 | 2.0  | Z3035-6220M  |
|     |     |     | 3.2 | 3.0  | Z3035-6232M  |
|     |     |     |     |      | Z3035-6115M  |
|     |     | 6.1 | 1.1 | 1.5  | Z3035-6121M  |
|     |     |     | 1.4 | 3.0  | Z3035-6130M  |
|     |     | 6.2 | 1.5 | 3.0  | Z3035-62130M |
|     |     |     | 1.9 | 2.9  | Z3035-6129M  |
|     |     |     | 2.0 | 2.5  | Z3035-6225M  |
|     |     |     | 2.7 | 2.5  | Z3035-62725M |
|     |     | 6.3 | 1.2 | 2.6  | Z3035-6126M  |
|     |     | 6.4 | 1.2 | 2.0  | Z3035-6120M  |
|     |     |     | 1.3 | 2.0  | Z3035-61320M |
|     |     | 6.5 | 0.9 | 4.0  | Z3035-6940M  |
|     |     |     | 1.0 | 3.5  | Z3035-9135M  |
|     |     | 6.0 | 1.2 | 2.4  | Z3036-6124M  |
|     |     |     |     | 4.8  | Z3036-6148M  |
|     |     |     | 1.3 | 1.2  | Z3036-6112M  |
|     |     |     | 1.4 | 1.4  | Z3036-6114M  |
|     |     | 1.5 | 1.5 | 3.2  | Z3036-6115M  |
|     |     |     |     |      | Z3036-6232M  |
|     |     | 2.0 | 4.6 | 2.0  | Z3036-6246M  |
|     |     |     |     |      | Z3036-6215M  |
|     |     | 6.1 | 2.0 | 1.5  | Z3036-6129M  |
|     |     | 6.2 | 1.9 | 12.0 | Z3036-62112M |
|     |     |     |     |      | Z3036-6120M  |
|     |     | 6.4 | 1.3 | 2.0  | Z3036-6120M  |
|     |     | 3.7 | 6.0 | 1.0  | Z3037-6152M  |
|     | 5.0 | 7.0 | 2.0 | 5.8  | Z3050-7258M  |
|     |     | 7.1 | 2.0 | 2.3  | Z3050-7223M  |

| d    | d'   | D    | t   | L    | 品 番         |
|------|------|------|-----|------|-------------|
| 3.1  | 3.8  | 6.0  | 1.2 | 6.5  | Z3138-6165M |
|      |      | 8.0  | 1.2 | 1.2  | Z3138-8112M |
| 3.2  | 4.4  | 7.0  | 0.5 | 2.8  | Z3138-8128M |
|      |      |      |     | 0.8  | Z3148-7108M |
| 3.2  | 4.4  | 7.0  | 0.5 | 7.5  | Z3244-7575M |
| 3.5  | 4.3  | 10.0 | 1.0 | 3.0  | Z3543-0130M |
|      | 5.2  | 6.4  | 0.6 | 1.6  | Z3552-6616M |
| 3.9  | 4.8  | 6.4  | 3.2 | 1.6  | Z3948-6316M |
| 4.0  | 5.0  | 10.0 | 0.5 | 4.0  | Z4050-0540M |
|      |      |      | 1.0 | 4.0  | Z4050-0140M |
|      |      |      | 6.0 | 11.8 | Z4060-1519M |
| 4.1  | 6.3  | 9.5  | 1.7 | 0.8  | Z4079-1230M |
| 4.3  | 6.3  | 9.5  | 1.7 | 0.8  | Z4163-9108M |
| 4.3  | 6.7  | 12.7 | 1.5 | 1.5  | Z4367-2115M |
|      |      |      |     | 8.0  | Z4560-9280M |
|      |      |      |     | 1.2  | Z4563-9112M |
| 4.5  | 6.3  | 9.5  | 1.2 | 1.2  | Z4563-9112M |
|      |      |      |     | 9.7  | Z4597-5565M |
| 5.0  | 6.0  | 10.0 | 1.0 | 5.0  | Z5060-0150M |
| 5.1  | 6.5  | 9.5  | 1.5 | 10.7 | Z5165-9190M |
| 5.5  | 8.0  | 11.0 | 1.3 | 8.0  | Z5580-1180M |
| 6.0  | 7.5  | 14.0 | 1.2 | 1.8  | Z6075-4118M |
| 6.2  | 7.9  | 15.0 | 1.5 | 4.0  | Z6279-5140M |
| 6.5  | 8.3  | 9.9  | 1.0 | 1.5  | Z6583-9115M |
| 6.6  | 9.8  | 14.0 | 0.9 | 1.7  | Z6698-4917M |
| 8.3  | 11.0 | 25.4 | 1.6 | 2.3  | Z8311-5123M |
| 10.0 | 11.4 | 16.0 | 0.7 | 0.8  | Z1011-6708M |
| 16.2 | 17.4 | 21.0 | 0.8 | 2.8  | Z6274-1828M |

ご注文個数 50個～