



Screw fixing mounts

LKM / CL / FH with curved design for sideways fixing

In areas with limited space these mounting bases allow the cable to be offset from the fixing hole, and can be installed in the equipment prior to the cable installation. A major cost saving can be made using these products as they will allow the use of many different sizes of standard cable ties without the need to stock a wide range of specific fixing ties.

Features and benefits

- Small overall size for areas with limited mounting space
- Screwable mounts for fixing cable sideways
- Ideal for securing large, heavier bundles
- Suitable for cable ties up to 8 mm width

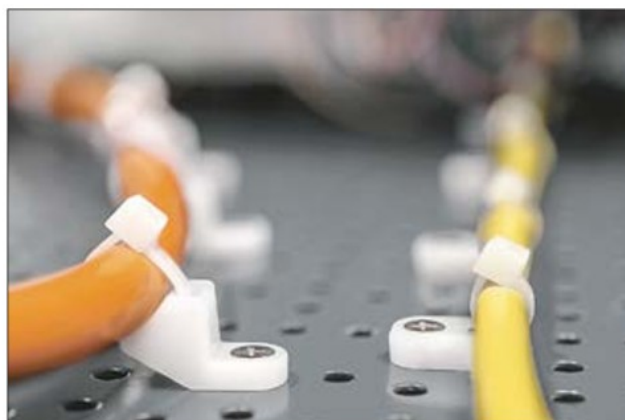

LKM, CL8 and FH cable tie mounts for applications with limited space.



Material specification
please see page 26.

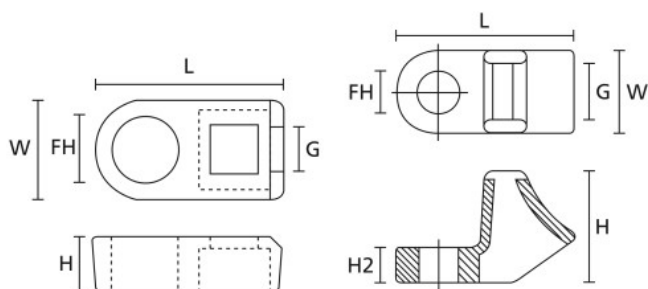

FH cable tie mounts
(plan and side view)

LKM, CL8 cable tie mounts
(plan and side view)

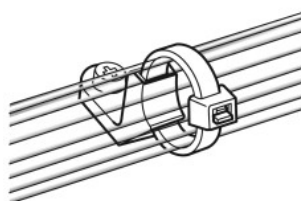

CL8 cable tie mount in application

TYPE	Width (W)	Length (L)	Height (H)	Hole Ø (FH)	Strap Width max. (G)	Height (H2)	Material	Colour	Pack Cont.	Article-No.
FH18	7.1	13.3	4.0	3.7	2.5	-	PA66	Natural (NA)	500 pcs.	151-61119
FH30	9.5	17.9	4.7	5.5	3.5	-	PA66	Natural (NA)	500 pcs.	151-61319
LKM	12.0	27.0	16.0	6.0	7.6	5.0	PA66	Black (BK)	100 pcs.	151-26301
	12.0	27.0	16.0	6.0	7.6	5.0	PA66	Natural (NA)	100 pcs.	151-26304
CL8	12.5	27.3	16.0	6.5	8.0	5.0	PA66	Natural (NA)	100 pcs.	151-02258
	12.5	27.3	16.0	6.5	8.0	5.0	PA66W	Black (BK)	100 pcs.	151-02259

All dimensions in mm. Subject to technical changes.

Minimum Order Quantity (MOQ) may differ from package content. Other packaging options may also be available.

