

Light 2-Bolt Flange Units

BLF
Cylindrical bore
(with set screws)
 d 12 ~ 35 mm

ALF
Cylindrical bore
(with eccentric locking collar)



BLF



ALF

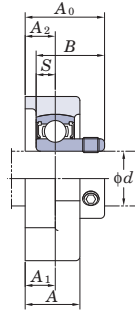

BLF

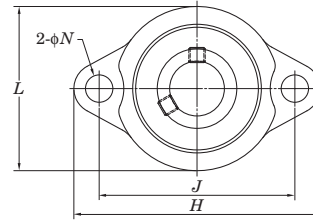

Shaft Dia.		Dimensions									Bolt Size		Unit No.	Bearing No.		
mm	inch	inch mm									inch mm					
d		H	L	A	J	N	A_1	A_2	S	BLF		ALF				
										A_0	B	A_{01}	B_1			
12	1/2	3 3/16	2 1/16	23/32	2 1/2	5/16	3/8	3/8	0.236	1	0.866	1 1/4	1.122	1/4 M6	BLF201	SB201
		81	52	18	63.5	8	9.5	9.5	6	25.5	22	32	28.5		BLF201-8	SB201-8
15	5/8	3 17/32	2 3/8	25/32	2 13/16	25/64	7/16	7/16	0.276	1 5/32	0.984	1 5/16	1.161	5/16 M8	BLF202	SB202
		90	60	20	71.5	10	11	11	7	29	25	33.5	29.5		BLF202-10	SB202-10
17	3/4	3 17/32	2 3/8	25/32	2 13/16	25/64	7/16	7/16	0.276	1 5/32	0.984	1 5/16	1.161	5/16 M8	BLF203	SB203
		90	60	20	71.5	10	11	11	7	29	25	33.5	29.5		BLF203-12	SB203-12
20	7/8	3 3/4	2 17/32	25/32	2 63/64	25/64	7/16	7/16	0.295	1 3/16	1.063	1 11/32	1.201	5/16 M8	BLF204	SB204
		95	64	20	76	10	11	11	7.5	30.5	27	34	30.5		BLF204-12	SB204-12
25	15/16	3 3/4	2 17/32	25/32	2 63/64	25/64	7/16	7/16	0.295	1 3/16	1.063	1 11/32	1.201	5/16 M8	BLF205	SB205
		95	64	20	76	10	11	11	7.5	30.5	27	34	30.5		BLF205-16	SB205-16
30	1 1/8	4 7/16	3	7/8	3 9/16	15/32	15/32	15/32	0.315	1 11/32	1.181	1 1/2	1.335	3/8 M10	BLF206	SB206
		113	76	22.5	90.5	12	12	12	8	34	30	37.9	33.9		BLF206-18	SB206-18
35	1 1/4	4 13/16	3 1/2	15/16	3 15/16	15/32	1/2	33/64	0.335	1 7/16	1.260	1 5/8	1.437	3/8 M10	BLF207	SB207
		122	89	24	100	12	13	13	8.5	36.5	32	41	36.5		BLF207-20	SB207-20
35	1 5/16	4 13/16	3 1/2	15/16	3 15/16	15/32	1/2	33/64	0.335	1 7/16	1.260	1 5/8	1.437	3/8 M10	BLF207-22	SB207-22
		122	89	24	100	12	13	13	8.5	36.5	32	41	36.5		BLF207-23	SB207-23

- Remarks
1. In Part No. of unit and units with covers, fitting codes follow bore diameter codes. (See **Table 10.5** in P.62.)
 2. Allowable load to housing in radial direction is approximately half of basic load rating of bearing, C_r (when safety factor is 4).
 3. For the dimensions and forms of applicable bearings, see the dimensional tables of ball bearing for unit.