

Square Piloted 4-Bolt Flange Units

UKFS

Tapered bore (with adapter)

d_1 20 ~ 125 mm

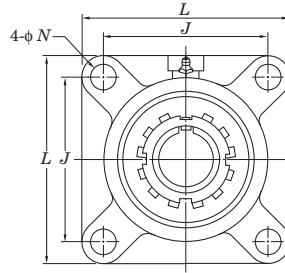
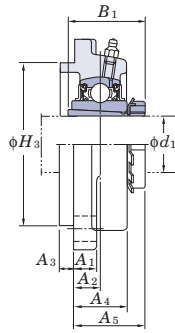

Shaft Dia. mm inch	Dimensions inch mm											Bolt Size inch mm	Standard		
	L	H_3	J	N	A_1	A_2	A_3	A_4	A_5	B_1	Unit No.		Housing No.	Bearing No.	
20 $\frac{3}{4}$	4 $\frac{11}{32}$	3.1496	3 $\frac{5}{32}$	$\frac{5}{8}$	$\frac{1}{2}$	$\frac{23}{64}$	$\frac{9}{32}$	$\frac{7}{8}$	1 $\frac{3}{16}$	1 $\frac{3}{8}$	$\frac{1}{2}$	UKFS305	FS305	UK305	
	110	80	80	16	13	9	7	22	30.5	35	M14				
25 1	4 $\frac{29}{32}$	3.5433	3 $\frac{47}{64}$	$\frac{5}{8}$	$\frac{19}{32}$	$\frac{25}{64}$	$\frac{5}{16}$	$\frac{15}{16}$	1 $\frac{5}{16}$	1 $\frac{1}{2}$	$\frac{1}{2}$	UKFS306	FS306	UK306	
	125	90	95	16	15	10	8	24	33	38	M14				
30 $1\frac{1}{8}$	5 $\frac{5}{16}$	3.9370	3 $\frac{15}{16}$	$\frac{3}{4}$	$\frac{5}{8}$	$\frac{7}{16}$	$\frac{23}{64}$	1 $\frac{1}{16}$	1 $\frac{7}{16}$	1 $\frac{11}{16}$	$\frac{5}{8}$	UKFS307	FS307	UK307	
	135	100	100	19	16	11	9	27	36.5	43	M16				
35 $1\frac{1}{4}$ $1\frac{3}{8}$	5 $\frac{29}{32}$	4.5276	4 $\frac{13}{32}$	$\frac{3}{4}$	$\frac{21}{32}$	$\frac{33}{64}$	$\frac{25}{64}$	1 $\frac{3}{16}$	1 $\frac{19}{32}$	1 $\frac{13}{16}$	$\frac{5}{8}$	UKFS308	FS308	UK308	
	150	115	112	19	17	13	10	30	40.5	46	M16				
40 $1\frac{1}{2}$	6 $\frac{5}{16}$	4.9213	4 $\frac{59}{64}$	$\frac{3}{4}$	$\frac{23}{32}$	$\frac{35}{64}$	$\frac{7}{16}$	1 $\frac{5}{16}$	1 $\frac{23}{32}$	1 $\frac{31}{32}$	$\frac{5}{8}$	UKFS309	FS309	UK309	
	160	125	125	19	18	14	11	33	44	50	M16				
45 $1\frac{3}{4}$	6 $\frac{7}{8}$	5.5118	5 $\frac{13}{64}$	$\frac{29}{32}$	$\frac{3}{4}$	$\frac{5}{8}$	$\frac{15}{32}$	1 $\frac{13}{32}$	1 $\frac{7}{8}$	2 $\frac{5}{32}$	$\frac{3}{4}$	UKFS310	FS310	UK310	
	175	140	132	23	19	16	12	36	48	55	M20				
50 $1\frac{7}{8}$ 2	7 $\frac{9}{32}$	5.9055	5 $\frac{33}{64}$	$\frac{29}{32}$	$\frac{25}{32}$	$\frac{43}{64}$	$\frac{33}{64}$	1 $\frac{17}{32}$	2	2 $\frac{5}{16}$	$\frac{3}{4}$	UKFS311	FS311	UK311	
	185	150	140	23	20	17	13	39	51	59	M20				
55 $2\frac{1}{8}$	7 $\frac{11}{16}$	6.2992	5 $\frac{29}{32}$	$\frac{29}{32}$	$\frac{7}{8}$	$\frac{3}{4}$	$\frac{35}{64}$	1 $\frac{21}{32}$	2 $\frac{3}{16}$	2 $\frac{7}{16}$	$\frac{3}{4}$	UKFS312	FS312	UK312	
	195	160	150	23	22	19	14	42	55.5	62	M20				
60 $2\frac{1}{4}$ $2\frac{3}{8}$	8 $\frac{3}{16}$	6.8898	6 $\frac{17}{32}$	$\frac{29}{32}$	$\frac{7}{8}$	$\frac{19}{32}$	$\frac{45}{64}$	1 $\frac{9}{16}$	2 $\frac{3}{32}$	2 $\frac{9}{16}$	$\frac{3}{4}$	UKFS313	FS313	UK313	
	208	175	166	23	22	15	18	40	53.5	65	M20				
65 $2\frac{1}{2}$	9 $\frac{9}{32}$	7.8740	7 $\frac{1}{4}$	$\frac{63}{64}$	$\frac{31}{32}$	$\frac{53}{64}$	$\frac{45}{64}$	1 $\frac{7}{8}$	2 $\frac{1}{2}$	2 $\frac{7}{8}$	$\frac{7}{8}$	UKFS315	FS315	UK315	
	236	200	184	25	25	21	18	48	63.5	73	M22				
70 $2\frac{3}{4}$	9 $\frac{27}{32}$	8.2677	7 $\frac{23}{32}$	$\frac{17}{32}$	1 $\frac{1}{16}$	$\frac{45}{64}$	$\frac{25}{32}$	1 $\frac{7}{8}$	2 $\frac{15}{32}$	3 $\frac{1}{16}$	1	UKFS316	FS316	UK316	
	250	210	196	31	27	18	20	48	62.5	78	M27				
75 3	10 $\frac{1}{4}$	8.6614	8 $\frac{1}{32}$	$\frac{17}{32}$	1 $\frac{1}{16}$	$\frac{15}{16}$	$\frac{29}{32}$	2 $\frac{1}{8}$	2 $\frac{27}{32}$	3 $\frac{7}{32}$	1	UKFS317	FS317	UK317	
	260	220	204	31	27	24	20	54	72	82	M27				
80 —	11 $\frac{1}{32}$	9.4488	8 $\frac{1}{2}$	1 $\frac{3}{8}$	1 $\frac{3}{16}$	$\frac{15}{16}$	$\frac{25}{32}$	2 $\frac{7}{32}$	2 $\frac{27}{32}$	3 $\frac{3}{8}$	1 $\frac{1}{8}$	UKFS318	FS318	UK318	
	280	240	216	35	30	24	20	56	72	86	M30				
85 $3\frac{1}{4}$	11 $\frac{13}{32}$	9.8425	8 $\frac{31}{32}$	1 $\frac{3}{8}$	1 $\frac{3}{16}$	1 $\frac{17}{32}$	$\frac{25}{32}$	2 $\frac{29}{32}$	2 $\frac{19}{32}$	3 $\frac{17}{32}$	1 $\frac{1}{8}$	UKFS319	FS319	UK319	
	290	250	228	35	30	39	20	74	91	90	M30				
90 $3\frac{1}{2}$	12 $\frac{7}{32}$	10.2362	9 $\frac{17}{32}$	1 $\frac{1}{2}$	1 $\frac{1}{4}$	1 $\frac{17}{32}$	$\frac{25}{32}$	2 $\frac{29}{32}$	2 $\frac{21}{32}$	3 $\frac{13}{16}$	1 $\frac{1}{4}$	UKFS320	FS320	UK320	
	310	260	242	38	32	39	20	74	93	97	M33				
100 4	13 $\frac{3}{8}$	11.8110	10 $\frac{15}{32}$	1 $\frac{39}{64}$	1 $\frac{3}{8}$	1 $\frac{3}{8}$	$\frac{63}{64}$	2 $\frac{25}{32}$	2 $\frac{3}{4}$	4 $\frac{1}{8}$	1 $\frac{3}{8}$	UKFS322	FS322	UK322	
	340	300	266	41	35	35	25	71	95	105	M36				
110 —	14 $\frac{9}{16}$	12.9921	11 $\frac{27}{64}$	1 $\frac{39}{64}$	1 $\frac{9}{16}$	1 $\frac{3}{8}$	1 $\frac{3}{16}$	3 $\frac{5}{32}$	3 $\frac{21}{32}$	4 $\frac{13}{32}$	1 $\frac{3}{8}$	UKFS324	FS324	UK324	
	370	330	290	41	40	35	30	80	100.5	112	M36				
115 $4\frac{1}{2}$	16 $\frac{5}{32}$	14.1732	12 $\frac{19}{32}$	1 $\frac{39}{64}$	1 $\frac{25}{32}$	1 $\frac{3}{8}$	1 $\frac{3}{16}$	3 $\frac{11}{32}$	4	4 $\frac{3}{4}$	1 $\frac{3}{8}$	UKFS326	FS326	UK326	
	410	360	320	41	45	35	30	85	101.5	121	M36				
125 —	17 $\frac{23}{32}$	15.7480	13 $\frac{25}{32}$	1 $\frac{39}{64}$	2 $\frac{5}{32}$	1 $\frac{49}{64}$	1 $\frac{3}{16}$	3 $\frac{3}{4}$	4 $\frac{5}{8}$	5 $\frac{5}{32}$	1 $\frac{3}{8}$	UKFS328	FS328	UK328	
	450	400	350	41	55	45	30	95	117.5	131	M36				

Remarks 1. In Part No. of unit and units with covers, fitting codes follow bore diameter numbers. (See Table 10.5 in P.62.)
 2. Part No. of applicable grease fittings are shown below.
 A-1/4-28UNF 305~308
 A-R1/8 309~328