

UP
Cylindrical bore (with set screws)
d 10 ~ 30 mm

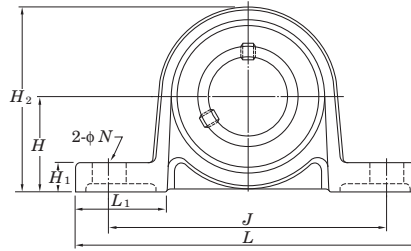
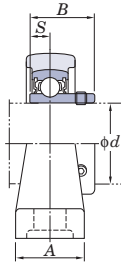

Shaft Dia. mm <i>d</i>	Dimensions inch mm										Bolt Size inch mm	Standard		
	<i>H</i>	<i>L</i>	<i>A</i>	<i>J</i>	<i>N</i>	<i>H</i> ₁	<i>H</i> ₂	<i>L</i> ₁	<i>B</i>	<i>S</i>		Unit No.	Housing No.	Bearing No.
10	45/64	2 5/8	5/8	2 3/32	9/32	1/4	1 3/8	23/32	0.591	0.197	1/4	UP000	P000	SU000
	18	67	16	53	7	6	35	18	15	5	M6			
12	3/4	2 25/32	5/8	2 13/64	9/32	1/4	1 1/2	3/4	0.591	0.197	1/4	UP001	P001	SU001
	19	71	16	56	7	6	38	19	15	5	M6			
15	55/64	3 5/32	5/8	2 31/64	9/32	9/32	1 11/16	13/16	0.650	0.217	1/4	UP002	P002	SU002
	22	80	16	63	7	7	43	21	16.5	5.5	M6			
17	15/16	3 11/32	23/32	2 41/64	9/32	9/32	1 27/32	13/16	0.689	0.236	1/4	UP003	P003	SU003
	24	85	18	67	7	7	47	21	17.5	6	M6			
20	1 7/64	3 15/16	25/32	3 5/32	13/32	11/32	2 5/32	31/32	0.827	0.276	5/16	UP004	P004	SU004
	28	100	20	80	10	9	55	25	21	7	M8			
25	1 17/64	4 13/32	25/32	3 35/64	13/32	13/32	2 7/16	1 3/32	0.866	0.276	5/16	UP005	P005	SU005
	32	112	20	90	10	10	62	28	22	7	M8			
30	1 27/64	5 3/16	1 1/32	4 11/64	1/2	7/16	2 3/4	1 11/32	0.965	0.295	3/8	UP006	P006	SU006
	36	132	26	106	13	11	70	34	24.5	7.5	M10			

Remarks 1. In Part No. of unit and units with covers, fitting codes follow bore diameter codes. (See **Table 10.5** in P.62.)
 2. For the dimensions and forms of applicable bearings, see the dimensional tables of ball bearing for unit.