

# 15MPa B型銅管くい込継手 (150kgf/cm<sup>2</sup>)

## GC型

# MALE CONNECTOR

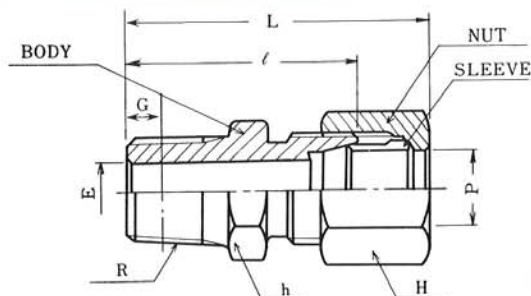

(注) L寸法はナットを締付け前の概略寸法を示す。

L denotes the rough dimensions before tightening the nuts.

単位：mm

継手の呼称 Designation of joints	各部の記号 Symbols of respective parts	適用する管の外径 Tube(O.D) P	Minimum Opening E	基準径の位置 Position reference diameter G	六角対辺 Opposite sides of hexagon		ℓ	(約) Approx.	(PT)	1組分 Wt Weight per set (kg)
					h	H		L	R	
GC- 4-R <sup>1</sup> / <sub>8</sub> -B	4-R <sup>1</sup> / <sub>8</sub> -B	4	2.5	3.97	12	12	22	30	1/8	0.019
GC- 6-R <sup>1</sup> / <sub>8</sub> -B	6-R <sup>1</sup> / <sub>8</sub> -B	6	4	3.97	14	14	28	38	1/8	0.031
GC- 6-R <sup>1</sup> / <sub>4</sub> -B	6-R <sup>1</sup> / <sub>4</sub> -B	6	4	6.01	14	14	32	42	1/4	0.040
GC- 6-R <sup>3</sup> / <sub>8</sub> -B	6-R <sup>3</sup> / <sub>8</sub> -B	6	4	6.35	19	14	34	44	3/8	0.057
GC- 6-R <sup>1</sup> / <sub>2</sub> -B	6-R <sup>1</sup> / <sub>2</sub> -B	6	4	8.16	23	14	39	49	1/2	0.095
GC- 8-R <sup>1</sup> / <sub>8</sub> -B	8-R <sup>1</sup> / <sub>8</sub> -B	8	4	3.97	17	17	29	38.5	1/8	0.046
GC- 8-R <sup>1</sup> / <sub>4</sub> -B	8-R <sup>1</sup> / <sub>4</sub> -B	8	6	6.01	17	17	33	43	1/4	0.049
GC- 8-R <sup>3</sup> / <sub>8</sub> -B	8-R <sup>3</sup> / <sub>8</sub> -B	8	6	6.35	19	17	34	44	3/8	0.064
GC- 8-R <sup>1</sup> / <sub>2</sub> -B	8-R <sup>1</sup> / <sub>2</sub> -B	8	6	8.16	23	17	39	49	1/2	0.099
GC- 10-R <sup>1</sup> / <sub>8</sub> -B	10-R <sup>1</sup> / <sub>8</sub> -B	10	4	3.97	17	19	29	39.5	1/8	0.050
GC- 10-R <sup>1</sup> / <sub>4</sub> -B	10-R <sup>1</sup> / <sub>4</sub> -B	10	6	6.01	17	19	33	43.5	1/4	0.057
GC- 10-R <sup>3</sup> / <sub>8</sub> -B	10-R <sup>3</sup> / <sub>8</sub> -B	10	8	6.35	19	19	34	44.5	3/8	0.066
GC- 10-R <sup>1</sup> / <sub>2</sub> -B	10-R <sup>1</sup> / <sub>2</sub> -B	10	8	8.16	23	19	39	49.5	1/2	0.100
GC- 12-R <sup>1</sup> / <sub>4</sub> -B	12-R <sup>1</sup> / <sub>4</sub> -B	12	6	6.01	19	21	33	43.5	1/4	0.068
GC- 12-R <sup>3</sup> / <sub>8</sub> -B	12-R <sup>3</sup> / <sub>8</sub> -B	12	8.5	6.35	19	21	34	44.5	3/8	0.073
GC- 12-R <sup>1</sup> / <sub>2</sub> -B	12-R <sup>1</sup> / <sub>2</sub> -B	12	10	8.16	23	21	39	50.5	1/2	0.105
GC- 14-R <sup>3</sup> / <sub>8</sub> -B	14-R <sup>3</sup> / <sub>8</sub> -B	14	8.5	6.35	23	26	37	49	3/8	0.117
GC- 14-R <sup>1</sup> / <sub>2</sub> -B	14-R <sup>1</sup> / <sub>2</sub> -B	14	11	8.16	23	26	41	53	1/2	0.128
GC- 15-R <sup>1</sup> / <sub>4</sub> -B	15-R <sup>1</sup> / <sub>4</sub> -B	15	6	6.01	23	26	36	48	1/4	0.111
GC- 15-R <sup>3</sup> / <sub>8</sub> -B	15-R <sup>3</sup> / <sub>8</sub> -B	15	8.5	6.35	23	26	37	49	3/8	0.116
GC- 15-R <sup>1</sup> / <sub>2</sub> -B	15-R <sup>1</sup> / <sub>2</sub> -B	15	12	8.16	23	26	41	53	1/2	0.127
GC- 16-R <sup>3</sup> / <sub>8</sub> -B	16-R <sup>3</sup> / <sub>8</sub> -B	16	8.5	6.35	26	29	37	49	3/8	0.140
GC- 16-R <sup>1</sup> / <sub>2</sub> -B	16-R <sup>1</sup> / <sub>2</sub> -B	16	12	8.16	26	29	41	53	1/2	0.150
GC- 18-R <sup>1</sup> / <sub>2</sub> -B	18-R <sup>1</sup> / <sub>2</sub> -B	18	12	8.16	29	32	42	54.5	1/2	0.183
GC- 20-R <sup>1</sup> / <sub>2</sub> -B	20-R <sup>1</sup> / <sub>2</sub> -B	20	12	8.16	29	35	43	55	1/2	0.211
GC- 20-R <sup>3</sup> / <sub>4</sub> -B	20-R <sup>3</sup> / <sub>4</sub> -B	20	17	9.53	29	35	45	57	3/4	0.213
GC- 22-R <sup>1</sup> / <sub>2</sub> -B	22-R <sup>1</sup> / <sub>2</sub> -B	22	12	8.16	32	36	43	55	1/2	0.218
GC- 22-R <sup>3</sup> / <sub>4</sub> -B	22-R <sup>3</sup> / <sub>4</sub> -B	22	17	9.53	32	36	45	57	3/4	0.228
GC- 25-R <sup>3</sup> / <sub>4</sub> -B	25-R <sup>3</sup> / <sub>4</sub> -B	25	17	9.53	35	41	45	58	3/4	0.279
GC- 25-R1-B	25-R1-B	25	20	10.39	35	41	49	62	1	0.325
GC- 28-R1-B	28-R1-B	28	22	10.39	38	41	51	65	1	0.327
GC- 30-R1-B	30-R1-B	30	22	10.39	41	46	51	65	1	0.403
GC- 32-R1 <sup>1</sup> / <sub>4</sub> -B	32-R1 <sup>1</sup> / <sub>4</sub> -B	32	26	12.7	46	50	55	68.5	1 <sup>1</sup> / <sub>4</sub>	0.564
GC- 35-R1 <sup>1</sup> / <sub>4</sub> -B	35-R1 <sup>1</sup> / <sub>4</sub> -B	35	28	12.7	46	55	55	73	1 <sup>1</sup> / <sub>4</sub>	0.622