

# リングジョイント

RP (パネルユニオン) 型

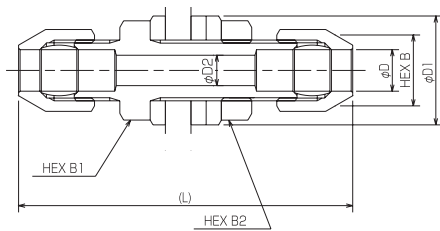

## ●寸法表

UNIT (mm)

呼び径 D	D1	B	B1	B2	L	最小パネル 穴径	品番
6	20	14	17	17	62	11.5	RP-6-R
8	21.5	14	17	17	64	12.5	RP-8-R
10	24.5	17	19	19	75	14.5	RP-10-R
12	31	19	23	23	86	17.5	RP-12-R

RL (エルボーフユニオン) 型

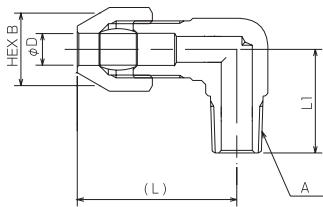
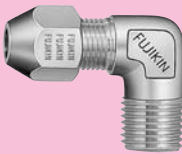

## ●寸法表

UNIT (mm)

呼び径 D	A	B	L	L1	品番
6	R1/8	14	30	20	RL-6A-R
6	R1/4	14	30	22	RL-6B-R
6	R3/8	14	36	29	RL-6C-R
8	R1/8	14	30	20	RL-8A-R
8	R1/4	14	30	22	RL-8B-R
8	R3/8	14	36	29	RL-8C-R
10	R1/8	17	33	20	RL-10A-R
10	R1/4	17	33	22	RL-10B-R
10	R3/8	17	38	29	RL-10C-R
12	R1/4	19	41.5	29	RL-12B-R
12	R3/8	19	41.5	29	RL-12C-R

RL (エルボユニオン) 型

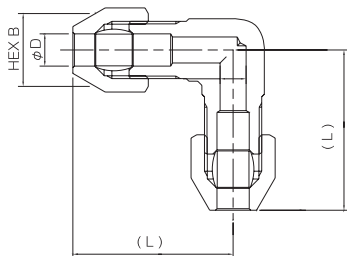
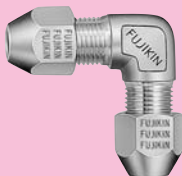

## ●寸法表

UNIT (mm)

呼び径 D	B	L	品番
6	14	30	RL-6-R
8	14	30	RL-8-R
10	17	33	RL-10-R
12	19	41.5	RL-12-R