

## 柄付傘型カッター Parasol Anglemill Cutter With Straight Shank

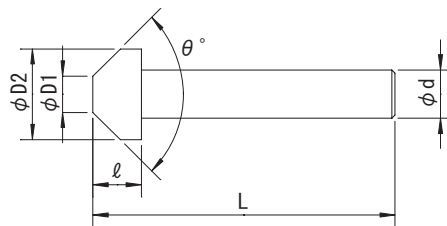

公差 (Tolerance)	D2: $\begin{smallmatrix} +1 \\ 0 \end{smallmatrix}$	$\theta$ : $\begin{smallmatrix} 0 \\ -30' \end{smallmatrix}$	d: h8
----------------	---	--	-------

右刃ストレート  $\phi 60$ までSKH51  $\phi 65$ 以上 SKH56  
 Straight Flute HSS-Co for  $\phi 65$  and over. HSS for other Size.

呼び寸法 (D2 × $\theta$ ) <small>Size (Taper Angle)</small>	小径 ( $\phi D1$ ) <small>First Dia.</small>	首下 ( $l$ ) <small>*</small>	大径 (D2) <small>Dia at Large End</small>	全長 (L) <small>Overall Length</small>	シャンク径 ( $\phi d$ ) <small>Shank Dia.</small>	刃数 (N) <small>Number of Flutes</small>
15x60°	6	11	15	51	8	8
20x60°	8	13.5	20	58.5	10	8
25x60°	10	16	25	61	12	8
30x60°	12	18.5	30	63.5	16	10
35x60°	14	23	35	68	16	10
40x60°	16	26	40	76	25	10
45x60°	18	28	45	78	25	12
50x60°	20	31	50	86	32	12
55x60°	22	36	55	91	32	12
60x60°	24	36	60	91	32	12
65x60°	26	40	65	100	32	14
70x60°	28	42	70	102	32	14
75x60°	30	45	75	105	32	14
80x60°	32	48	80	108	32	14
90x60°	36	53	90	113	32	14
100x60°	40	58	100	118	32	14

※Cut Length Including Neck

呼び寸法 (D2 × $\theta$ ) <small>Size (Taper Angle)</small>	小径 ( $\phi D1$ ) <small>First Dia.</small>	首下 ( $l$ ) <small>*</small>	大径 (D2) <small>Dia at Large End</small>	全長 (L) <small>Overall Length</small>	シャンク径 ( $\phi d$ ) <small>Shank Dia.</small>	刃数 (N) <small>Number of Flutes</small>
15x90°	6	8	15	48	8	8
20x90°	8	9	20	54	10	8
25x90°	10	10.5	25	55.5	12	8
30x90°	12	12	30	57	16	10
35x90°	14	15	35	60	16	10
40x90°	16	17	40	67	25	10
45x90°	18	19	45	69	25	12
50x90°	20	20	50	75	32	12
55x90°	22	23	55	78	32	12
60x90°	24	23	60	78	32	12
65x90°	26	26	65	86	32	14
70x90°	28	27	70	87	32	14
75x90°	30	29	75	89	32	14
80x90°	32	30	80	90	32	14
90x90°	36	33	90	93	32	14
100x90°	40	36	100	96	32	14

※Cut Length Including Neck